

GROUND FLOOR
316 sq.ft. (29.3 sq.m.) approx.

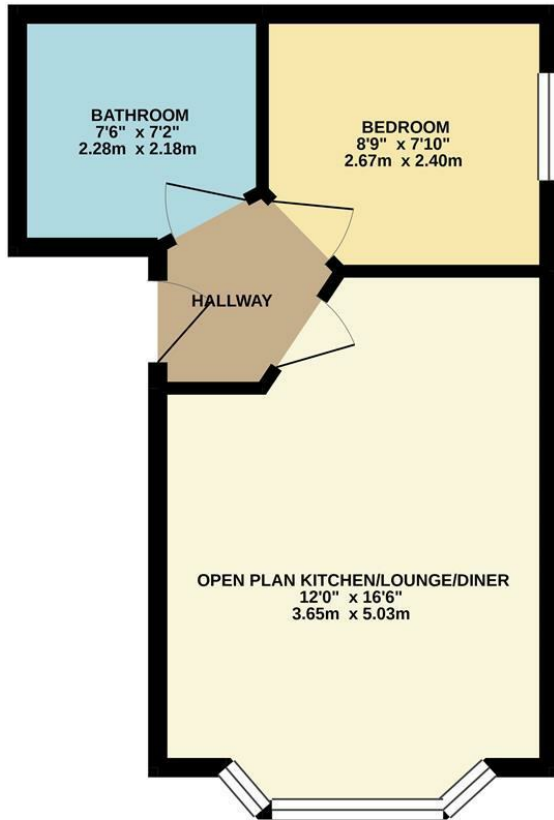

TOTAL FLOOR AREA : 316 sq.ft. (29.3 sq.m.) approx.

Whilst every attempt has been made to ensure the accuracy of the floorplan contained here, measurements of doors, windows, rooms and any other items are approximate and no responsibility is taken for any error, omission or mis-statement. This plan is for illustrative purposes only and should be used as such by any prospective purchaser. The services, systems and appliances shown have not been tested and no guarantee as to their operability or efficiency can be given.
Made with Metropix ©2021

192 Alcester Road, Stratford-Upon-
Offers Over £140,000

charlesrose.



*****SOLD WITH NO ONWARD CHAIN***** This is your chance to own a fantastic modern 1 bedroom apartment, within walking distance to Stratford-Upon-Avon town centre and only 0.8 mile walk to railway station. The property comprises of open plan kitchen/living room, double bedroom and up to date bathroom. The property also benefits from built in washer dryer, fridge and video entrance system. Unlike many apartments there is also gas central heating rather than electric. Outside is an allocated parking space a communal decked area.

This is a great opportunity for first time buyers to get onto the property ladder within walking distance of Stratford Upon Avon. Likewise it is also an excellent investment opportunity, therefore interest is expected to be high. Call us today to arrange your own viewing.

Council Tax Band - A - £1,439 per year

Service Charge: £1908, paid in two 6 monthly instalments of £954

Ground rent: £250 per year

Lease length 113 years approx

charlesrose.

- 01926 832411
- info@charlesroseproperties.co.uk
- www.charlesroseproperties.co.uk

