

19 Redcar Close, Leamington Spa
Offers Over £500,000

charlesrose.

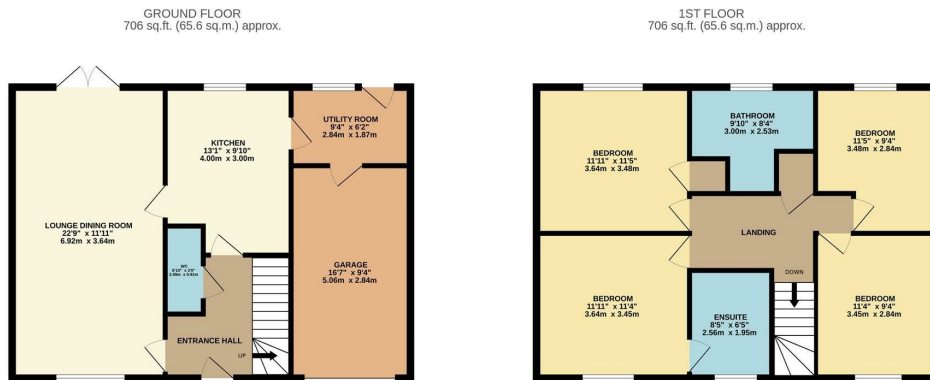

TOTAL FLOOR AREA: 1412 sq.ft. (131.2 sq.m.) approx.
Whilst every attempt has been made to ensure the accuracy of the floorplan contained here, measurements of floors, windows, rooms and any other items are approximate and no responsibility is taken for any error, omission or mis-statement. This plan is for illustrative purposes only and should be used as such by any prospective purchaser. The services, systems and appliances shown have not been tested and no guarantee as to their operability or efficiency can be given.
Made with Metropix ©2024



*** Sold with no onward chain *** This detached family home is immaculately presented throughout. The accommodation comprises entrance hall, downstairs W.C., lounge dining room, kitchen, utility room, ensuite, four bedrooms and a bathroom. The property further benefits from a drive, garage and an enclosed rear garden.

charlesrose.

- 01926 832411
- info@charlesroseproperties.co.uk
- www.charlesroseproperties.co.uk

