



PLOT 5 KNIGHTWOOD CHASE / CALA HOMES

FORDINGBRIDGE, SP6 1JW

£520,000
FREEHOLD

A rare opportunity to secure a corner plot with garage and parking, this beautifully designed three-bedroom home at Knightwood Chase features a ground floor principal suite with garden access, two further doubles, and a stylish kitchen/diner. Perfect for buyers seeking space, style, and convenience on the edge of the New Forest.



HIVE

Approx Gross Internal Area
96 sq m / 1035 sq ft



Ground Floor
Approx 52 sq m / 560 sq ft

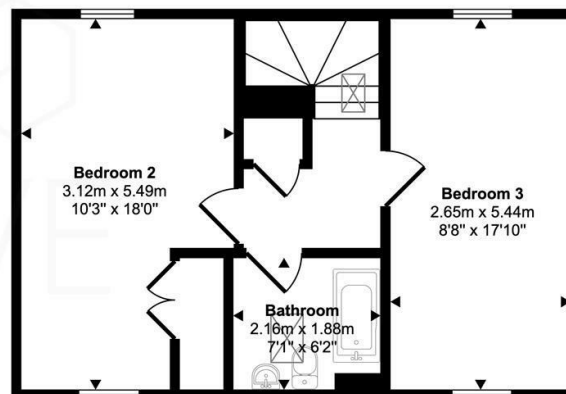

First Floor
Approx 44 sq m / 475 sq ft

This floorplan is only for illustrative purposes and is not to scale. Measurements of rooms, doors, windows, and any items are approximate and no responsibility is taken for any error, omission or mis-statement. Icons of items such as bathroom suites are representations only and may not look like the real items. Made with Made Snappy 360.

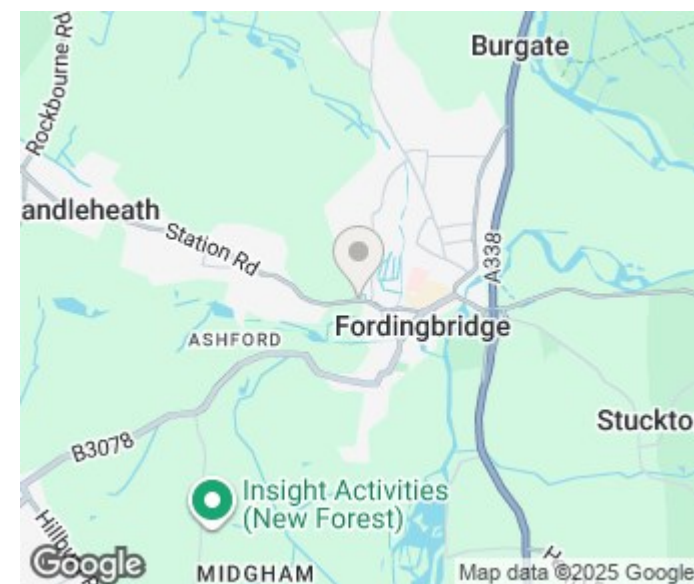

Energy Efficiency Rating		
	Current	Potential
Very energy efficient - lower running costs		
(92 plus) A		
(81-91) B		
(69-80) C		
(55-68) D		
(39-54) E		
(21-38) F		
(1-20) G		
Not energy efficient - higher running costs		
England & Wales	EU Directive 2002/91/EC	

Agents Note: Whilst every care has been taken to prepare these particulars, they are for guidance purposes only. All measurements are approximate and are for general guidance purposes only and whilst every care has been taken to ensure their accuracy, they should not be relied upon and potential buyers/tenants are advised to recheck the measurements

Hive & Partners
Unit F1
Arena Business Centre 9
Nimrod Way
Ferndown
BH21 7UH

01202 122 002
sales@hiveandpartners.co.uk
<https://www.hiveandpartners.co.uk/>



HIVE