



HIVE

MANOR ORCHARD
5 MANOR CLOSE
STRATTON
DORCHESTER
DT2 9RY



presented by
JAMES FARRAN
01305 571 757



Agent's introduction

This beautiful family home is a rare find in Dorset, the Sussex tile hung design is unusual, yet sympathetic to its setting. The house is surrounded by established grounds including a large kitchen garden, an orchard and a sizeable chicken run. There's a small winterbourne stream at the very bottom of the garden, providing a tranquil backdrop to this truly individual home.

Seller's introduction

This home has been wonderful for our family. We will miss the house and the village lifestyle. The Saxon Arms pub is nearby and well worth a visit. There are also some incredible walks across the Frome Valley too.







Property highlights

Private grounds measuring approximately 0.8 acres

Uninterrupted views towards the Frome Valley

Kitchen garden and fruit orchard

Triple aspect sitting room

Spacious conservatory/sun room

One bedroom self-contained annexe

Double garage and adjacent workshop

Ample off road parking









4 bedrooms

3 bathrooms

Kitchen/diner

Separate dining room and sitting room

Conservatory

Garage and workshop

Self contained one bedroom annexe

Accommodation overview







JAMES FARRAN

HIVE Partner for Dorchester/Weymouth

This impressive detached home enjoys a private, south-facing setting with lovely views. The property is situated within the picturesque village of Stratton, just three miles northwest of Dorchester. The surrounding West Dorset hills provide miles of scenic country walks.



Scan the QR code for my latest property listings and social channels.

Manor Orchard Stratton, Dorchester, DT2 9RY

Approximate Area = 2379 sq ft / 221 sq m
Limited Use Area(s) = 77 sq ft / 7 sq m
Garage & Workshop = 517 sq ft / 48 sq m
Total = 2973 sq ft / 276 sq m

For identification only - Not to scale
Not to be relied upon

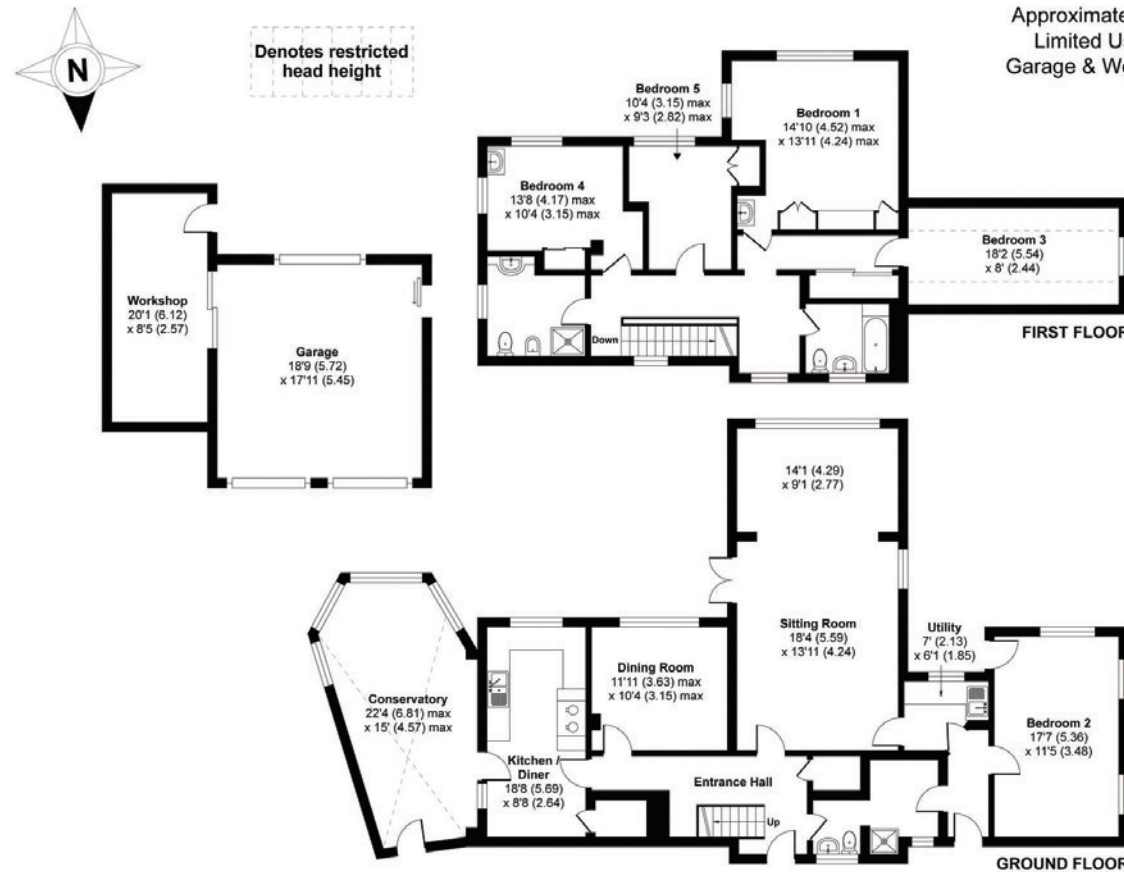

NOTE: Measurements were not taken by HIVE and we cannot guarantee accuracy.





HIVE & Partners, Dorchester & Weymouth c/o The Hive, Wilson House, 2 Lorne Park Road, Bournemouth BH1 1JN
01305 571 757 | www.hiveandpartners.co.uk