



HIVE

5 DRUIDS CLOSE
WEST PARLEY
FERNDOWN
BH22 8RU



presented by
PAUL DEHON
HIVE Partner for Ferndown
01202 122 252



Agent's introduction

This beautifully presented and skilfully extended four double bedroom, two bathroom detached bungalow, is set in an exclusive cul-de-sac location on the border of West Parley and Ferndown. The property features a stunning 30ft open plan kitchen/diner, secluded landscaped south facing garden, and attached double garage.







Property highlights

Large kitchen/diner with separate utility room

Four double bedrooms, with en-suite and dressing room to principal bedroom

Private landscaped south facing garden with koi pond

Garden chalet with hot tub

Ample off road parking and attached double garage

Bi-folding doors to conservatory









4 double bedrooms (with dressing room to principal bedroom)

1 en-suite bathroom, 1 family shower room

Open plan kitchen/dining room with separate utility room

Large living room and conservatory

Garden chalet with hot tub and detached garage

Accommodation overview







PAUL DEHON

HIVE Partner for Ferndown/Wimborne

This lovely bungalow is located a mile from Ferndown's championship golf course and 1.5 miles from the town centre. The property has many great features, such as a double fronted wood burner and bi-fold doors in the living room, high specification kitchen with island unit and the wonderful landscaped garden with feature koi pond and chalet with hot tub.



Scan the QR code for my latest property listings and social channels.

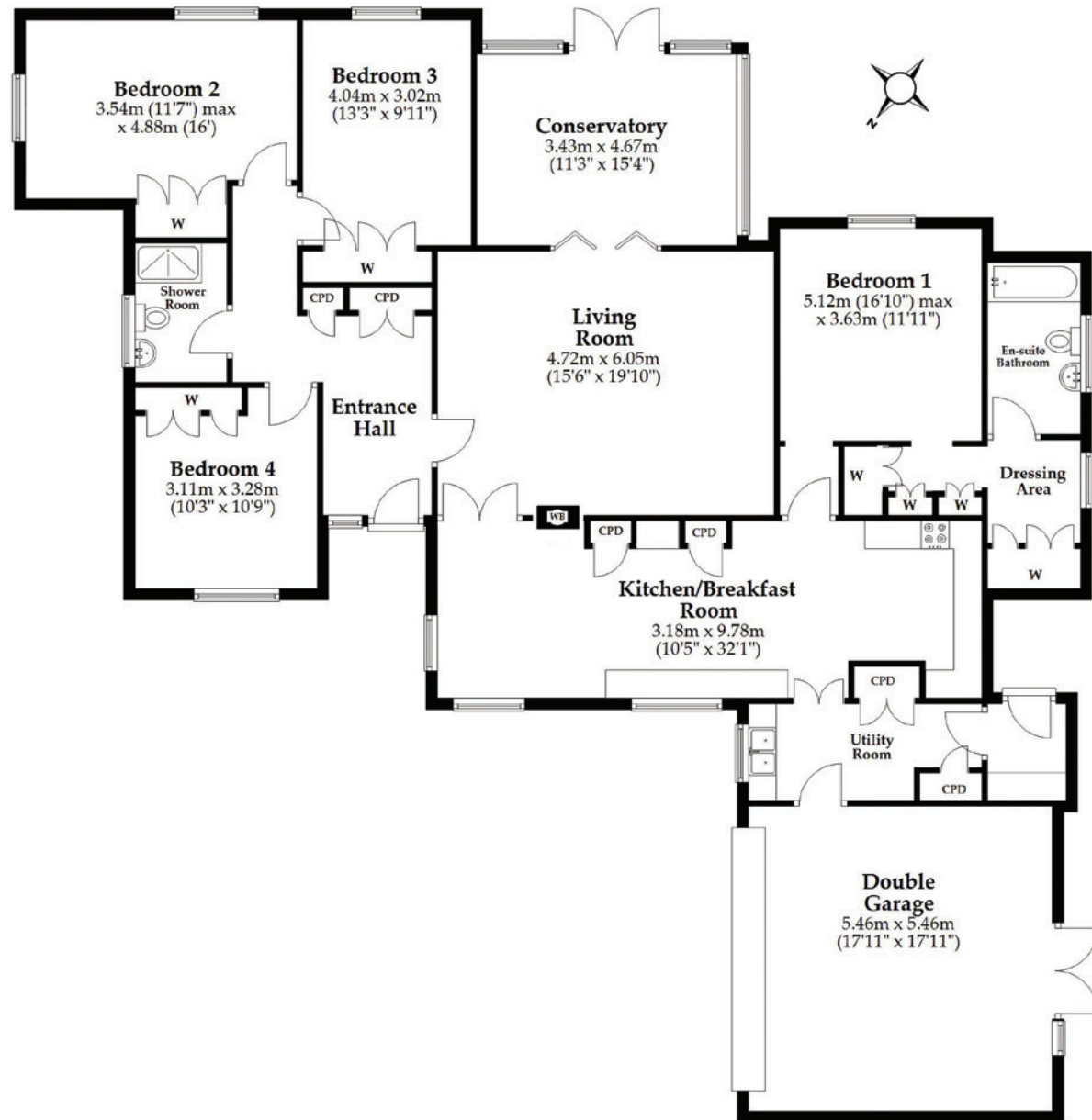

Total area: approx. 208.6 sq. metres (2245.8 sq. feet)

This plan is not to scale and it is for general guidance only. LJT Surveying Ltd Ringwood





HIVE & Partners, Ferndown, West Parley & Wimborne c/o The Hive, Wilson House, 2 Lorne Park Road, Bournemouth BH1 1JN
01202 122 252 | www.hiveandpartners.co.uk