



HIVE

FLAT 27, PRINCES COURT
28-30 SEA ROAD
BOSCOMBE
BH5 1DF



presented by
JAMES EVANS
HIVE Partner for Bournemouth
01202 122 002



Agent's introduction

A well presented apartment located just a short walk from the beachfront. Currently run as a successful holiday let, the property generates a fantastic income with potential to increase this further. The apartment benefits from a long lease and no onward chain.







Property highlights

Open plan kitchen/living space with contemporary fitted kitchen

Double bedroom

Modern shower room

Currently run as a successful holiday let

A short walk from the beachfront

New roof installed in 2023





JAMES EVANS
HIVE Partner for Bournemouth

A fantastic investment opportunity located just 0.3 miles from the beach, and a short walk from the local shops and amenities in Boscombe. Within a few minutes you can be on award winning sandy beaches with access to a level promenade stretching from Sandbanks to Hengistbury Head. Bournemouth Town Centre is also just 1.5 miles away with its range of shops, restaurants, cafés, cinema and theatre.



Scan the QR code for my latest property listings and social channels.

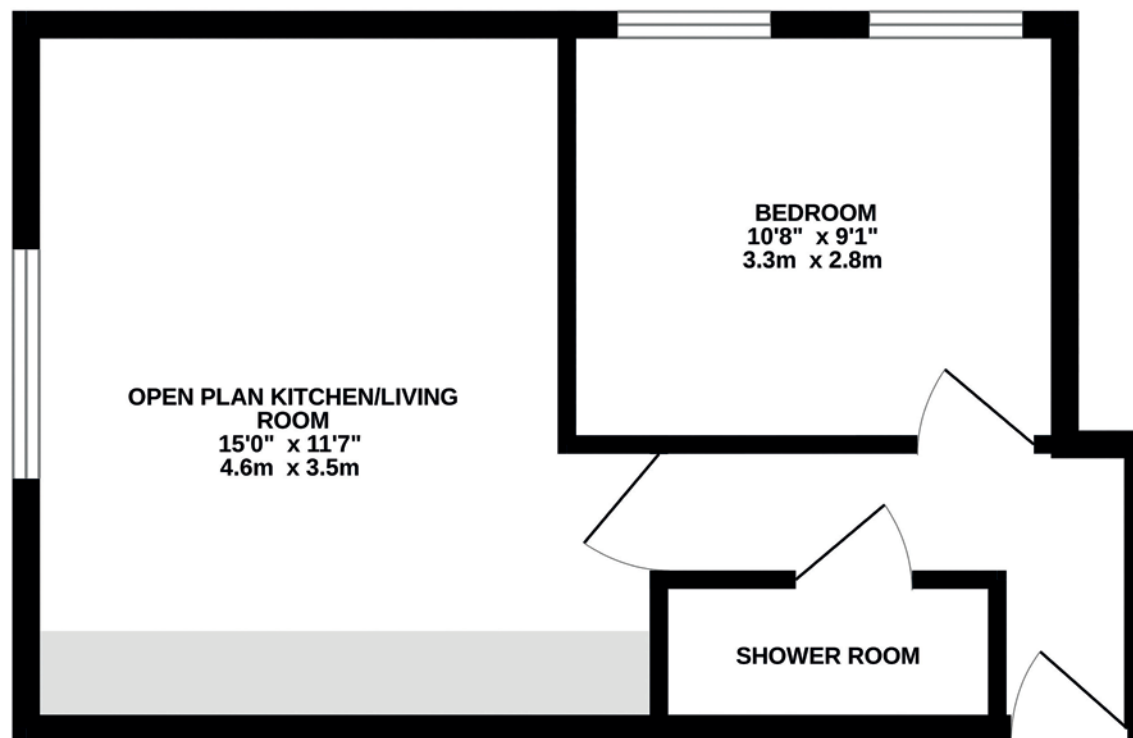

Total area: Approx 312 sq ft (29.0 sq m)





HIVE & Partners, The Hive, Wilson House, 2 Lorne Park Road, Bournemouth BH1 1JN
01202 122 002 | www.hiveandpartners.co.uk