



HIVE

33 STOUR VIEW GARDENS
CORFE MULLEN
BH21 3SZ



presented by
MATTHEW WILSON
HIVE Partner for Poole/Broadstone
01202 122 002



Agent's introduction

This lovely three bedroom detached home is situated in a quiet cul-de-sac and backs onto Corfe Mullen Recreation Ground. It's well presented throughout and has ample off road parking, a garage, carport, and a southerly facing garden.

Seller's introduction

I've really enjoyed living here, it's a very quiet spot and having direct access to the recreation ground has been a bonus. I've got great neighbours and can get to the schools easily.







Property highlights

Contemporary kitchen/breakfast room

Garage and car port

Sunny garden

Favoured schools nearby

Direct gated access to Corfe Mullen
Recreation Ground

Downstairs cloakroom

Approx 2 miles from both Broadstone
and Wimborne Minster and 5.7 miles
from Poole Town Centre









3 double bedrooms

1 family bathroom and a downstairs cloakroom

Large living/dining room

Contemporary kitchen/breakfast room

Accommodation overview







MATTHEW WILSON
HIVE Partner for Poole/Broadstone

Located in a sought after road in this popular village, this well presented three bedroom property makes a great family home. The property has plenty of living space, ample parking and 'the rec' on your doorstep. Corfe Mullen is situated less than six miles from Poole with its cafés, restaurants, bars, shops and theatre.



Scan the QR code for my latest property listings and social channels.

Ground Floor

Approx. 51.1 sq. metres (550.0 sq. feet)

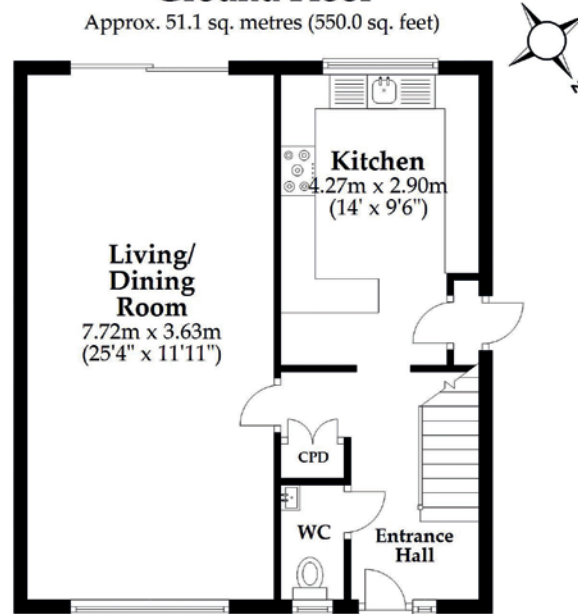

First Floor

Approx. 51.6 sq. metres (555.6 sq. feet)

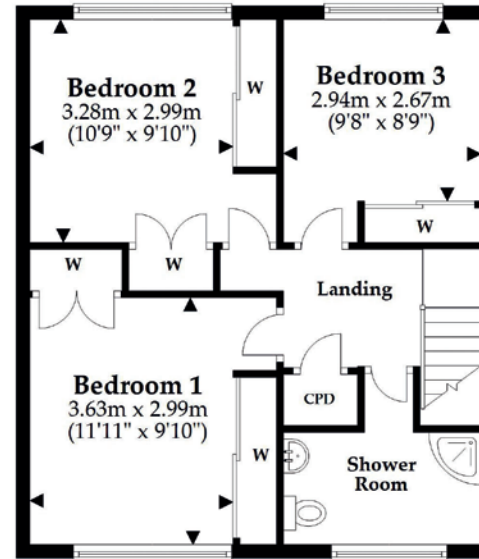

Garage

Approx. 13.8 sq. metres (148.4 sq. feet)

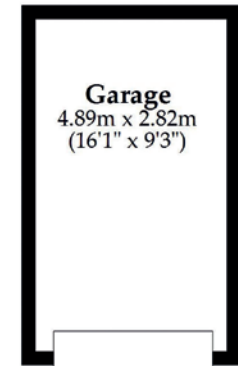

Total area: approx. 116.5 sq. metres (1254.1 sq. feet)

This plan is not to scale and it is for general guidance only. LJT Surveying Ltd Ringwood





HIVE & Partners, Poole, Broadstone & Corfe Mullen c/o The Hive, Wilson House, 2 Lorne Park Road, Bournemouth BH1 1JN
01202 122 002 | www.hiveandpartners.co.uk