

ESTATE AGENTS  
**LAWSON  
ROSE**



ESTATE AGENTS  
**LAWSON  
ROSE** **TO LET**

58 Liss Road, Southsea, PO4 8AS

£1,600 Per Month





## THE PROPERTY

This beautiful mid-terrace home has been completely renovated from top to bottom and benefits from being available for immediate occupation, with long term renting plans, this property would ideally suit a family. The fresh interior comprises of:- Entrance hallway, lounge with bay window, a with access to storage and a d/s w/c, with a large kitchen diner to the rear. Upstairs the property holds three sizeable double bedrooms and a family bathroom. Outside the property is forecourt enclosed with a laid to patio South facing rear garden. Viewings can be made by calling Lawson Rose on 02392 367 779.

EPC: C

Material Information:

- Construction: Brick Built
- Electricity Supply: Alternating Current
- Heating: Gas Central Heating
- Water Supply: Mains Water Supply
- Sewage: Mains Sewage
- Broadband: Standard, Superfast Fibre and Gfast Fibre are available.
- Mobile: Ofcom Checker shows EE, Three, 02 and Vodafone all have voice and data availability in this area.
- Permit Parking: 1st permit is £30, 2nd permit is £120 and 3rd permit (where available) is £300.
- Council Tax: Portsmouth City Council – Band B
- Flood Risk – Low Risk / Surface Water – Medium Risk (Stated on the Gov.uk portal)

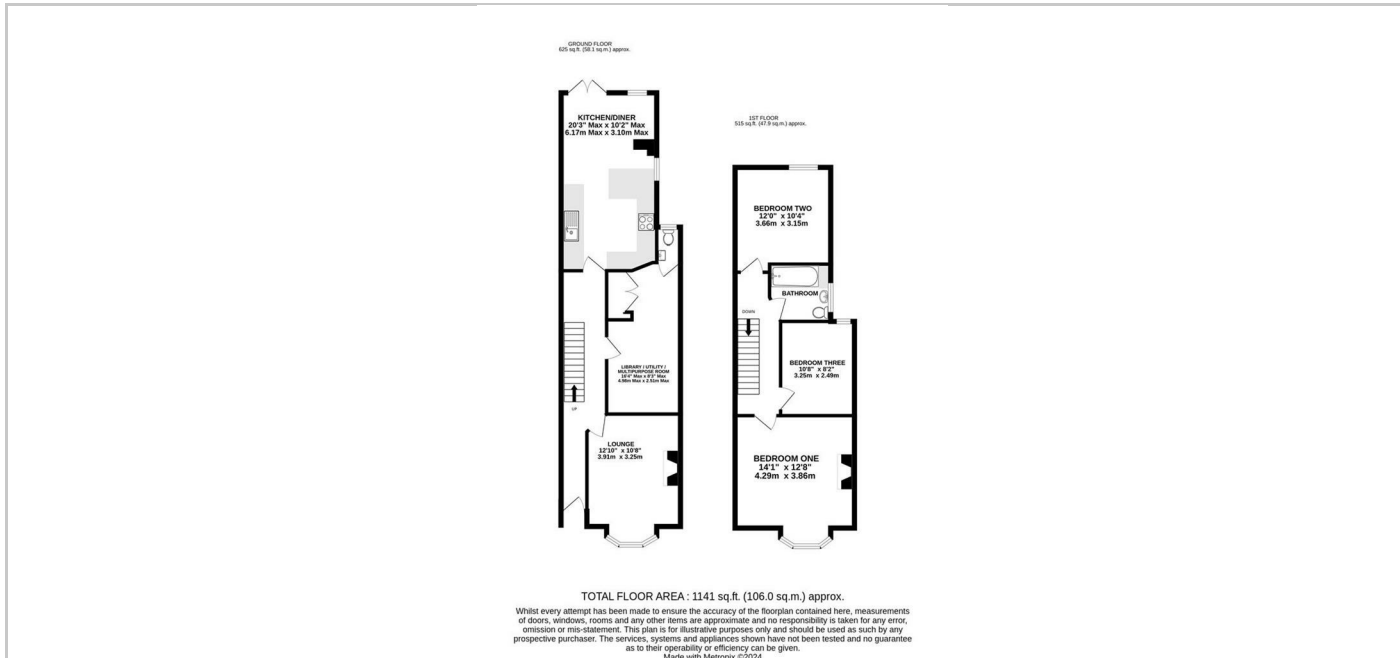

## SITUATION

### Directions

131 Winter road, Southsea, Hampshire, PO4 8DS  
Tel: 02392 367 779 Email: [lettings@lawsonrose.com](mailto:lettings@lawsonrose.com) [www.lawsonrose.com](http://www.lawsonrose.com)