



2 Floors



3 Bedrooms



Utility

GROVIER THREE BEDROOM HOME

A three bedroom semi-detached home with a perfectly proportioned lounge and a stunning open plan kitchen / dining room with a separate utility room, cloakroom and French doors opening onto the rear garden. Upstairs the spacious master suite is complete with an en suite shower room.

GROVIER THREE BEDROOM HOME

⬢ DIMENSIONS

First Floor:

Bedroom 1

2.58m x 2.71m
8'6" x 8'11"

Bedroom 2

2.58m x 2.43m
8'6" x 8'0"

Bedroom 3

1.95m x 2.30m
6'5" x 7'7"

Bathroom

Ground Floor:

Lounge

3.60m x 4.22m
11'10" x 13'10"

Kitchen / Dining

3.48m x 3.19m
11'5" x 10'5"

Utility

1.05m x 1.70m
3'5" x 5'7"

(S) Storage

(C) Cloaks

◀▶ Measurement Points

△ External Access



First Floor

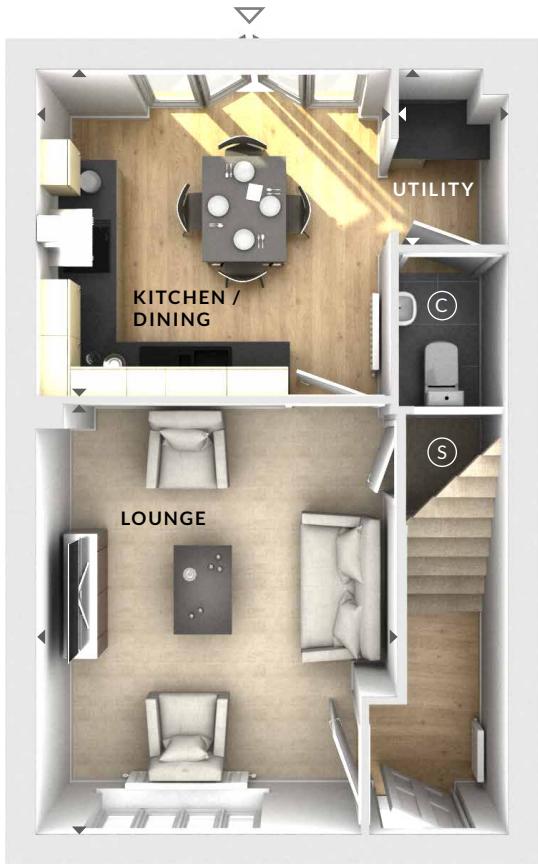

Ground Floor