

MORGAN H LEWIS



Asking Price £230,000

Gidlow Lane, Wigan WN6 7PL

- *Extended character semi-detached house
- *Sought-after location in the heart of Springfield
- *Private westerly facing gardens
- *Wide plot with ample parking on York stone driveway
- *Attractive lounge & dining room each with limestone fireplaces
- *Delightful orangery overlooking gardens
- *Extended kitchen, utility room and cloakroom

MORGAN H LEWIS



MORGAN H LEWIS

Nestled in the heart of Springfield, this attractive semi-detached home blends character and practicality in equal measure. Set within walking distance of local shops, schools, Mesnes Park, and Wigan town centre, the location alone offers much to admire.

The house has been thoughtfully extended to provide well-balanced accommodation. On the ground floor, a welcoming reception hall leads to a front lounge featuring a classic bay window and a limestone fireplace—a subtle nod to the home’s original charm. Glazed hardwood doors open into a dining room, also with a limestone hearth, which flows naturally into a light-filled orangery. With French doors to the rear garden, this space blurs the boundary between inside and out. Double doors connect to the extended kitchen, fitted with both wall and base units and centred around a Rangemaster cooker—practical yet refined. A side extension brings additional function, housing a utility room and a cloakroom with W.C.

Upstairs, there are three comfortable bedrooms, a family bathroom, and a separate W.C. Outside, the property sits on a generous plot. A York stone driveway accommodates several vehicles, a much sought after rarity in this location, while the mature rear garden—private and west-facing—offers a lovely, sun-filled retreat. It’s rare to find a home of this quality in such a desirable location. Early viewing is highly recommended.

MORGAN H LEWIS



MORGAN H LEWIS



MORGAN H LEWIS

Gidlow Lane, Springfield, Wigan

Total Approx. Floor Area 1269 Sq.ft. (117.9 Sq.M.)

Surveyed and drawn by Lens Media for illustrative purposes only. Not to scale. Whilst every attempt was made to ensure the accuracy of the floor plan, all measurements are approximate and no responsibility is taken for any error.

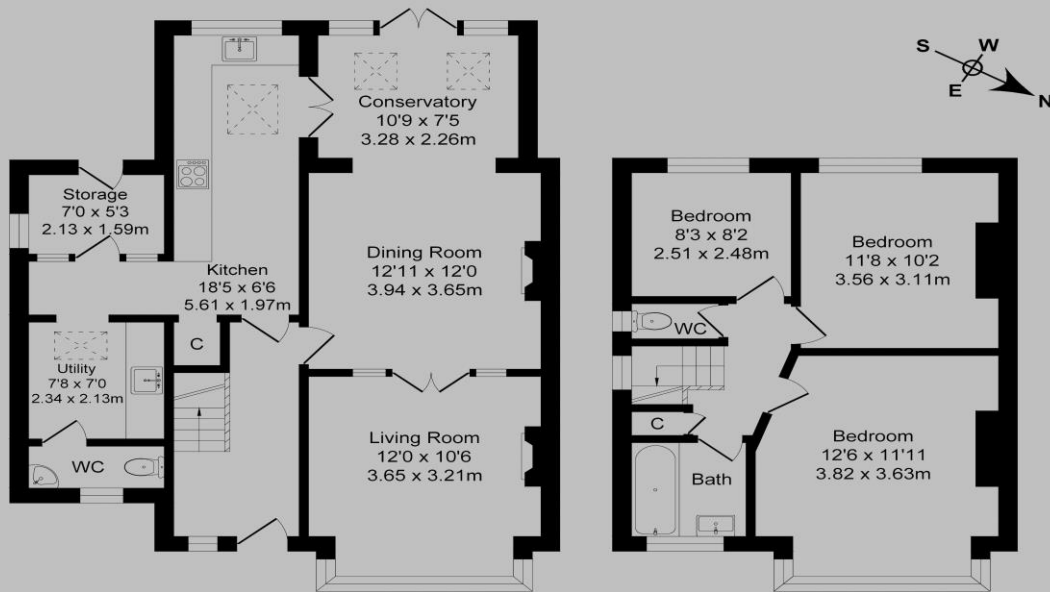

Ground Floor

Approx. Floor
Area 792 Sq.Ft
(73.6 Sq.M.)

First Floor

Approx. Floor
Area 477 Sq.Ft
(44.3 Sq.M.)