

MORGAN H LEWIS



Asking Price £139,950

Chelmsford Mews, Wigan WN1 2PZ

- *Two Bedroom Apartment
- *Perfectly Located in the Heart of Swinley
- *Juliette Balcony
- *Single Garage & Parking
- *Quiet Well Maintained Development

MORGAN H LEWIS



MORGAN H LEWIS

Now available for sale, this spacious two bed top floor apartment must be viewed to be appreciated, offering an impressive floor plan which is larger than your average apartment, extending to in excess of 685 square feet, as well as an on-site garage, which is a welcome rarity. Located in the heart of Swinley, just off Mesnes Road, close to local amenities, eateries, nature walks and handy bus and rail links, the development is both accessible but tucked away from the hustle and bustle.

The secure development is approached via electronically operated gates and nestled amongst mature woodland and beautifully landscaped communal gardens, making for a most delightful setting, entering via the communal entrance hallway with security entry system and lift.

As you enter the property you will find the spacious hallway leading to all rooms. As you proceed down the hallway you will find the sizeable 16' lounge, which is bathed in natural light via the sliding doors which provide access to the balcony, which will be most welcome in the warm summer months. The kitchen is also pleasingly spacious and fitted with a comprehensive range of wall and base units with contrasting work surfaces. The bedrooms are spacious, with fitted wardrobes and the bathroom has been converted to a stylish wet room, to make for more accessible use.

Other highlights include loft area, gas central heating, ample parking facilities, in addition to the garage, which provides secure parking and/or storage facilities. An internal inspection is highly recommended.

MORGAN H LEWIS



MORGAN H LEWIS



MORGAN H LEWIS

GROUND FLOOR
679 sq.ft. (63.1 sq.m.) approx.

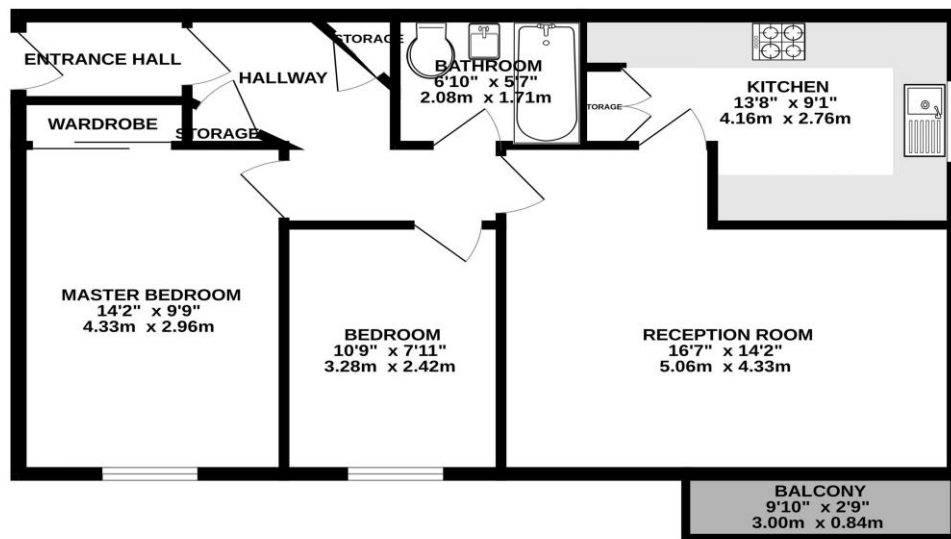

TOTAL FLOOR AREA: 679 sq.ft. (63.1 sq.m.) approx.
Whilst every attempt has been made to ensure the accuracy of the floorplan contained herein, measurements of doors, windows, rooms and any other items are approximate and no responsibility is taken for any error, omission or mis-statement. This plan is for illustrative purposes only and should be used as such by any prospective purchaser. The services, systems and appliances shown have not been tested and no guarantee as to their operability or efficiency can be given.
Made with Metropix ©2025

