

MORGAN H LEWIS



Asking Price £299,950

Fairman Drive, Wigan WN2 2RT

- *Well Presented Link Detached House
- *Two Reception Rooms
- *Three Bedrooms and En-Suite Shower Room
- *Generous Rear Garden
- *Single Integral Garage

MORGAN H LEWIS



MORGAN H LEWIS

Available now this impressive three bedroomed link detached house is situated in a quiet cul de sac within walking distance of Hindley railway station and within easy driving distance of Wigan, Westhoughton and the M61 Motorway.

The property is centrally heated and double glazed and offers surprisingly spacious living accommodation which briefly comprises; reception hall, downstairs wc, fitted kitchen, L shaped lounge with spiral staircase leading down to sitting room and garden storage room.

To the first floor there are three bedrooms, an en-suite shower room and family bathroom. To the outside there is a front lawn, driveway and single car garage whilst to the rear there are particularly large, lawned gardens which are not overlooked.

Properties of this quality rarely become available to purchase, we would, therefore, recommend early viewings to avoid disappointment.

MORGAN H LEWIS



MORGAN H LEWIS



MORGAN H LEWIS

21 Fairman Drive, Hindley

Total Approx. Floor Area 1230 Sq.ft. (114.3 Sq.M.)

Surveyed and drawn by Lens Media for illustrative purposes only. Not to scale. Whilst every attempt was made to ensure the accuracy of the floor plan, all measurements are approximate and no responsibility is taken for any error.

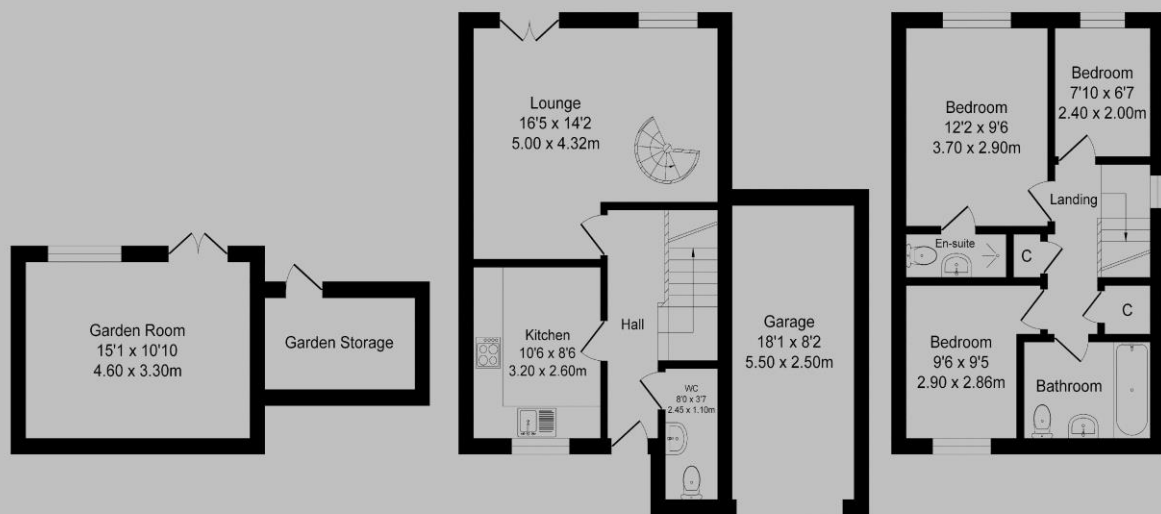

Lower Ground Floor

Approx. Floor Area 225 Sq.Ft (20.9 Sq.M.)

Ground Floor

Approx. Floor Area 591 Sq.Ft (54.9 Sq.M.)

First Floor

Approx. Floor Area 412 Sq.Ft (38.3 Sq.M.)