

MORGAN H LEWIS



Asking Price £125,000

Morton Avenue, Wigan WN3 5EL

- *NO ONWARD CHAIN
- *Generous Corner Plot
- *Recently Redecorated
- *Two Large Bedrooms
- *Off Road Parking

MORGAN H LEWIS



MORGAN H LEWIS

Situated along a quiet street and resting on a generous corner plot, this lovely two bedroom home is now available with NO ONWARD CHAIN.

The accommodation is well presented, having recently been redecorated and provides the new owner a blank canvas to style just to their liking. The living space briefly comprises of a generous lounge with bay window, fireplace and stairs leading to the first floor and opens up into the kitchen diner, which is well appointed with a range of wall and base units, with natural wood doors and contrasting worktop. The ground floor has laminate flooring throughout, seamlessly linking the two rooms. To the first floor are two generous bedrooms and a good sized bathroom, with shower-over bath, w.c. and basin. The property is centrally heated via combi-boiler.

Externally, this property is situated on a generous corner plot, offering plenty of space for parking and outdoor entertaining, perhaps even scope to extend. The rear of the property is accessed via the secure double wooden gates and is private and sunny.

MORGAN H LEWIS



MORGAN H LEWIS



MORGAN H LEWIS

GROUND FLOOR
295 sq.ft. (27.4 sq.m.) approx.

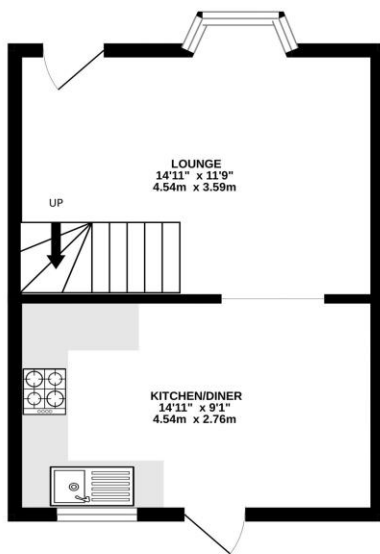

1ST FLOOR
290 sq.ft. (27.0 sq.m.) approx.

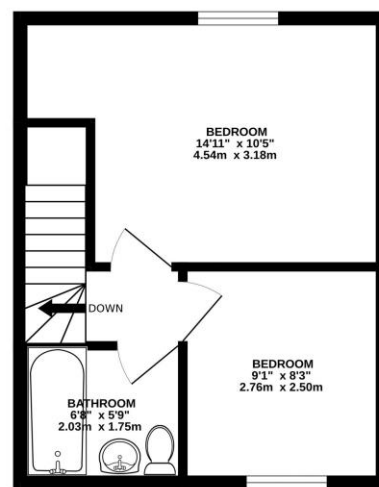

TOTAL FLOOR AREA : 585 sq.ft. (54.4 sq.m.) approx.

Whilst every attempt has been made to ensure the accuracy of the floorplan contained here, measurements of doors, windows, rooms and any other items are approximate and no responsibility is taken for any error, omission or mis-statement. This plan is for illustrative purposes only and should be used as such by any prospective purchaser. The services, systems and appliances shown have not been tested and no guarantee as to their operability or efficiency can be given.

Made with Metropix ©2024