

# MORGAN H LEWIS



Asking Price £99,995

**Spring Grove, Wigan WNI 3AZ**

- \*Attractive double fronted end terraced house
- \*Quiet cul-de-sac location
- \*Convenient for Town Centre and Stations
- \*Perfect rental investment or first time buy
- \*Large front lounge

# MORGAN H LEWIS



# MORGAN H LEWIS

A fantastic opportunity for the first time buyer or rental investor, to purchase this impressive double fronted end terraced house. Spring Grove is a short cul-de-sac close to Darlington Street East convenient for the Town Centre and Stations for easy commuting to Liverpool and Manchester.

The property is centrally heated and double glazed and the accommodation briefly comprises, to the ground floor, double fronted lounge, fitted kitchen. To the first floor there are two generous bedrooms and a large bathroom. To the outside there is a large, low maintenance front garden and a rear yard with brick shed.

The property is well presented and available with no onward chain. Viewings are essential to appreciate both the location and the quality and character of the accommodation.

# MORGAN H LEWIS



# MORGAN H LEWIS

GROUND FLOOR

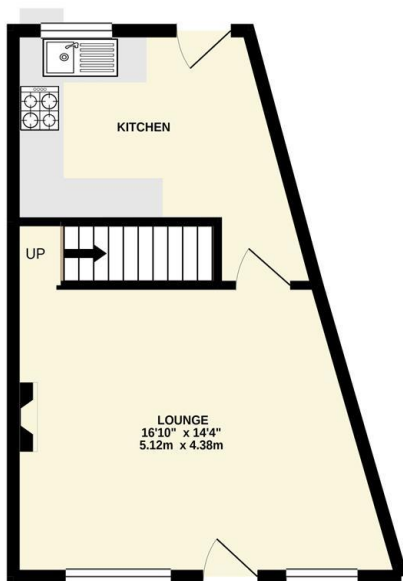

1ST FLOOR

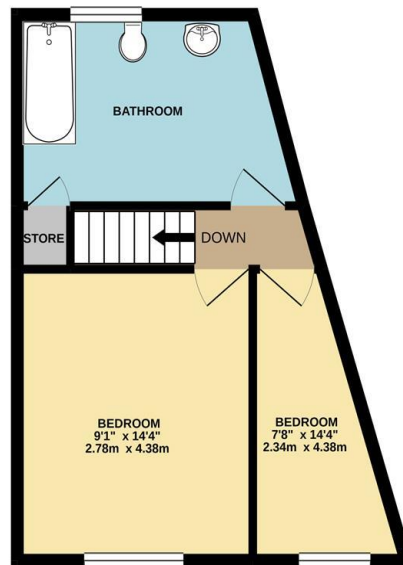

Whilst every attempt has been made to ensure the accuracy of the floorplan contained here, measurements of doors, windows, rooms and any other items are approximate and no responsibility is taken for any error, omission or mis-statement. This plan is for illustrative purposes only and should be used as such by any prospective purchaser. The services, systems and appliances shown have not been tested and no guarantee as to their operability or efficiency can be given.  
Made with Metreplex ©2021