

# Settle.



Orford Road

, London, E17 9NS

Offers in excess of £325,000





Floor Plan

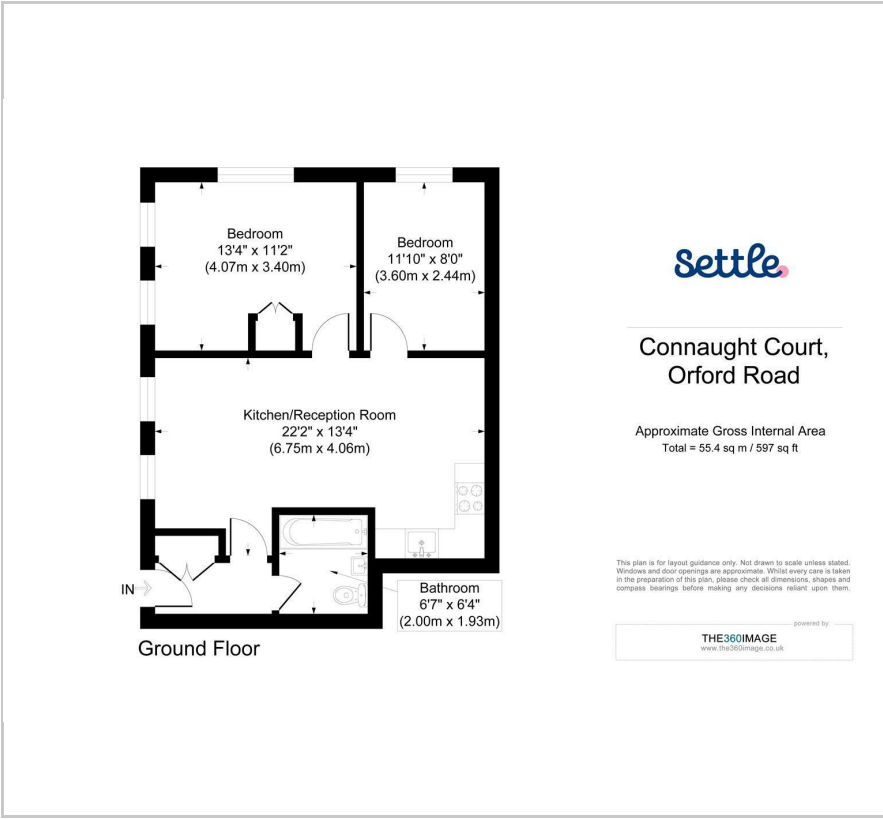

Area Map



Energy Efficiency Graph

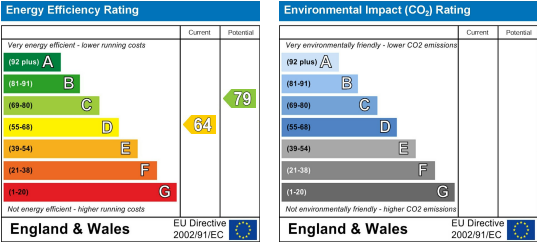

Viewing

Please contact our Settle Office on 0208 124 2522 if you wish to arrange a viewing appointment for this property or require further information.

- Two Bedroom Ground Floor
- Beautiful Historic Building
- New Lease Upon Completion
- Two Parkin Spaces
- Excellent Potential
- Walthamstow Village Location Flat
- No Onward Chain
- 0.5m To Walthamstow Central
- Communal Courtyard
- 597 Sq Ft (55.4 SQ M)

Set within the striking Connaught Court development on Orford Road In Walthamstow Village is this spacious two-bedroom flat. Once home to the Walthamstow Town Hall, the development retains much of its historic character while providing modern living in the heart of the Village.

The property is offered chain free and, while it would benefit from modernisation and improvements throughout, it provides a great canvas for buyers to put their own stamp on. Inside, there's an open-plan lounge and kitchen, two bedrooms, and a family bathroom.

Residents can also enjoy a beautifully maintained communal central courtyard, creating a peaceful setting despite being just moments from Orford Road's cafés, restaurants, and independent shops. Unusually for the Village, the flat also comes with two parking spaces, a real bonus in such a sought-after location.



These particulars, whilst believed to be accurate are set out as a general outline only for guidance and do not constitute any part of an offer or contract. Intending purchasers should not rely on them as statements of representation of fact, but must satisfy themselves by inspection or otherwise as to their accuracy. No person in this firms employment has the authority to make or give any representation or warranty in respect of the property.