

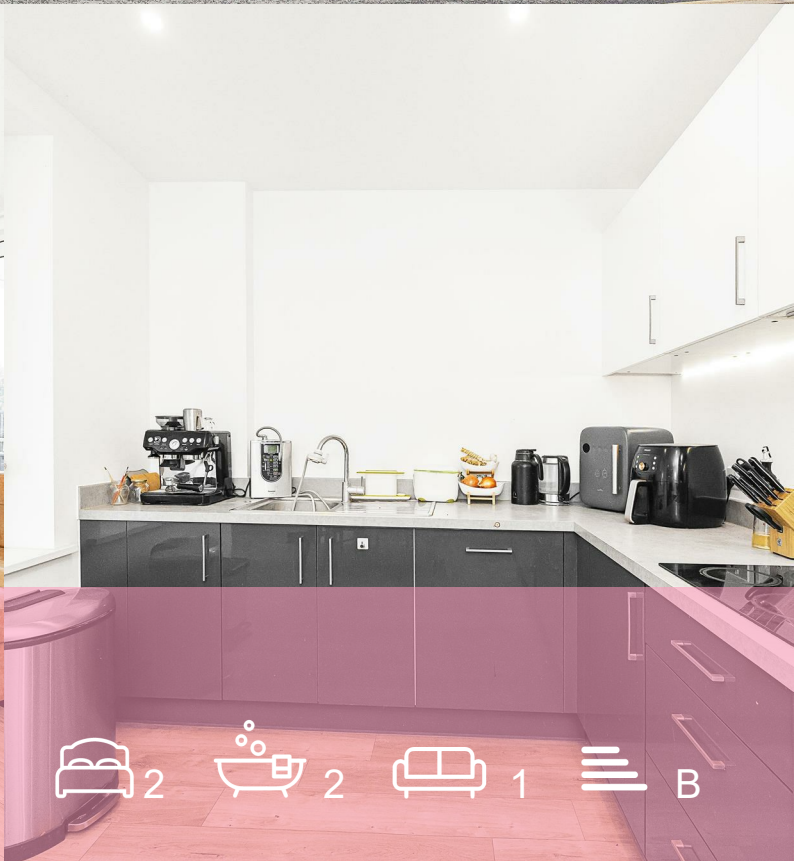

Beck Square

, London, E10 7FU

Offers in excess of £475,000





Floor Plan

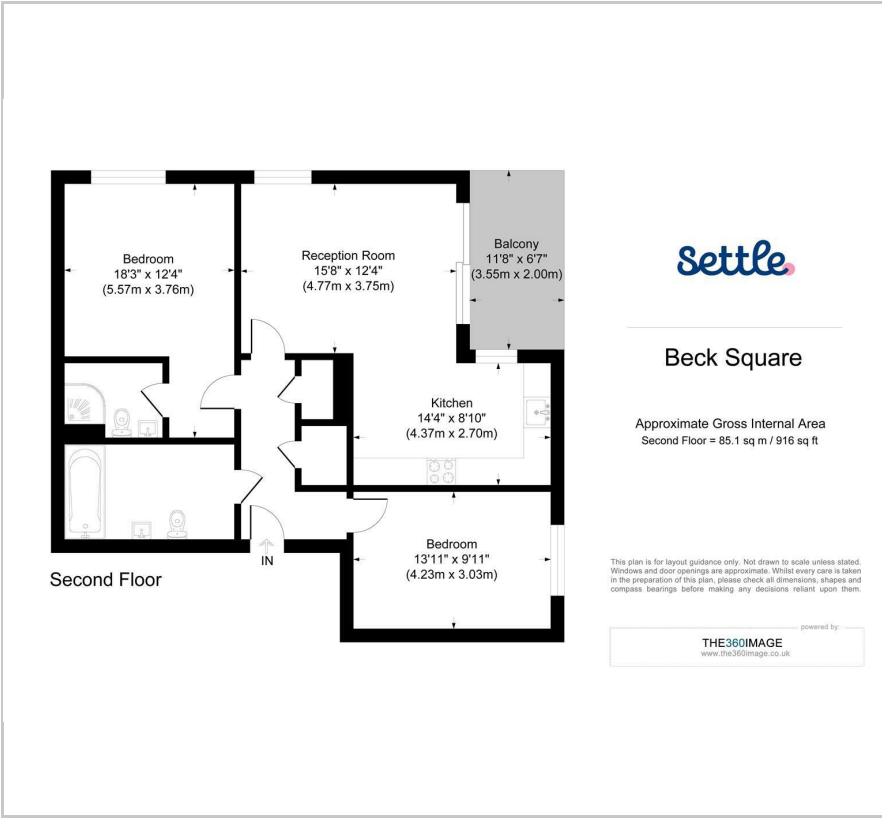

Area Map



Energy Efficiency Graph

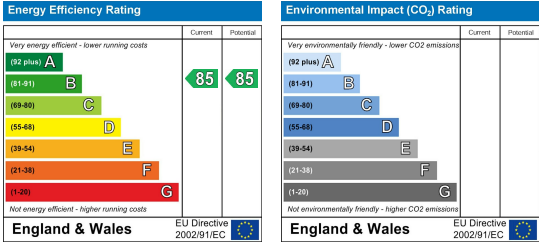

Viewing

Please contact our Settle Office on 0208 124 2522 if you wish to arrange a viewing appointment for this property or require further information.

- Modern Development
  - Private Balcony
  - En Suite To Main Bedroom
  - 0.2m To Lea Bridge Road Station
  - Borders Of Walthamstow And Leyton
- Second Floor
  - Two Double Bedrooms
  - Open Plan Living Area
  - 916 Sq Ft (85.1 SQ M)
  - Close Proximity To Hackney Marshes



A modern second-floor flat offering a superb combination of contemporary design and comfort on the borders of Walthamstow and Leyton. Built in 2019, the property spans an impressive 916 square feet and is presented in excellent condition throughout, making it a perfect choice for first time buyers.

As you step inside, you are greeted by a spacious open-plan kitchen, dining, and living area, designed for both entertaining and relaxing. The modern kitchen is equipped with high-quality appliances and generous storage, flowing seamlessly into the dining and living spaces to create a warm and welcoming environment.

The flat features two well-proportioned bedrooms, with the main bedroom enjoying the luxury of an en suite bathroom. The second bedroom is equally spacious and versatile, ideal for guests, a home office, or a growing family. Additionally, the property includes a large family bathroom with a shower over bath.

A private balcony further enhances this home, providing a charming outdoor retreat to enjoy morning coffee, unwind in the evening, or simply take in the fresh air.



These particulars, whilst believed to be accurate are set out as a general outline only for guidance and do not constitute any part of an offer or contract. Intending purchasers should not rely on them as statements of representation of fact, but must satisfy themselves by inspection or otherwise as to their accuracy. No person in this firms employment has the authority to make or give any representation or warranty in respect of the property.