

West Avenue

, London, E17 9QW

Offers in excess of £850,000



Floor Plan

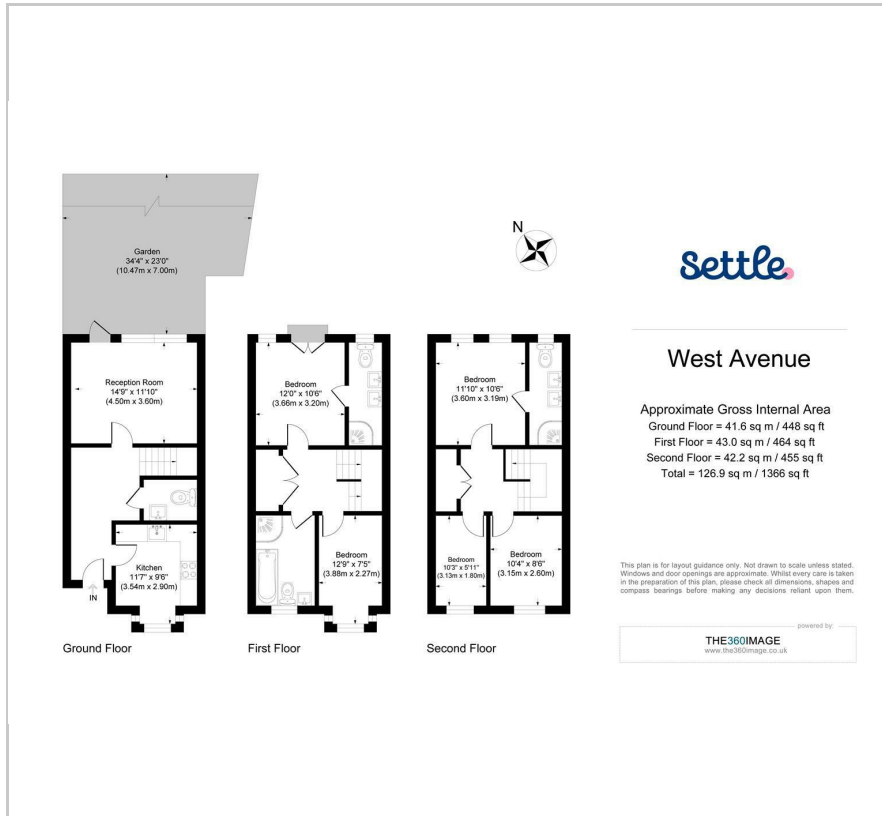

Area Map



Energy Efficiency Graph

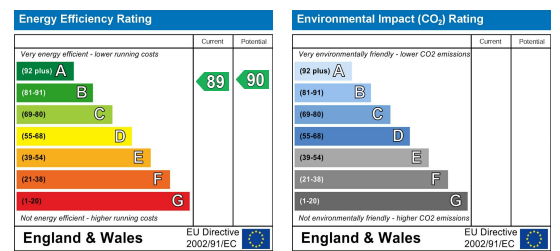

Viewing

Please contact our Settle Office on 0208 124 2522 if you wish to arrange a viewing appointment for this property or require further information.

- Semi Detached Town House
- Modern Build
- Walthamstow Village Location
- Two En-Suite Bedrooms
- Five Bedrooms
- 0.2m To Walthamstow Central Station
- South West Facing Garden
- Ground Floor W/C
- Modern Family Bathroom
- 1366 Sq Ft (126.9 SQ M)

This exquisite 5-bedroom townhouse is a modern marvel that proudly stands on the much desired western side of Walthamstow Village, just a short 2 minute stroll to Walthamstow Central Tube. Constructed just over four years ago, this handsome semi-detached house seamlessly blends the allure of contemporary living with impressive overall square footage and numerous storage options. The classic townhouse architecture is complemented by stylish and thoughtful design concepts with a ground floor featuring parquet wooden floors, a stunning bay fronted Kitchen/Dinner, ground floor W/C and a beautiful lounge area to the rear with bi fold doors that flood the space with natural light. The five bedrooms, spread across multiple floors, offer maximum versatility with two of the largest rooms featuring their very own en-suite bathrooms as well as a luxurious separate family bathroom. The remaining bedrooms are equally spacious, offering flexibility as guest bedrooms, home offices or a nursery. Finally, the impressive private rear garden has a much desired Southwest facing aspect attracting tones of sunshine. The mix of Lawn and a patio area creates the perfect place to entertain friends and family when the warmer summer months eventually return.



These particulars, whilst believed to be accurate are set out as a general outline only for guidance and do not constitute any part of an offer or contract. Intending purchasers should not rely on them as statements of representation of fact, but must satisfy themselves by inspection or otherwise as to their accuracy. No person in this firm's employment has the authority to make or give any representation or warranty in respect of the property.

187 Hoe Street, Walthamstow, London, E17 3AP
 Tel: 0208 124 2522 Email: info@settleast.co.uk