



Grosvenor Rise East

, London, E17 9LB

Offers in excess of £650,000



Floor Plan

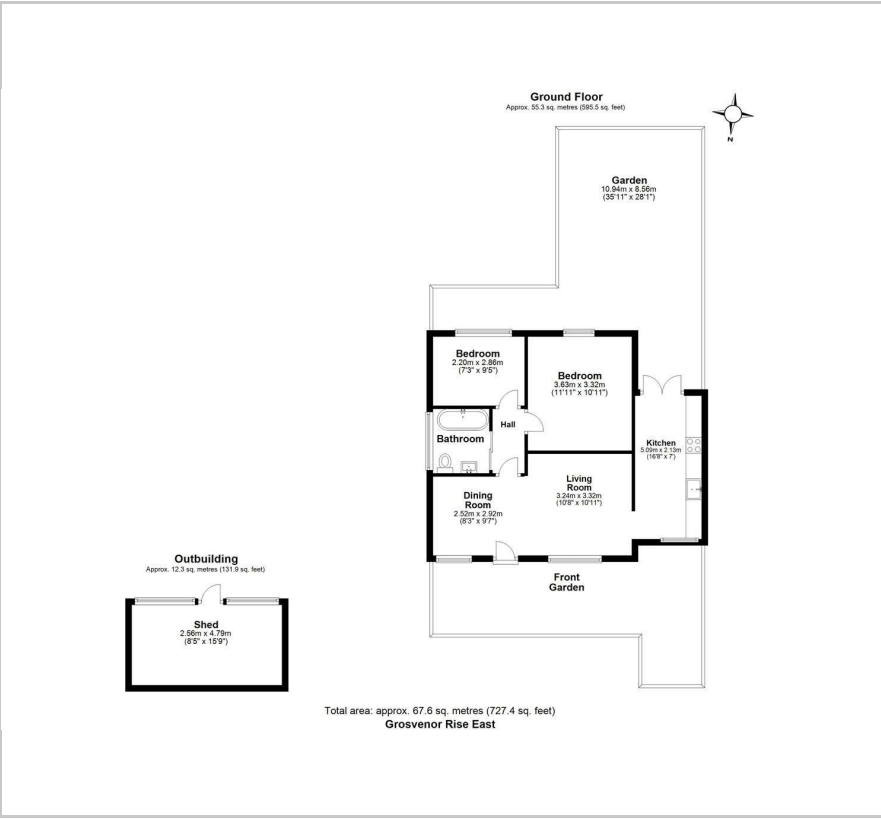

Area Map



Energy Efficiency Graph

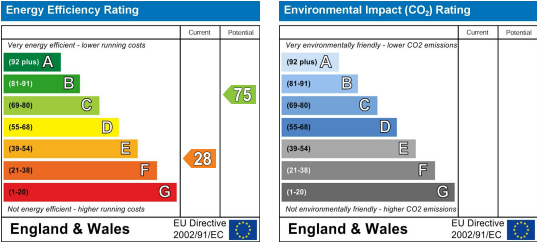

Viewing

Please contact our Settle Office on 0208 124 2522 if you wish to arrange a viewing appointment for this property or require further information.

- Unique detached two-bedroom home in the heart of Walthamstow Village
- Spacious front and rear gardens, perfect for relaxing or entertaining
- Nestled 30m off the street, providing a peaceful and secluded atmosphere
- Steps from Orford Road, with a variety of independent shops, pubs, and eateries
- Fully renovated with modern finishes, including underfloor heating in every room
- Versatile outbuilding with running power, ideal for home office or studio use
- Located on Grosvenor Rise East, one of E17's most desirable streets
- 0.5 miles to Walthamstow Central Station with access to Victoria Line and Overground



Unique Two Bedroom Family Home, Tucked Away and in the Heart of Walthamstow Village.

This charming detached home is a hidden gem, boasting two spacious bedrooms and a full renovation by the current owners. The home features a well-appointed family bathroom and a fully functional kitchen, perfect for everyday convenience, and has underfloor heating in every single room. The property enjoys an abundance of outdoor space, with both front and rear gardens providing a peaceful retreat or space for entertaining. Nestled 30m away from the street, this detached home is a peaceful oasis and a real sun trap. Additionally, a versatile outbuilding with running power adds further value, making it ideal for use as a home office, workshop, or studio. Set on one level, this home combines comfort, style, and practicality.



These particulars, whilst believed to be accurate are set out as a general outline only for guidance and do not constitute any part of an offer or contract. Intending purchasers should not rely on them as statements of representation of fact, but must satisfy themselves by inspection or otherwise as to their accuracy. No person in this firm's employment has the authority to make or give any representation or warranty in respect of the property.