

Floor Plan

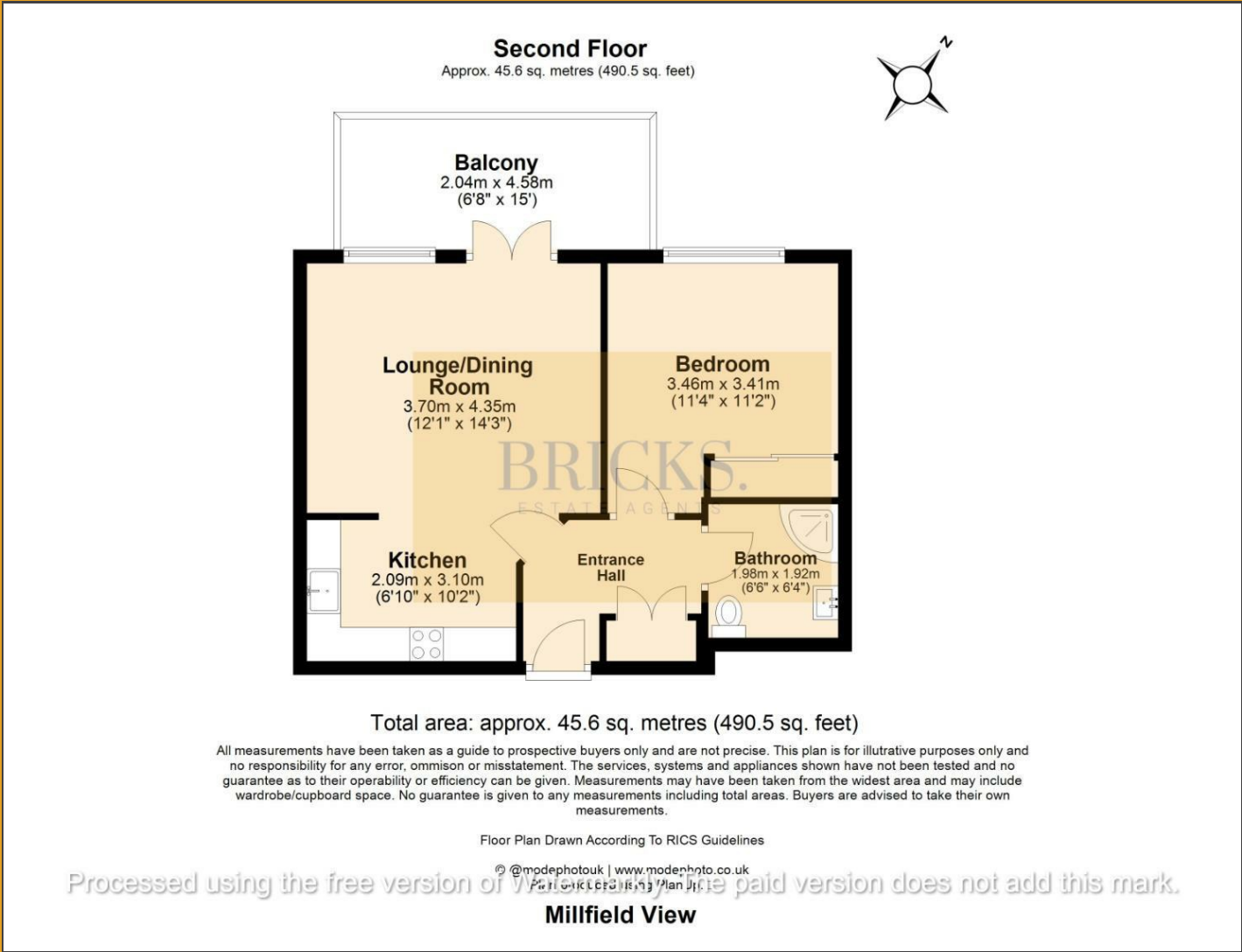

BRICKS.  
ESTATE AGENTS



BRICKS.  
ESTATE AGENTS

£300,000

These particulars, whilst believed to be accurate are set out as a general outline only for guidance and do not constitute any part of an offer or contract. Intending purchasers should not rely on them as statements of representation of fact, but must satisfy themselves by inspection or otherwise as to their accuracy. No person in this firms employment has the authority to make or give any representation or warranty in respect of the property.

Contact Us

- 0203 634 9998
- hello@bricksestateagents.co.uk
- 186 Queens Road, Buckhurst Hill, Essex, IG9 5BD

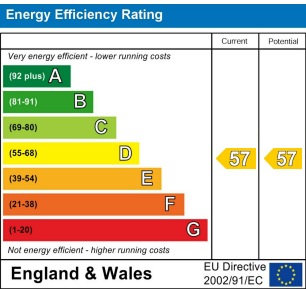

27 Millfield View Ashwells Road,  
Brentwood, CM15 9SE

Bricks Estate Agents proudly presents an extraordinary opportunity to own this expansive 1-bedroom apartment nestled in the highly sought-after Millfield Park Estate, located at Millfield View, Brentwood. This idyllic setting combines the tranquillity of countryside living with the vibrant charm of Brentwood, offering residents a perfect blend of nature and convenience. Enjoy nearby parks, golf courses, and delightful local shops, all while benefiting from excellent transport links to London and beyond.



# 27 Millfield View Ashwells Road, Brentwood, CM15 9SE



- \*Guide Price £300,000 - £310,000\*
- Lease Length - 997 Years Remaining | Council Tax - Band B
- Private Gated Community And Allocated Parking Bay
- Top Of The Range High Quality Finishing
- West Facing Balcony & Oozing With Natural Light
- Service Charge - £1,800 Per Annum | Ground Rent - £0.00 Per Annum
- Tastefully Decorated & Designed
- Large Balcony Overlooking Wildlife & Luxury Communal Grounds
- High Spec Bosch Appliances Integrated Throughout The Property
- Ample Storage Space In This Large One Bedroom Apartment

**Kitchen**  
6'10" x 10'2" (2.09 x 3.10)

**Lounge / Dining Room**  
6'8" x 15'0" (2.04 x 4.58)

**Balcony**  
6'8" x 15'0" (2.04 x 4.58)

**Master Bedroom**  
11'4" x 11'2" (3.46 x 3.41)

**Bathroom**  
6'5" x 6'3" (1.98 x 1.92)

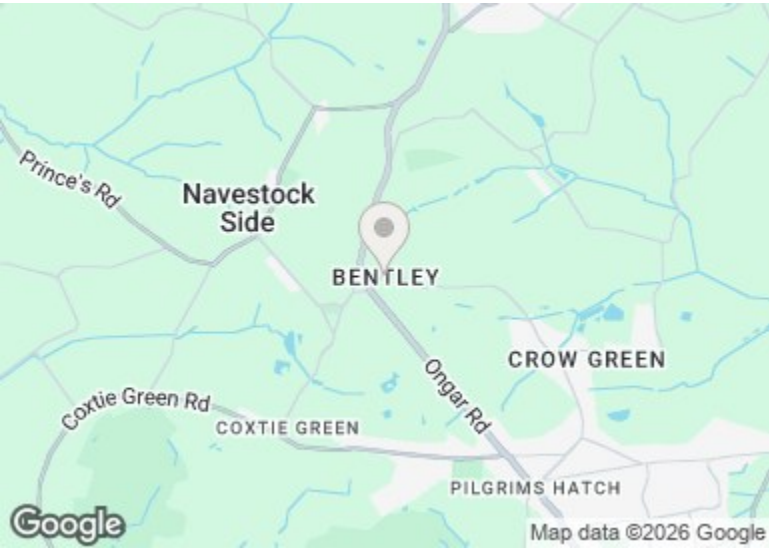

Directions

BRICKS.  
ESTATE AGENTS