

Floor Plan

BRICKS.  
ESTATE AGENTS

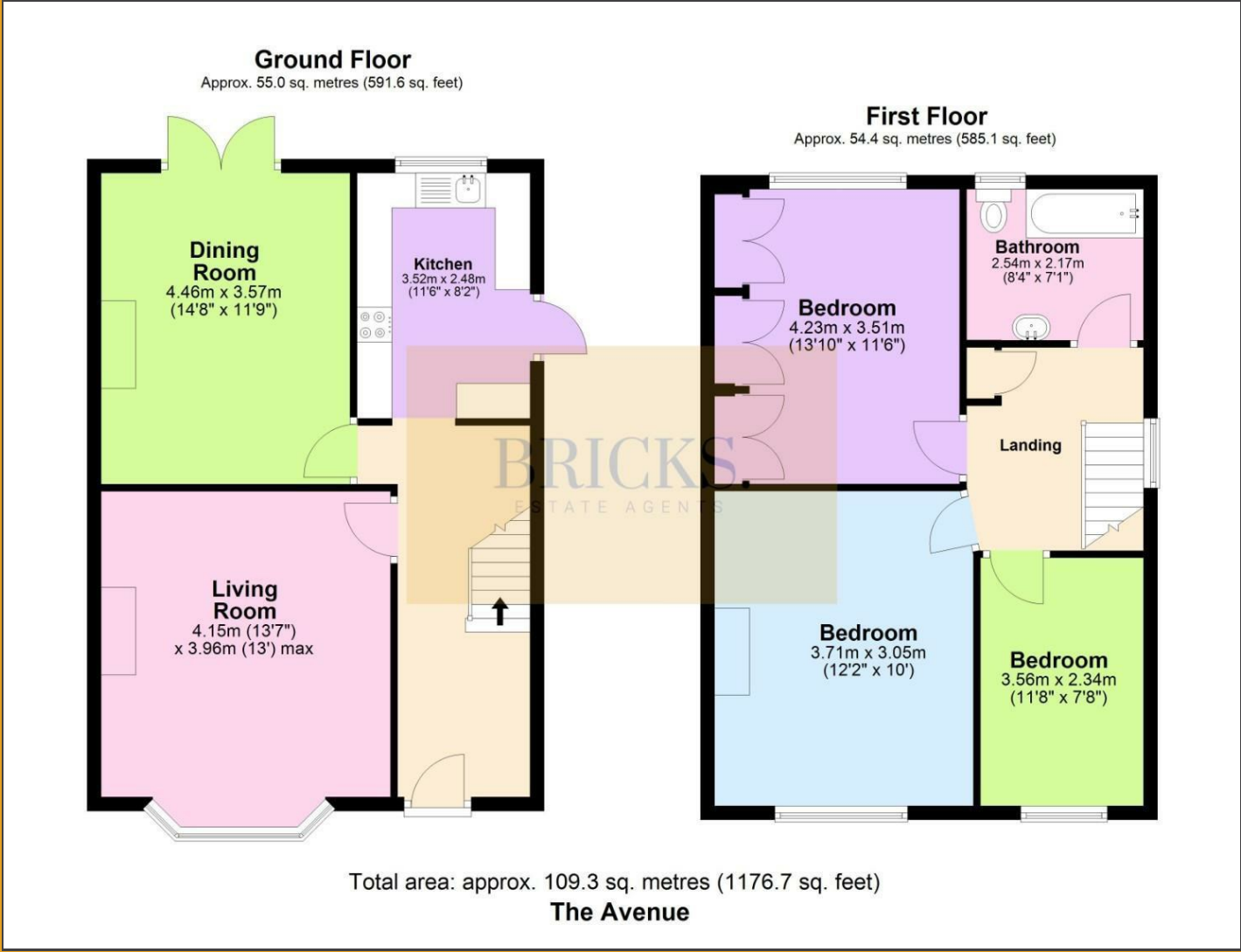

BRICKS.  
ESTATE AGENTS

£875,000

These particulars, whilst believed to be accurate are set out as a general outline only for guidance and do not constitute any part of an offer or contract. Intending purchasers should not rely on them as statements of representation of fact, but must satisfy themselves by inspection or otherwise as to their accuracy. No person in this firms employment has the authority to make or give any representation or warranty in respect of the property.

Contact Us

- 0203 634 9998
- hello@bricksestateagents.co.uk
- Crate 9 15 Oakwood Hill Industrial Estate, Loughton, Essex, IG10 3TZ

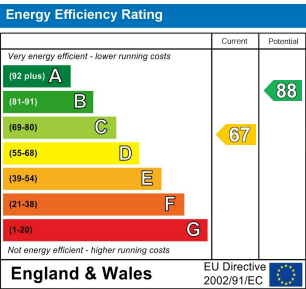

100 The Avenue,  
London, E4 9RB

Bricks Estate Agents are delighted to present this stunning three-bedroom semi-detached family home, situated on the highly sought-after The Avenue in Highams Park (E4 9RB). Lovingly cared for by the same family for over 34 years, this charming property offers a unique combination of character, comfort, and timeless appeal, making it the perfect setting for family living.



# 100 The Avenue, London, E4 9RB

3

1

2

D

- \*£875,000 - £900,000 Guide Price\*
  - Three Large Bedroom Semi Detached Family Home
  - Oozing With Natural Light This Breath-taking Property Boasts Windows All Over
  - Character Filled Home With Original Georgian Fireplace
  - Located In The Heart Of Highams Park Station Walking Distance
- \*Open Day Saturday 18th January 2025 Appointment Based Booking Only\*
  - Huge Potential And Rare Property To Come To Market
  - 110ft Garden Allowing Space For The Kids To Run Wild Or Even Extend This Property
  - Off Road Parking
  - Highams Park Lake And Green Spaces Add To The Area's Appeal

Living Room  
13'7" x 12'11" (4.15 x 3.96)

Dining Room  
14'7" x 11'8" (4.46 x 3.57)

Kitchen  
11'6" x 8'1" (3.52 x 2.48)

Master Bedroom  
13'10" x 11'6" (4.23 x 3.51)

Bedroom Two  
12'2" x 10'0" (3.71 x 3.05)

Bedroom Three  
8'3" x 7'1" (2.54 x 2.17)

Bathroom  
8'3" x 7'1" (2.54 x 2.17)

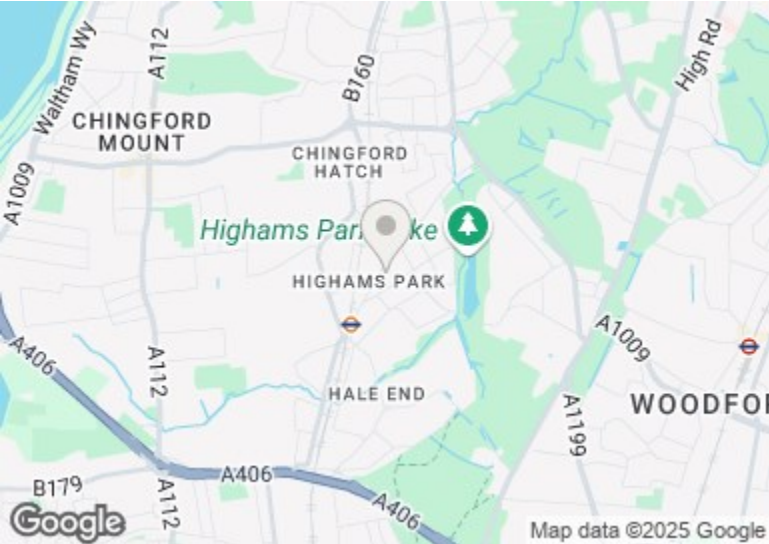

Directions

