



42 Victoria Parade, Ashton-On-Ribble, PR2 1DT
£395,000

This delightful 1920s three-bedroom detached home is full of charm and character, offering spacious living areas and a wonderful blend of period features and modern comforts. Situated in a desirable location, it provides a warm and inviting atmosphere, perfect for families or those who love to entertain.

The property boasts a large dining room at the front, ideal for hosting gatherings. The well-appointed “SieMatic” kitchen including a dining area, providing a cosy space for everyday meals. A separate lounge offers a comfortable retreat, leading to a stunning orangery with a double-glazed glass ceiling, flooding the space with natural light. Upstairs, three generously sized double bedrooms provide ample space, complemented by a stylish family bathroom. Additional benefits include a large garage, offering excellent storage or workshop potential.

With its spacious layout, characterful features, and 1920s charm, this home is a rare find. If you have any questions or would like to arrange a viewing, please get in touch.

Floor Plan

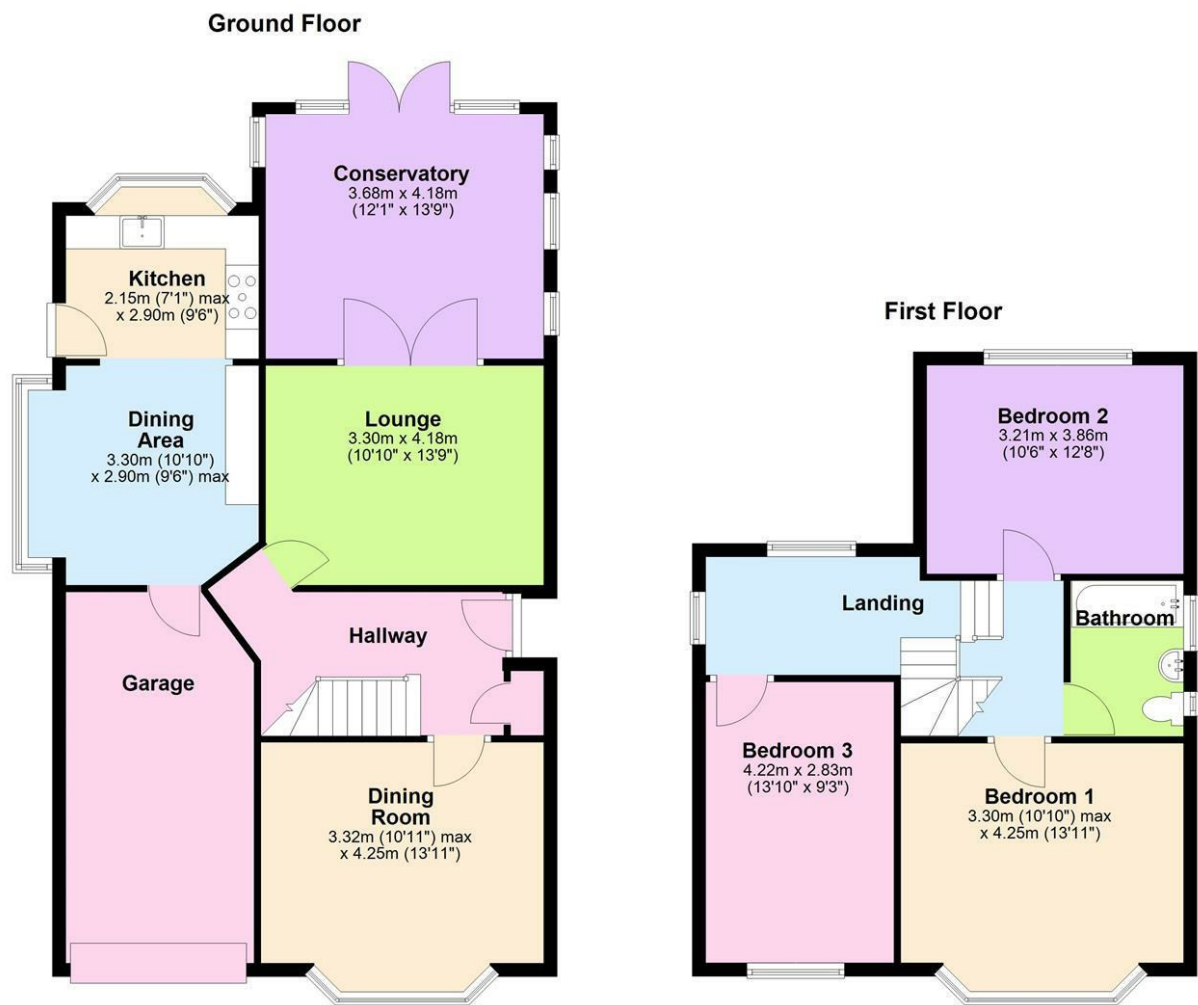

Area Map

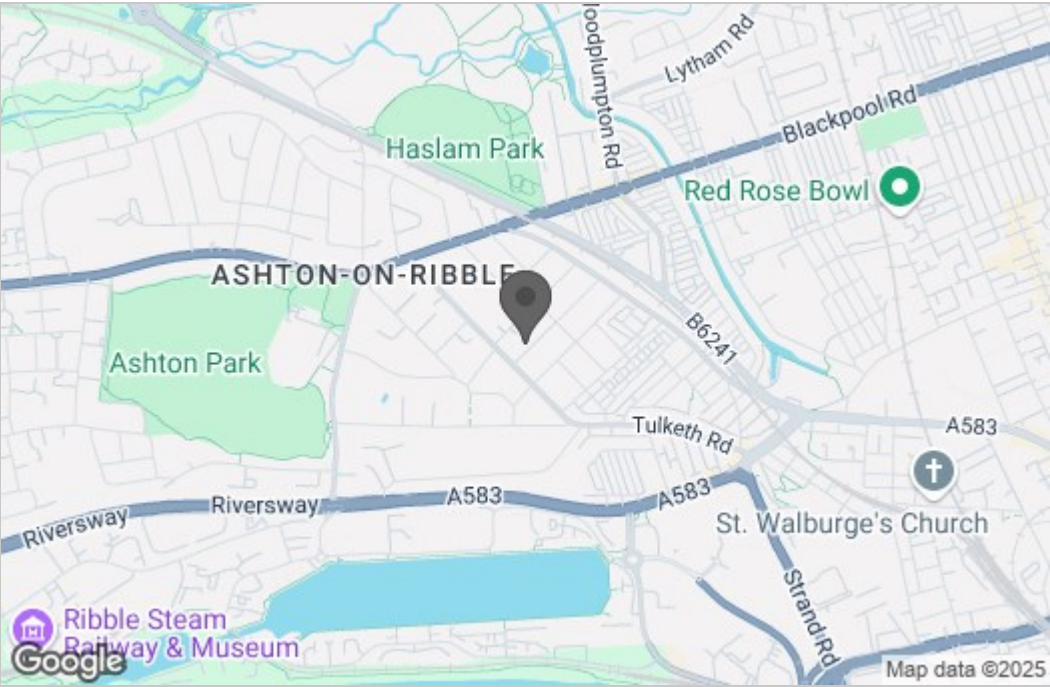

Energy Efficiency Graph

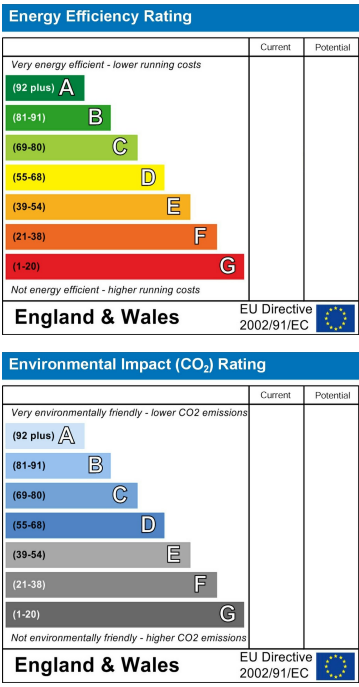

These particulars, whilst believed to be accurate are set out as a general outline only for guidance and do not constitute any part of an offer or contract. Intending purchasers should not rely on them as statements of representation of fact, but must satisfy themselves by inspection or otherwise as to their accuracy. No person in this firms employment has the authority to make or give any representation or warranty in respect of the property.