



1 Kingsfold Drive, Penwortham, PR1 9DL

£185,000

This delightful 3-bedroom double semi-detached house offers a perfect blend of comfort and convenience. The property boasts a spacious and modern layout, ideal for families. Featuring off-road parking and a car port to the side, the plot is a great size.

Inside, the house features a well-appointed kitchen with dining space, making meal preparation and family gatherings a pleasure. The large lounge area provides a comfortable space for relaxation and entertaining guests, while a convenient downstairs toilet adds to the functionality of the home. Upstairs, three generously sized bedrooms provide ample space for relaxation and storage. Recent updates include a new roof fitted in 2023, ensuring peace of mind and added value to the property.

The private rear garden, in particular, offers an ideal space for relaxation, play, or entertaining guests. Additionally, there are outbuildings to the rear, offering versatile space for storage or potential workshop use.

This home is perfect for those looking for a blend of modern amenities and a tranquil living environment. Don't miss the opportunity to make this charming house your new home. Contact us today to arrange a viewing.

Floor Plan

Ground Floor

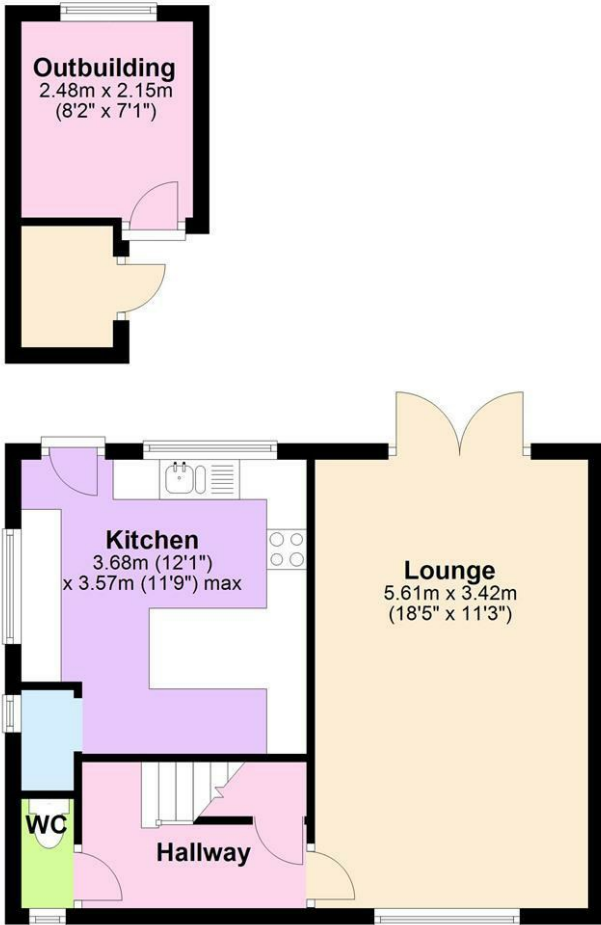

First Floor



Area Map

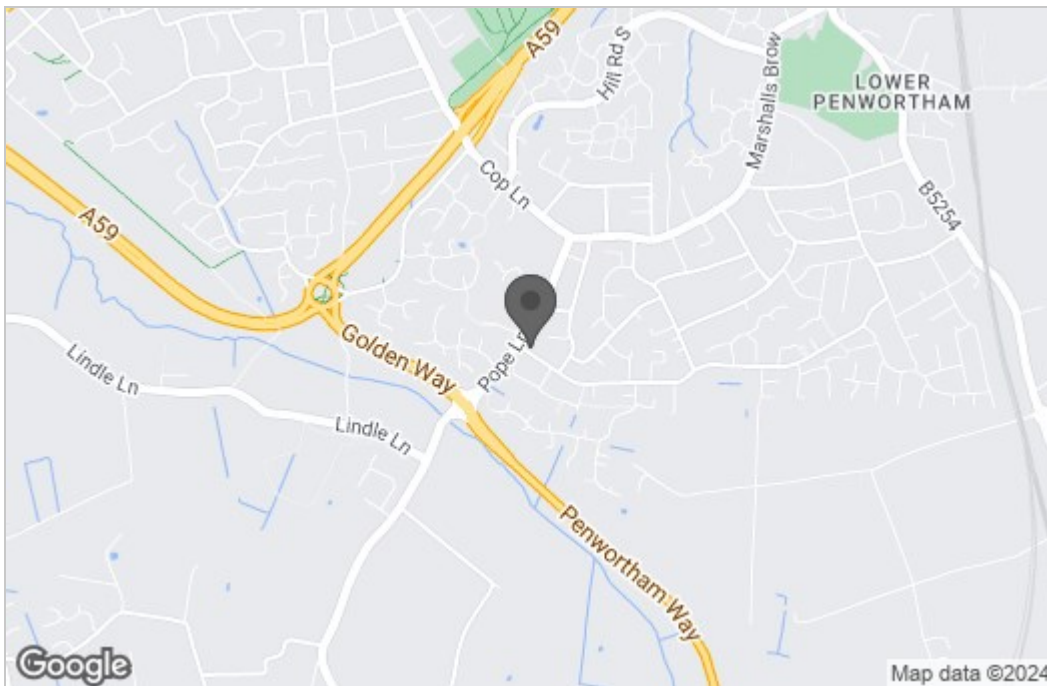

Energy Efficiency Graph

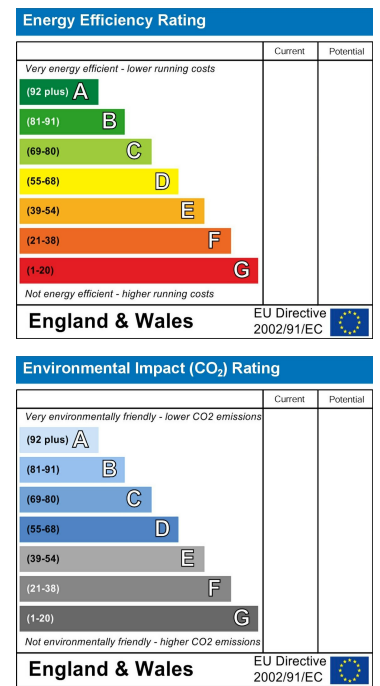

These particulars, whilst believed to be accurate are set out as a general outline only for guidance and do not constitute any part of an offer or contract. Intending purchasers should not rely on them as statements of representation of fact, but must satisfy themselves by inspection or otherwise as to their accuracy. No person in this firm's employment has the authority to make or give any representation or warranty in respect of the property.