

Douglas Road, Atherton, M46 9FE
£275,000

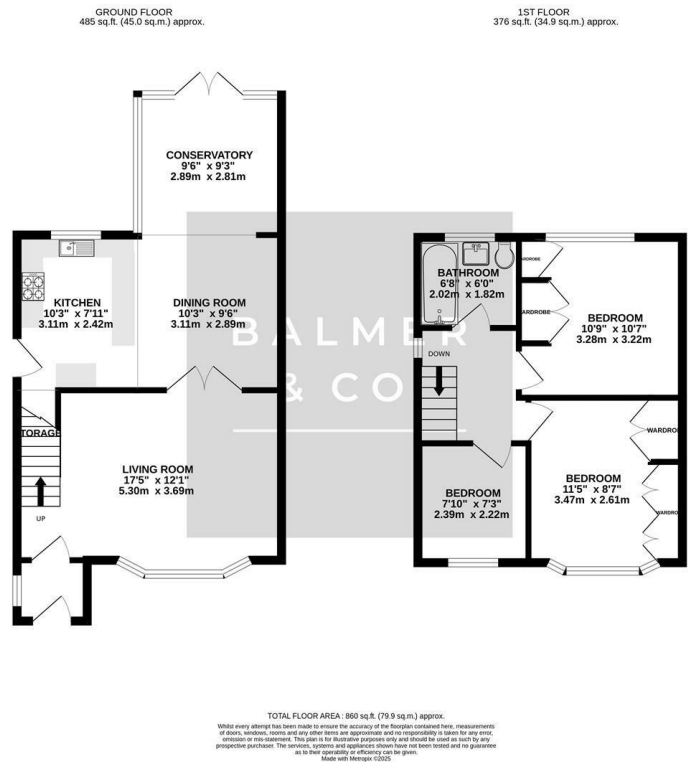

BALMER & CO in ATHERTON are delighted to offer FOR SALE this three bedroom semi detached home located on Douglas Road, a popular and well regarded residential area in Atherton. Immaculately presented throughout with an extension to the ground floor it is ready to move into, suiting a wide range of buyers. The ground floor comprising in brief; entrance porch, bay fronted living room with log burner, modern open plan kitchen/dining room opening out into a further sitting room with patio doors out to the rear garden. To the first floor there are three bedrooms, two doubles and one single which all benefit from fitted wardrobes, and a three piece family bathroom suite. Externally, driveway parking is located to the front of the property with a good sized, enclosed garden to the rear which is not directly overlooked. Early viewings highly recommended, all enquiries welcome.

Floor Plan



Area Map

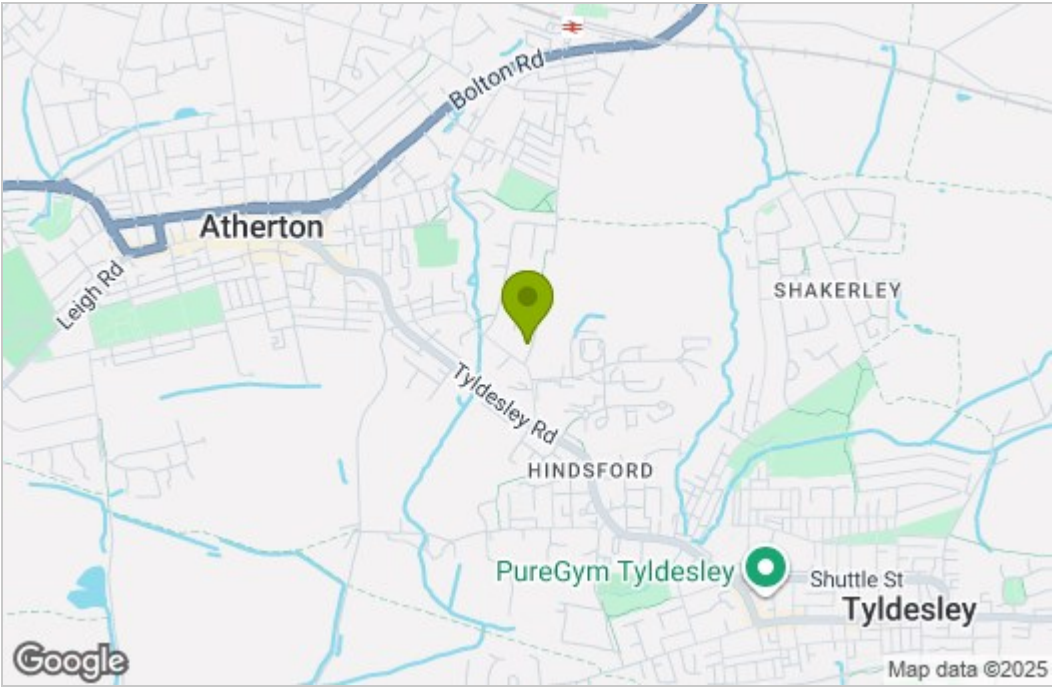

Energy Efficiency Graph

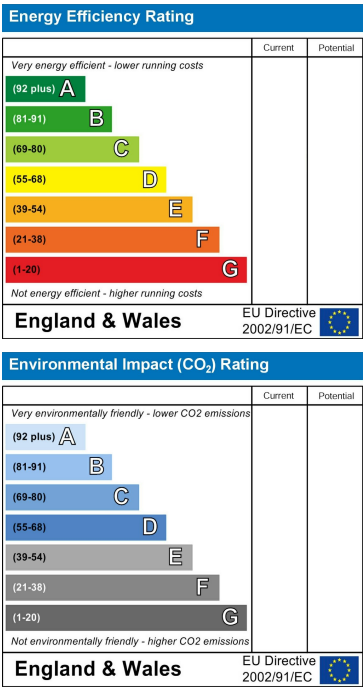

These particulars, whilst believed to be accurate are set out as a general outline only for guidance and do not constitute any part of an offer or contract. Intending purchasers should not rely on them as statements of representation of fact, but must satisfy themselves by inspection or otherwise as to their accuracy. No person in this firms employment has the authority to make or give any representation or warranty in respect of the property.