

Everest Road, Atherton, M46 9WT
£180,000

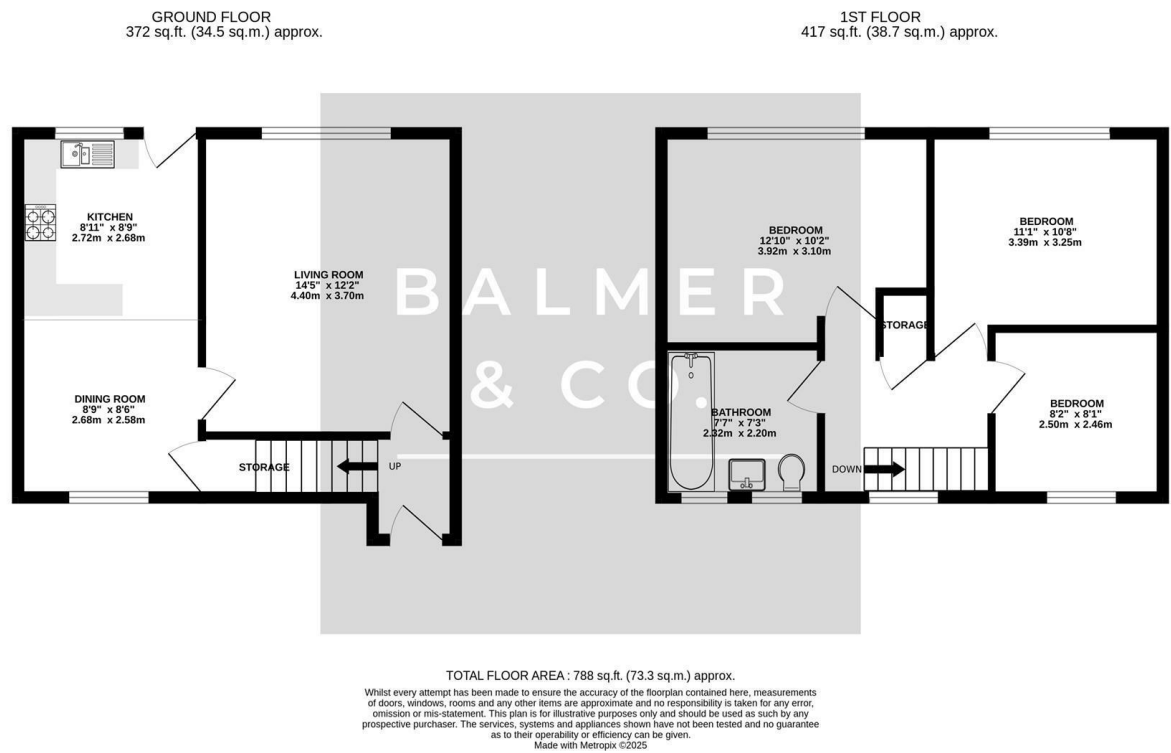

BALMER & CO in ATHERTON are delighted to offer FOR SALE this three bedroom mid terraced located on Everest Road in Atherton. Offering spacious accommodation and conveniently placed for access to a wide range of amenities including shops, schools and transport links it would suit a wide range of buyers. The ground floor comprising in brief; entrance hallway, spacious lounge with coal fire and a modern kitchen/dining room with under stair storage. To the first floor are two generous double bedrooms, a third single bedroom and a three piece family bathroom suite. Externally, the property has off road parking to the front with a good sized, enclosed garden to the rear. Early viewings highly recommended, all enquiries welcome.

Floor Plan



Area Map

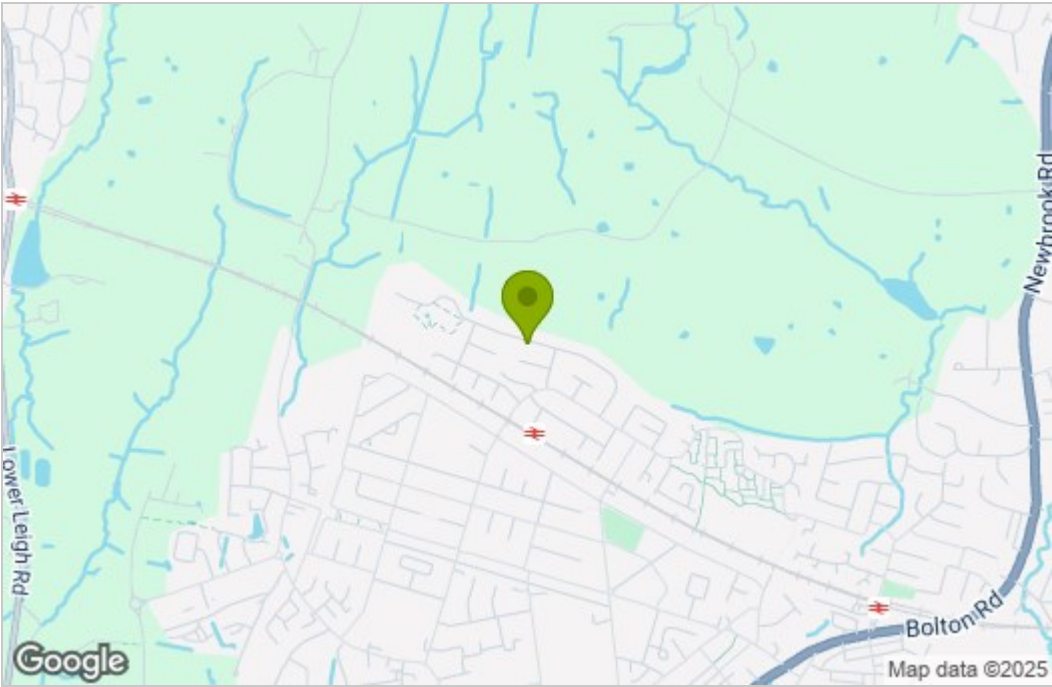

Energy Efficiency Graph

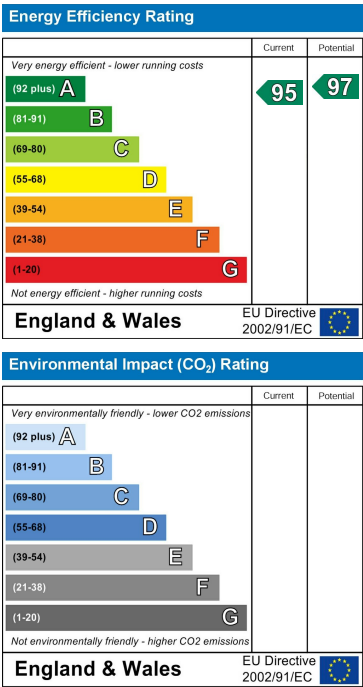

These particulars, whilst believed to be accurate are set out as a general outline only for guidance and do not constitute any part of an offer or contract. Intending purchasers should not rely on them as statements of representation of fact, but must satisfy themselves by inspection or otherwise as to their accuracy. No person in this firms employment has the authority to make or give any representation or warranty in respect of the property.