

Gadfield Grove, Atherton, M46 0SJ
£130,000

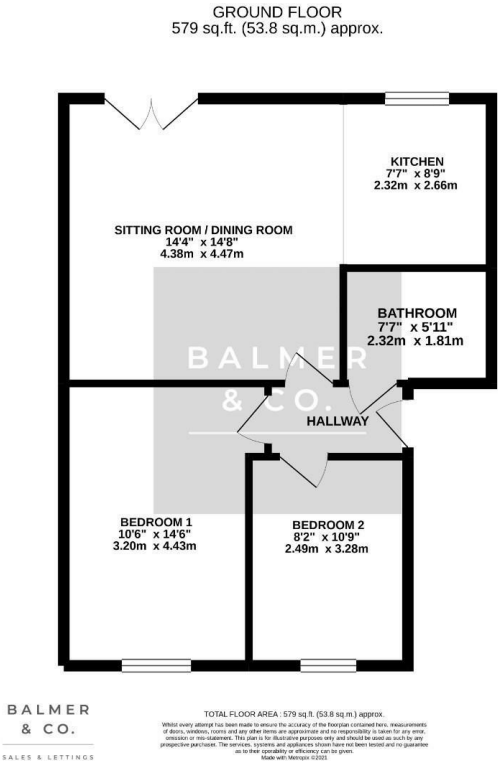

BALMER & CO in ATHERTON are delighted to offer FOR SALE this two bedroom, first floor apartment situated on the ever popular Gadbury Fold development in Atherton. Well presented throughout and ideally offered with no onward chain, it would suit a wide range of buyers. Entrance to the building is via a communal entrance with secure intercom system and open staircase to the first floor. Entrance to the property reveals a hallway which leads to the open plan living/dining room and kitchen complete with integrated fridge, freezer, four ring induction hob and single electric oven. Two double bedrooms, the master benefitting from fitted wardrobes, and a three piece bathroom suite complete the accommodation. Externally, there are communal gardens with a car park offering an allocated space as well as visitor parking. Early viewings highly recommended, all enquiries welcome.

Floor Plan



Area Map

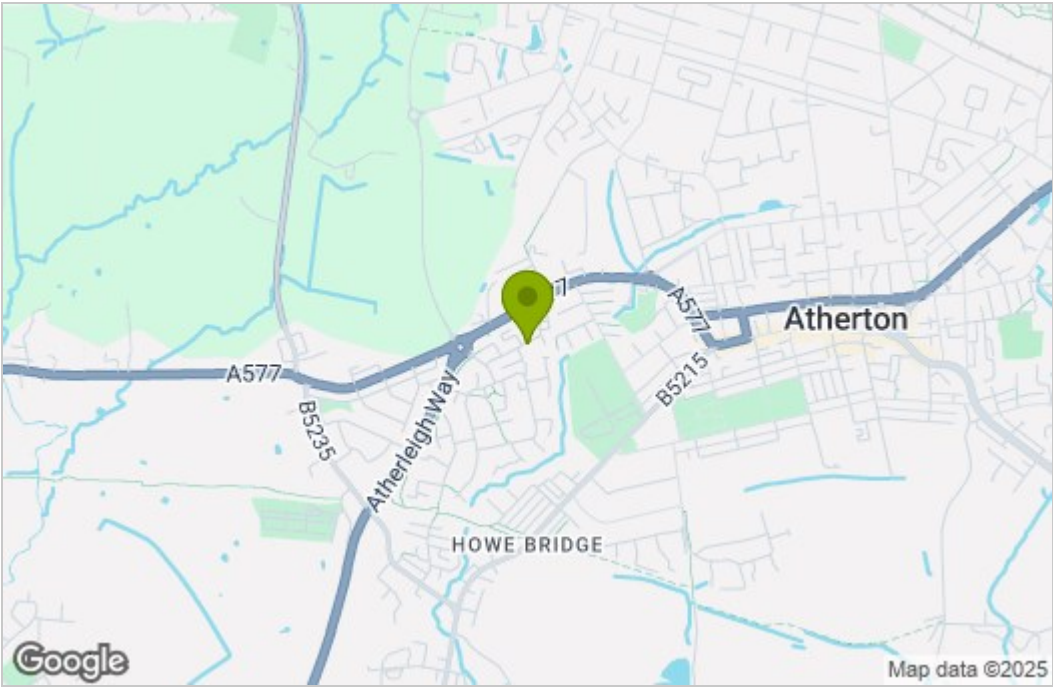

Energy Efficiency Graph

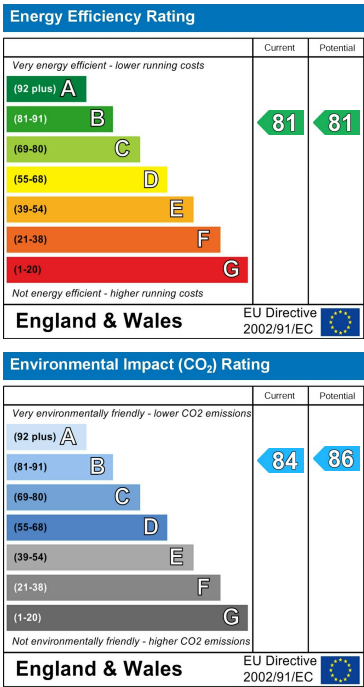

These particulars, whilst believed to be accurate are set out as a general outline only for guidance and do not constitute any part of an offer or contract. Intending purchasers should not rely on them as statements of representation of fact, but must satisfy themselves by inspection or otherwise as to their accuracy. No person in this firm's employment has the authority to make or give any representation or warranty in respect of the property.