

Lodge Grove, Atherton, M46 9BZ
£210,000

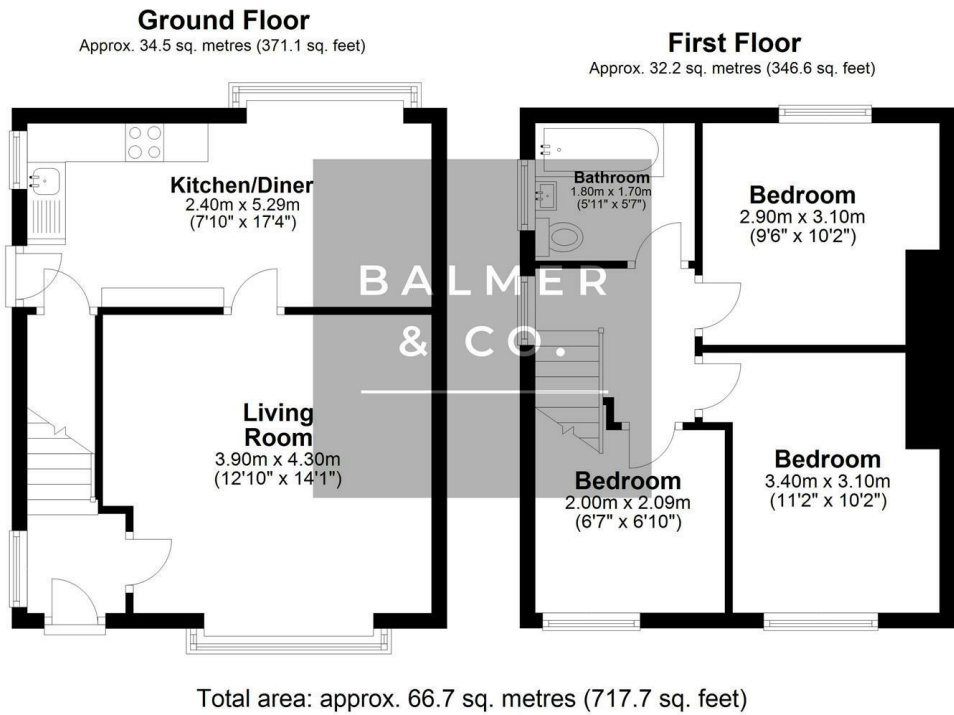

BALMER & CO in ATHERTON are delighted to offer FOR SALE this spacious three bedroom semi detached property, conveniently located on Lodge Grove in Hindsford, offering easy access to both Atherton and Tyldesley town centres. Well presented throughout and ideally offered with no onward chain it would be perfect for young or growing families as it also falls within the catchment area for popular schools. Entrance to the property reveals an entrance hall which leads through to the living room as well as staircase to the first floor. A newly fitted kitchen/dining room completes the ground floor. To the first floor are three bedrooms, two of which are doubles with a newly fitted bathroom suite completing the accommodation. Externally, there is an enclosed low maintenance garden with off road parking to the front and a fantastic sized South/West facing garden to the rear. Early viewings highly recommended, all enquiries welcome.

Floor Plan



Area Map

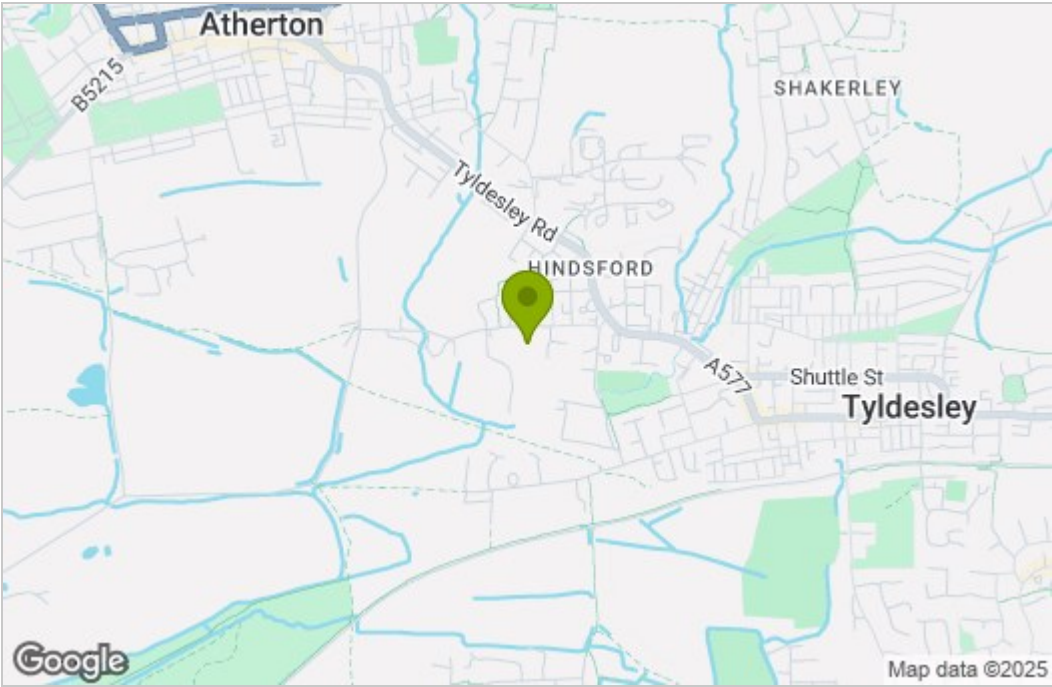

Energy Efficiency Graph

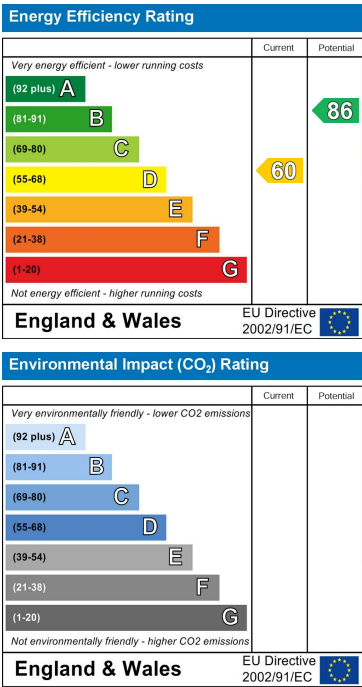

These particulars, whilst believed to be accurate are set out as a general outline only for guidance and do not constitute any part of an offer or contract. Intending purchasers should not rely on them as statements of representation of fact, but must satisfy themselves by inspection or otherwise as to their accuracy. No person in this firms employment has the authority to make or give any representation or warranty in respect of the property.