

Ina Avenue, Bolton, BL1 5PH
Offers Over £260,000

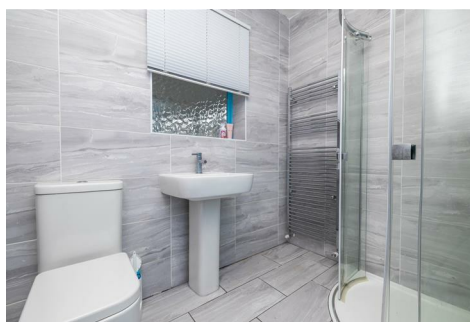

BALMER & CO in ATHERTON are delighted to offer FOR SALE this fantastic three/four bedroom semi-detached bungalow in the ever popular Doffcocker area of Bolton. Offering excellent family living accommodation and ideally offered for sale with no onward chain, it must be viewed to be fully appreciated. Comprising in brief entrance porch, central hallway, large living room, modern fitted kitchen/dining room, conservatory, two double bedrooms and a modern fitted three piece shower room completing the ground floor. To the first floor is a large master bedroom, fourth bedroom/office and a three piece piece family bathroom. Externally the property occupies a generous plot with a garden frontage, long driveway and detached garage to the side providing off road parking for up to four vehicles. To the rear there is a nicely presented North East facing garden. Early viewings highly recommended, all enquiries welcome.

Floor Plan

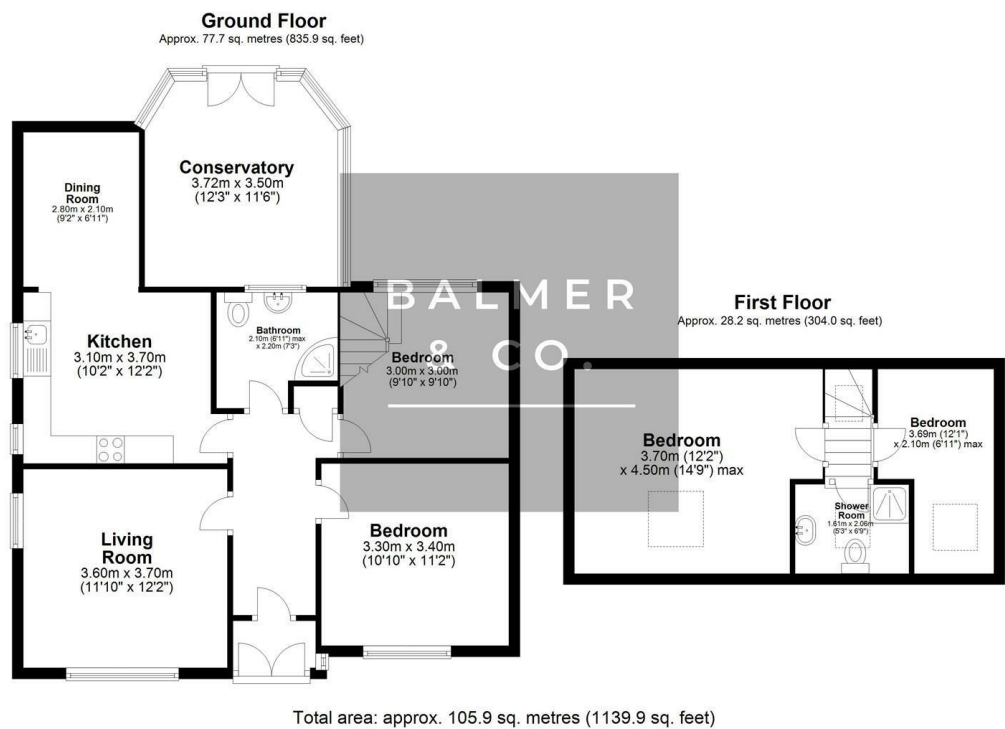

Area Map

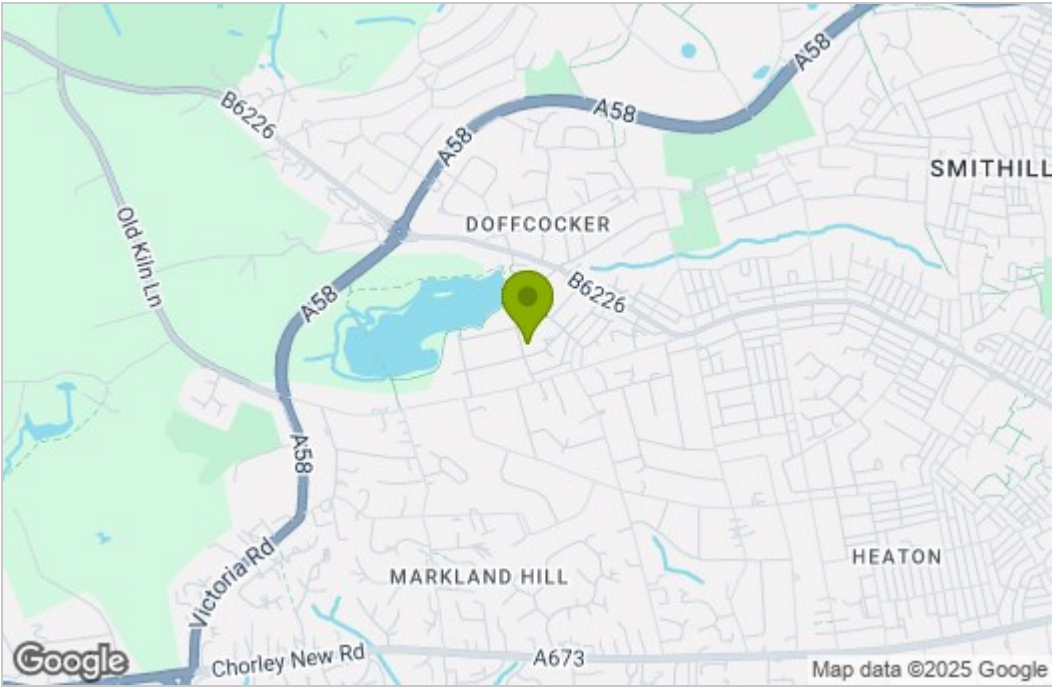

Energy Efficiency Graph

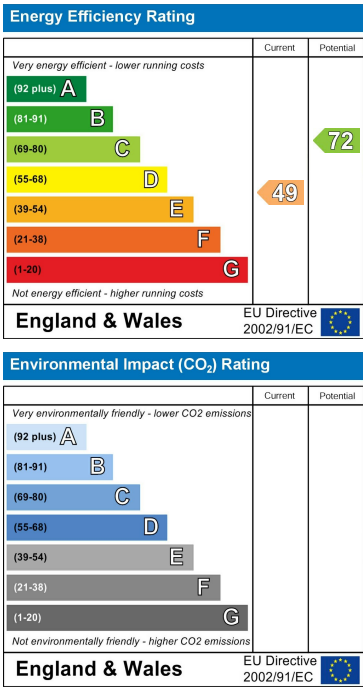

These particulars, whilst believed to be accurate are set out as a general outline only for guidance and do not constitute any part of an offer or contract. Intending purchasers should not rely on them as statements of representation of fact, but must satisfy themselves by inspection or otherwise as to their accuracy. No person in this firms employment has the authority to make or give any representation or warranty in respect of the property.