

Mosley Common Road, M28 1AF
Offers Over £260,000

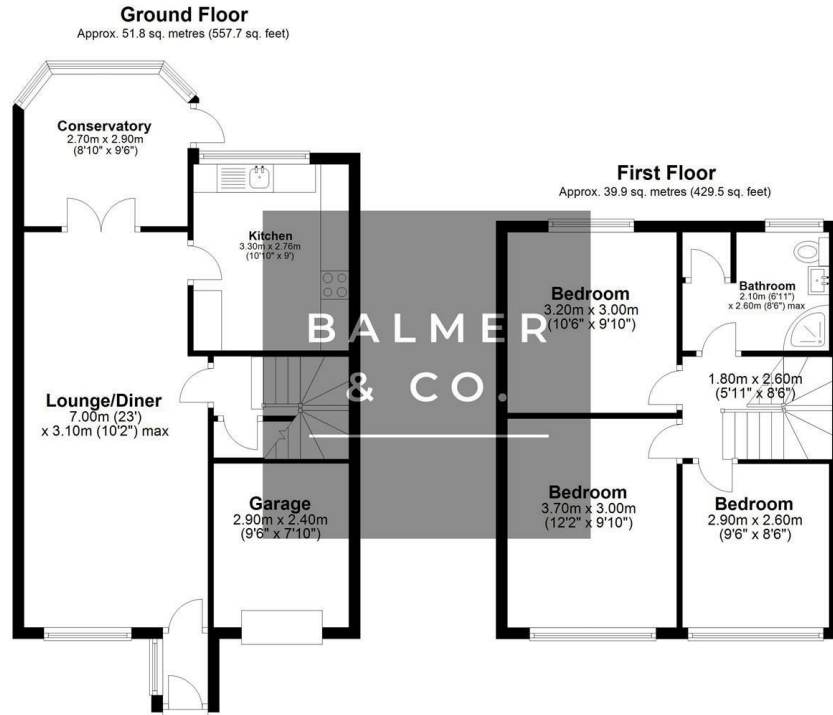

BALMER & CO in TYLDESLEY are delighted to offer FOR SALE this fantastic three bedroom semi-detached house in Mosley Common. Offering excellent family living accommodation, this property comprises in brief of entrance porch, open plan living/dining room, modern fitted kitchen, with a large conservatory to the rear completing the ground floor. To the first floor is a large master bedroom, large second double bedroom, third double bedroom, with three a piece shower room completing the accommodation on offer. Externally the property is garden fronted with a driveway and garage providing off-road parking and storage, whilst to the rear there is a large, South facing garden with side access to the front. The property is also conveniently located close to the v2 Leigh-Manchester guided busway. Early viewings highly recommended, all enquiries welcome.

Floor Plan



Total area: approx. 91.7 sq. metres (987.2 sq. feet)

Area Map

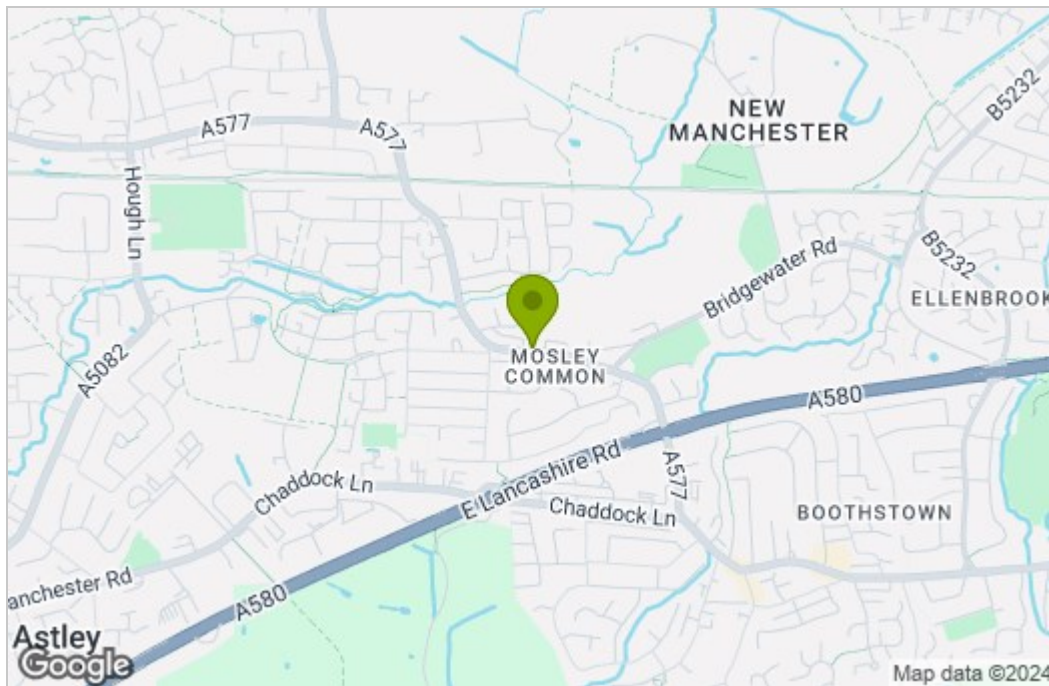

Energy Efficiency Graph

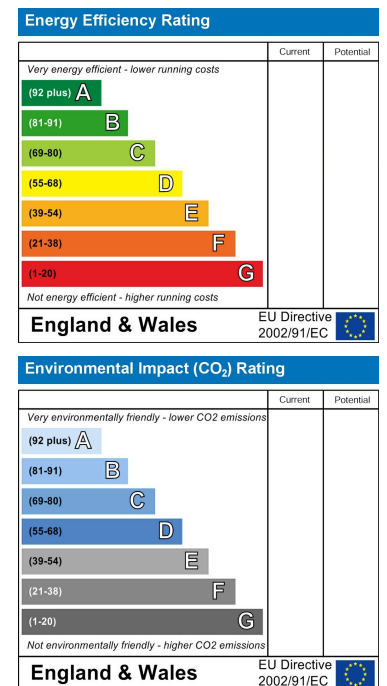

These particulars, whilst believed to be accurate are set out as a general outline only for guidance and do not constitute any part of an offer or contract. Intending purchasers should not rely on them as statements of representation of fact, but must satisfy themselves by inspection or otherwise as to their accuracy. No person in this firm's employment has the authority to make or give any representation or warranty in respect of the property.