

Dorning Street, Tyldesley, M29 8FS
£119,950

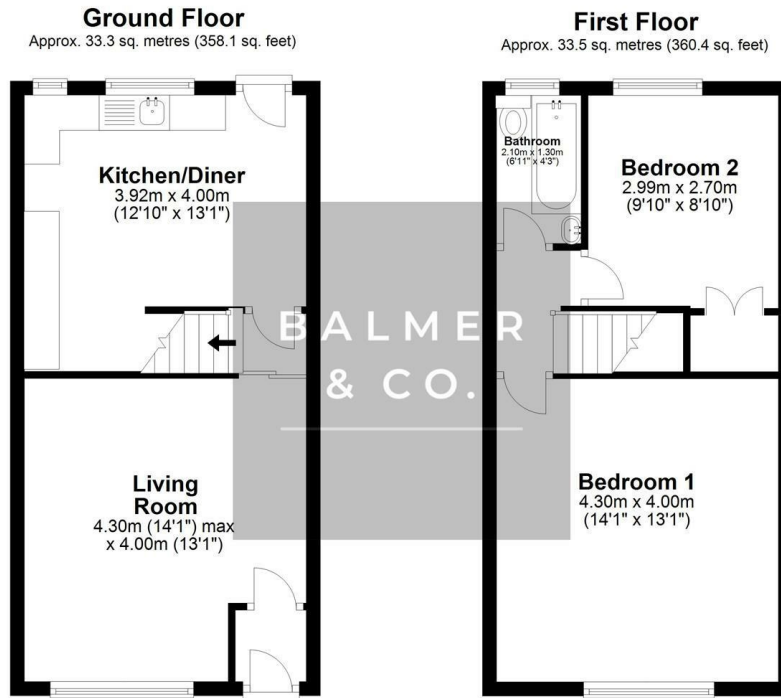

BALMER & CO in TYLDESLEY are delighted to offer FOR SALE with no onward chain this two bedroom mid-terrace house close to Tyldesley town centre. Although this property does require modernisation, there are no known maintenance issues and there have been upgrades to the front and rear doors, as well as the central heating system. Comprising in brief of entrance vestibule, large living room with gas fireplace and surround, with a fitted kitchen/dining room completing the ground floor. To the first floor is a large master bedroom with fitted wardrobes, second single bedroom, with three piece bathroom completing the accommodation on offer. Externally the property is garden fronted whilst to the rear there is a low maintenance, enclosed yard. Early viewings highly recommended, all enquiries welcome.

Floor Plan



Total area: approx. 66.8 sq. metres (718.5 sq. feet)

Area Map



Energy Efficiency Graph

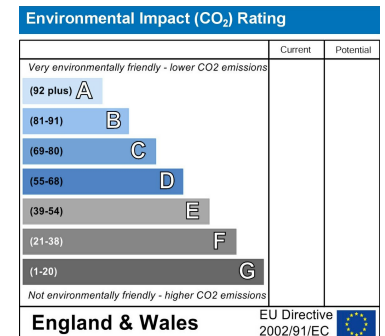
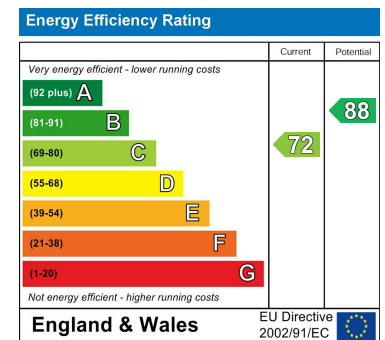

These particulars, whilst believed to be accurate are set out as a general outline only for guidance and do not constitute any part of an offer or contract. Intending purchasers should not rely on them as statements of representation of fact, but must satisfy themselves by inspection or otherwise as to their accuracy. No person in this firm's employment has the authority to make or give any representation or warranty in respect of the property.