

Blakemore Park, Atherton, M46 0EY
£79,950



BALMER & CO are delighted to offer FOR SALE this one bedroom, second floor apartment located on Blakemore Park, a popular development in Atherton. Well presented throughout and ideally offered with no onward chain it would make an ideal first time buy or investment opportunity. Comprising in brief; communal and private entrance hallway, open plan sitting room and kitchen with space for freestanding appliances. A double bedroom and three piece shower room complete the internal accommodation. Externally there are communal gardens with a secure gated car park to the rear with an allocated parking space. Early viewings highly recommended, all enquiries welcome.

Floor Plan

Ground Floor

Approx. 32.7 sq. metres (352.3 sq. feet)

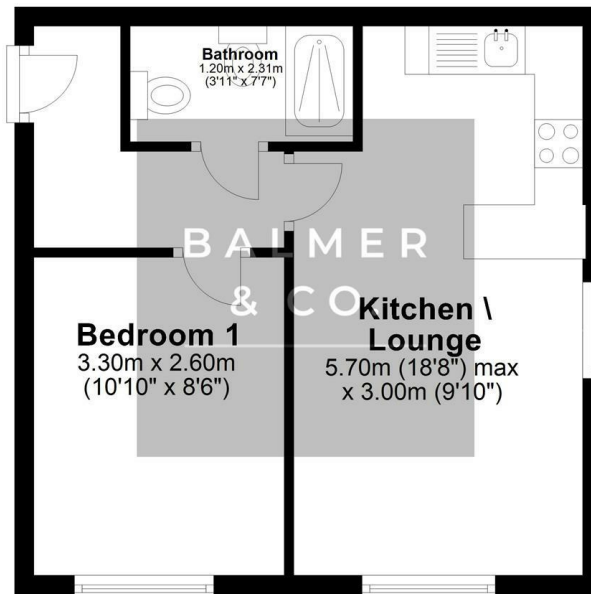

Total area: approx. 32.7 sq. metres (352.3 sq. feet)

Area Map

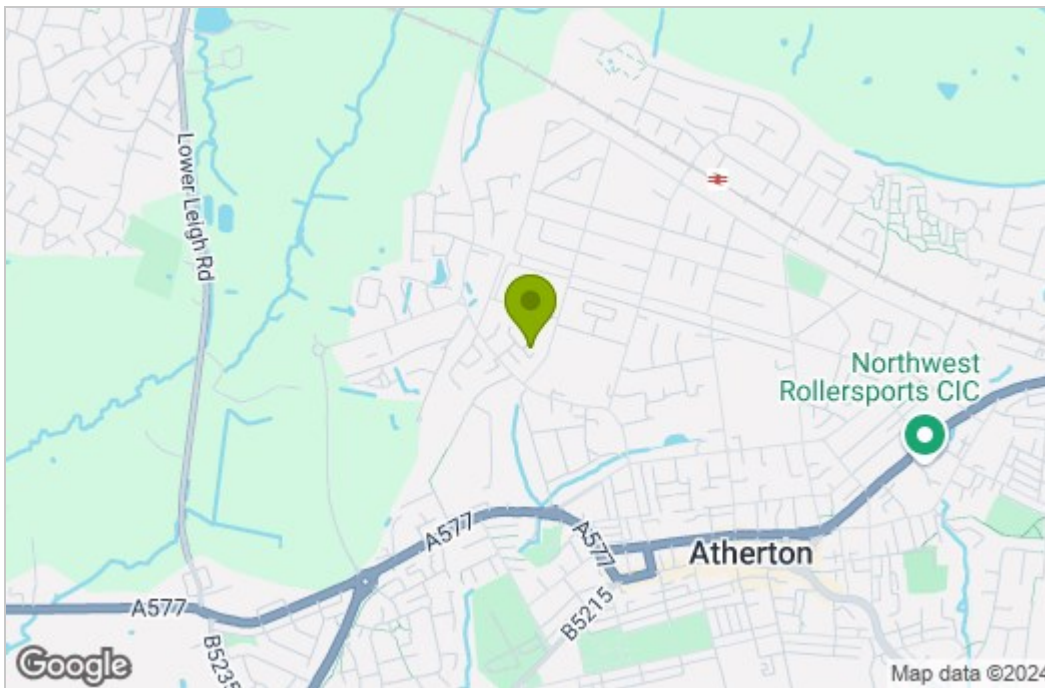

Energy Efficiency Graph

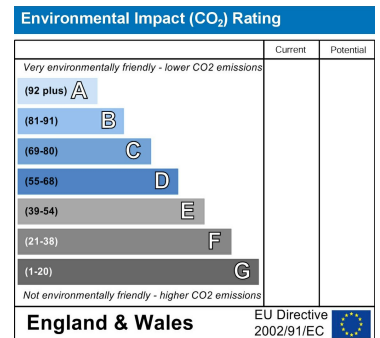
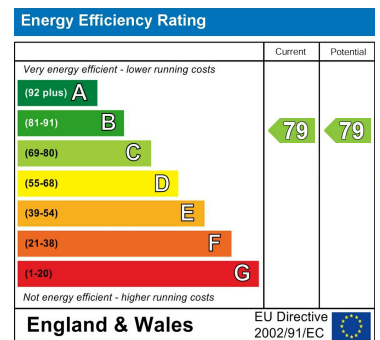

These particulars, whilst believed to be accurate are set out as a general outline only for guidance and do not constitute any part of an offer or contract. Intending purchasers should not rely on them as statements of representation of fact, but must satisfy themselves by inspection or otherwise as to their accuracy. No person in this firm's employment has the authority to make or give any representation or warranty in respect of the property.