

Sale Lane, Tyldesley, M29 8PZ
£179,950

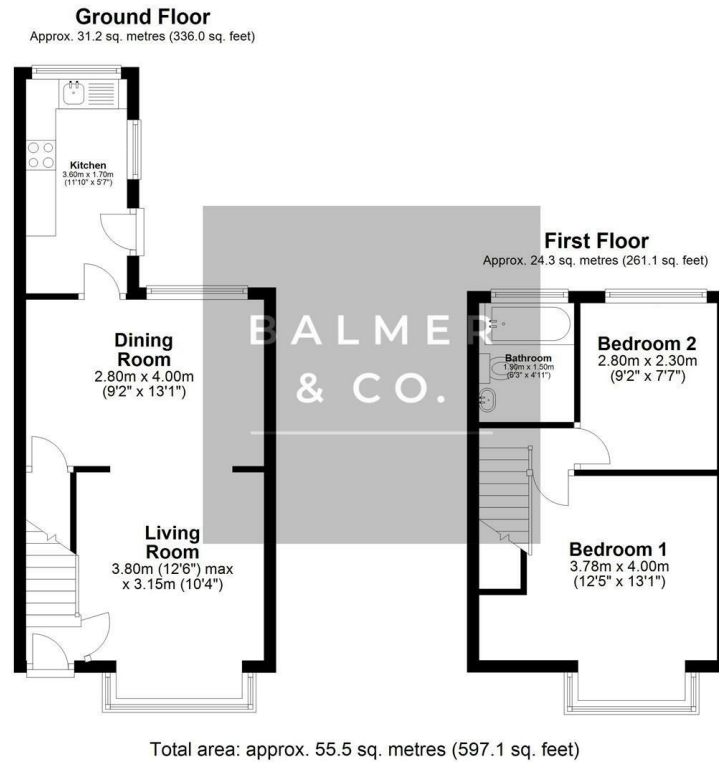

BALMER & CO are delighted to offer FOR SALE this fantastic two bedroom end-terrace house situated on the outskirts of Tyldesley, close to the Leigh to Manchester guided busway. Very nicely presented throughout and extended to the rear, this property comprises in brief of entrance hallway, bay fronted living room, dining room, with modern fitted kitchen to the rear completing the ground floor. To the first floor is a large master bedroom, second double bedroom and three piece family bathroom completing the accommodation on offer. Outside the property is garden fronted with a driveway providing off-road parking, whilst to the rear there is a large South facing garden with grass and decking areas, with a side gate providing access to the front. Early viewings highly recommended, all enquiries welcome.

Floor Plan



Area Map

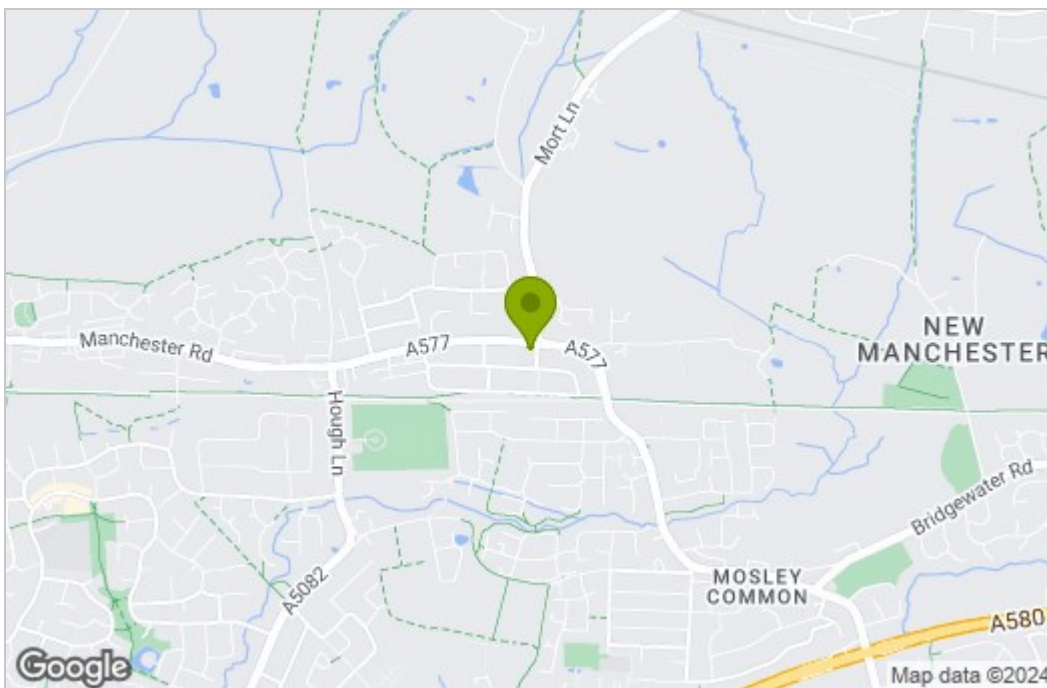

Energy Efficiency Graph

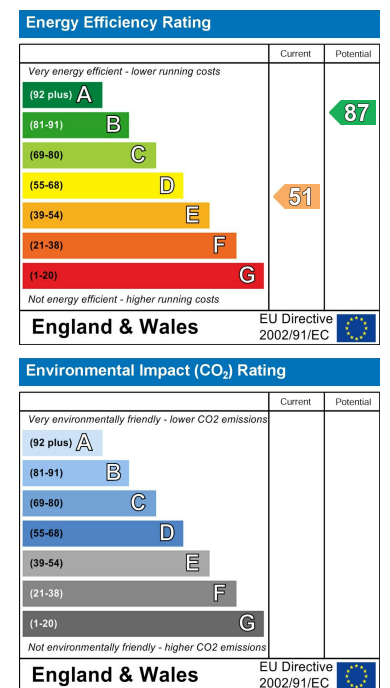

These particulars, whilst believed to be accurate are set out as a general outline only for guidance and do not constitute any part of an offer or contract. Intending purchasers should not rely on them as statements of representation of fact, but must satisfy themselves by inspection or otherwise as to their accuracy. No person in this firm's employment has the authority to make or give any representation or warranty in respect of the property.