

Bodmin Road, Tyldesley, M29 7PF  
Offers Over £325,000





BALMER & CO are delighted to offer FOR SALE this fantastic three bedroom detached bungalow on the ever popular Bodmin Road in Astley. Offered with no onward chain and very nicely presented throughout, this property comprises in brief of entrance hallway, large living room with feature fireplace and surround, modern fitted kitchen with integrated appliances, two well proportions double bedrooms, third single bedroom, with three piece family bathroom completing the accommodation on offer. outside the property occupies a generous plot with a garden frontage, long driveway and detached garage to the side providing ample off-road parking and storage, whilst to the rear there is a fully enclosed, private garden. Early viewings highly recommended, all enquiries welcome.

## Floor Plan

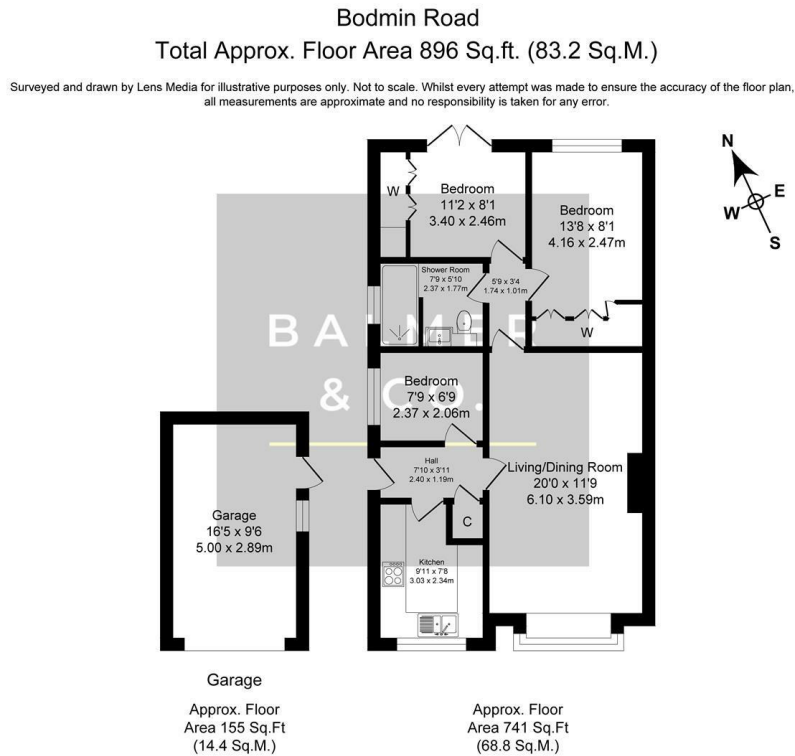

## Area Map

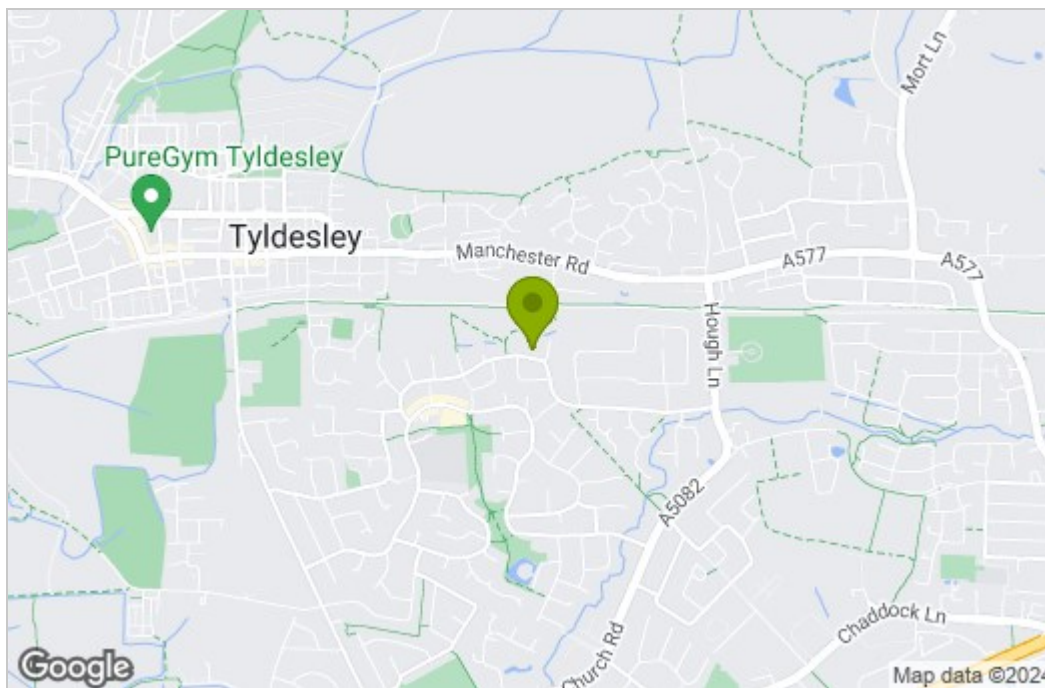

## Energy Efficiency Graph

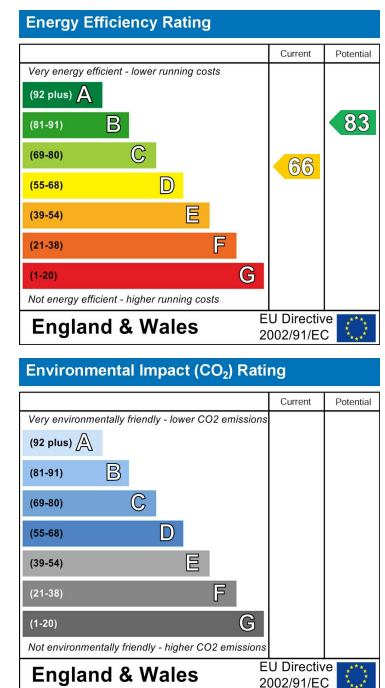

These particulars, whilst believed to be accurate are set out as a general outline only for guidance and do not constitute any part of an offer or contract. Intending purchasers should not rely on them as statements of representation of fact, but must satisfy themselves by inspection or otherwise as to their accuracy. No person in this firm's employment has the authority to make or give any representation or warranty in respect of the property.