

Garden Vale, Leigh, WN7 5SY
Offers Over £60,000



BALMER & CO are delighted to offer FOR SALE with no onward chain this fantastic one bedroom, first floor apartment in a popular and well regarded residential location on the outskirts of Leigh. Very well presented throughout, this property comprises in brief of communal and private entrance hallway, modern fitted kitchen with appliances, open plan living/dining room, large double bedroom, with three piece family bathroom completing the accommodation on offer. Outside are communal gardens and communal carpark, providing off road parking. Early viewings highly recommended, all enquires welcome.

Floor Plan

SECOND FLOOR
444 sq.ft. (41.3 sq.m.) approx.

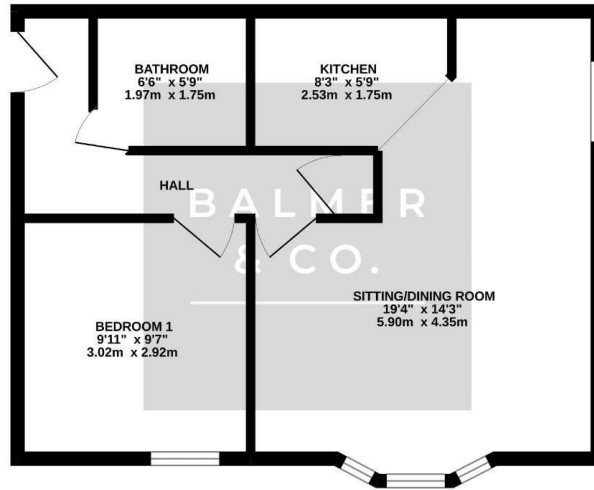

BALMER & CO.
SALES & LETTINGS

TOTAL FLOOR AREA: 444 sq.ft. (41.3 sq.m.) approx.
While every attempt has been made to ensure the accuracy of the floorplan contained herein, measurements of rooms, wall-to-wall, corners and any other details are approximate and no responsibility is taken for any error, omission or mis-statement. The plan is for illustrative purposes only and should be used as a guide only for prospective purchasers. The fixtures, fittings and appliances shown herein have not been tested and no guarantee is given for their operation or efficiency can be given.
Made with Metropix ©2022



Area Map

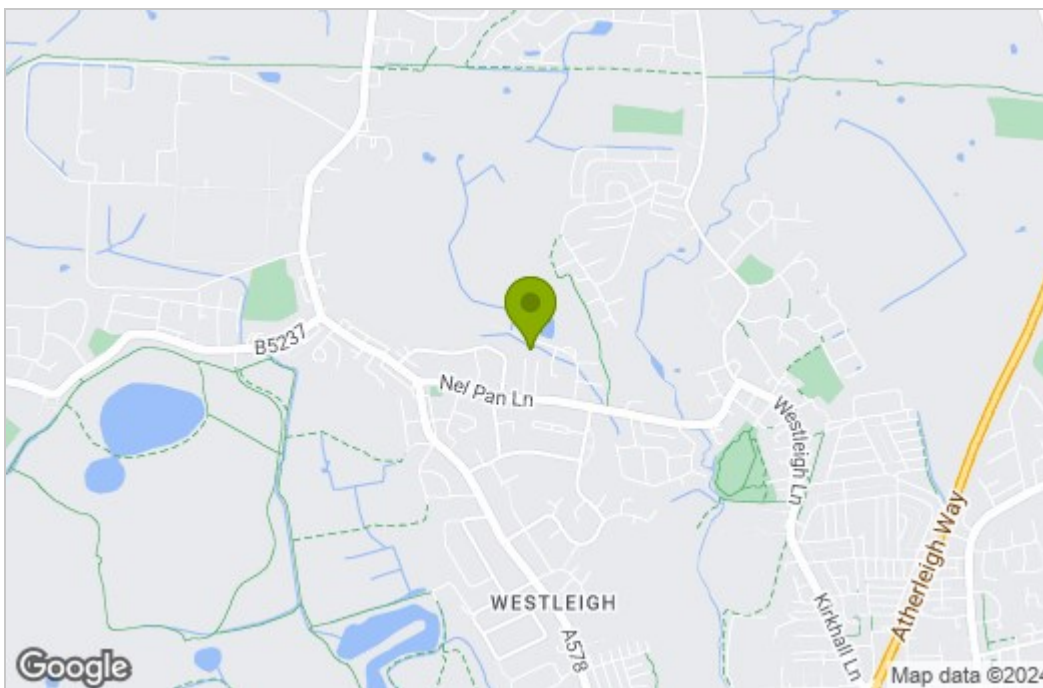

Energy Efficiency Graph

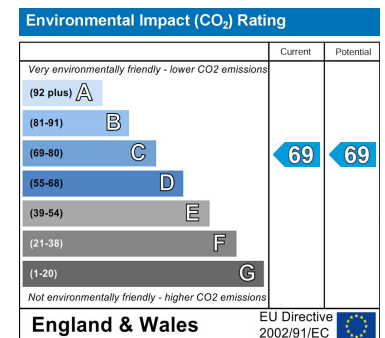
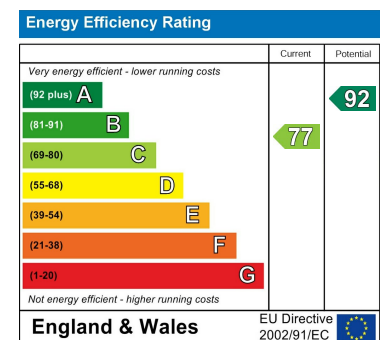

These particulars, whilst believed to be accurate are set out as a general outline only for guidance and do not constitute any part of an offer or contract. Intending purchasers should not rely on them as statements of representation of fact, but must satisfy themselves by inspection or otherwise as to their accuracy. No person in this firm's employment has the authority to make or give any representation or warranty in respect of the property.