







 1 Bedrooms |  1 Receptions |  1 Bathrooms |  EPC Current C

Helliwell & Co is delighted to introduce a unique, spacious, charming one-bedroom flat situated in a wonderful mansion block in a prime Olde Ealing location.

Set on the first floor and beautifully refurbished this property has an abundance of natural light and is offered to the market in excellent condition, having undergone a skilful renovation creating the perfect balance between contemporary and characterful.

Entering the flat, you are met with a lovely, airy south-west facing reception room with a feature fireplace, wood flooring and vast high ceilings. There is a new, modern kitchen which boasts excellent storage, gorgeous tiling and integrated appliances. The spacious double bedroom also endures the southwest-facing aspect with picturesque and tranquil treeline views. The traditional, fully tiled bathroom boasts a bathtub and power shower. Further benefits of this fantastic property include no onward chain, share of freehold, double-glazed sash windows, gas central heating, a secure entry phone system, manicured communal gardens, a double garage and off-street parking.

Ealing Court Mansions is located on one of Ealing's finest tree lined roads and is ideally placed for access to both Ealing Broadway (Elizabeth Line, Central Line, District Line & GWR) and South Ealing (Piccadilly Line) stations, as well as a selection of charming local cafes, pubs and restaurants. The open spaces of Lammas Park and Walpole Park are also within touching distance.

- Iconic Period Mansion Block
- Off Street Parking
- Double Garage
- Double Glazed Sash Windows
- Manicured Communal Gardens
- Olde Ealing
- No Onward Chain
- Tenure: Share of Freehold (999 years)
- Service Charge: £2,168pa
- Council Tax Band: D

EALING COURT MANSIONS

Approximate Gross Internal Area 774 sq ft / 71.90 sq m
(Included Garage)

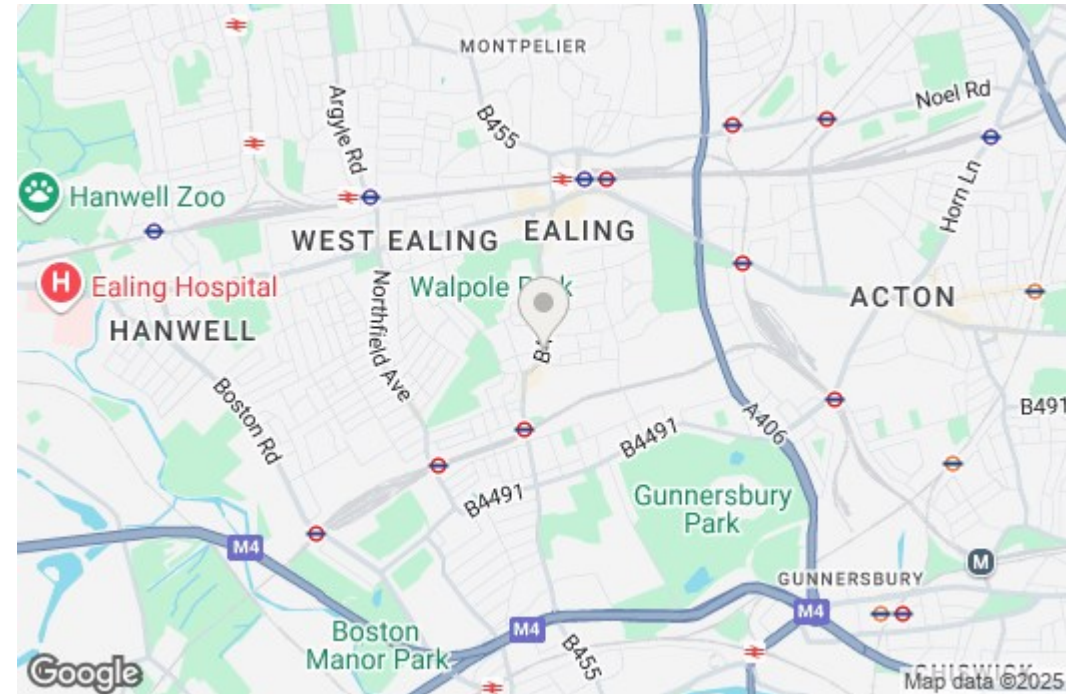
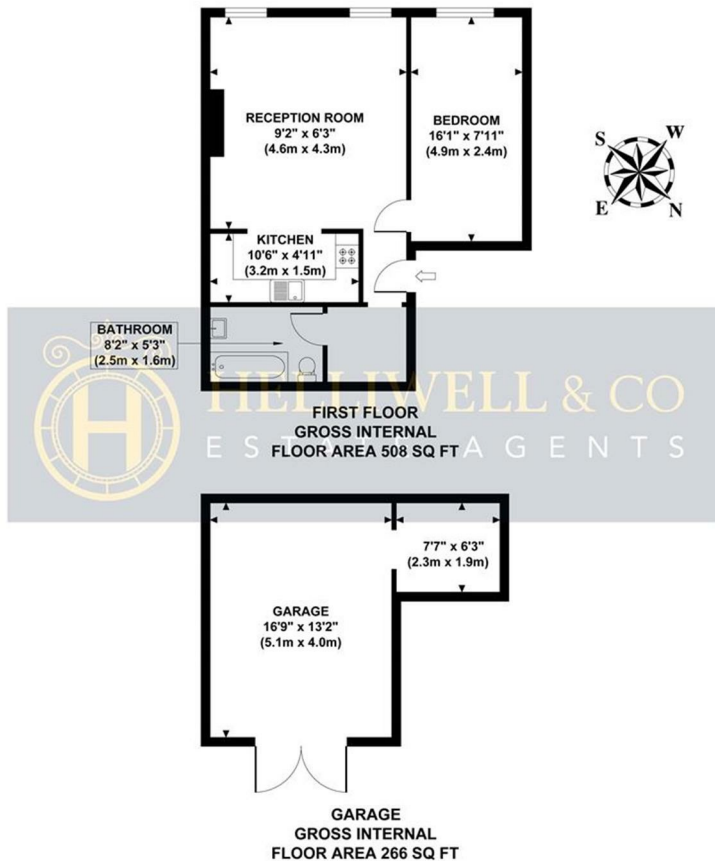

Although every attempt has been made to ensure accuracy,
all measurements are approximate and no responsibility is taken for any error, omission, or mid-statement.
This floor plan is for illustrative purposes only and not to scale. Measured in accordance to RICS standards.