







🛏️ 2 Bedrooms | 🛋️ 1 Receptions | 🚿 2 Bathrooms | 📊 EPC Current C

Helliwell and Co are proud to present this fantastic, bright and spacious flat which is offered to the market furnished and is available from mid-September. The property has a large open plan reception with space for dining and a modern kitchen featuring integrated appliances, two double bedrooms and two bathrooms equipped with bathtubs and power showers. Further benefits include ample storage space, one off street parking space, gas central heating and an attractive neutral décor throughout.

Woodville Road is ideally located for access to Ealing Broadway (Central and District line, mainline and future Crossrail) station as well as it's shopping centre and multiple cafes, restaurants and bars.

- First Floor Flat
- Bright Open Plan Living
- Off Street parking Space
- Holding Deposit (1 week): £576.00
- Council Tax Band: E
- Two Spacious Bedrooms
- Two Modern Bathrooms
- Ample Storage
- Security Deposit (5 weeks): £2,884.62
- Long Let (12-24 months+)

WOODVILLE ROAD, EALING, W5

TOTAL AREA: APPROX. 62.7 SQ. METRES (674.6 SQ. FEET)

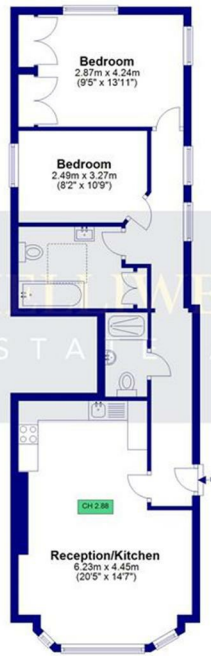

First Floor
Approx. 62.7 sq. metres (674.6 sq. feet)



Although every attempt has been made to ensure accuracy, all measurements are approximate and no responsibility is taken for any error, omission, or mid-statement. This floor plan is for illustrative purposes only and not to scale. Measured in accordance to RICS standards