



HELLIWELL & CO  
ESTATE AGENTS

Thames Quay, Chelsea Harbour, SW10

£3,500 Per Calendar Month





 2 Bedrooms |  1 Receptions |  1 Bathrooms |  EPC Current D

Helliwell & Co are proud to present a stunning luxury flat which is situated atop the enviable Chelsea Harbour, overlooking the River Thames. It comprises two bedrooms – one large double and one single – awash with natural light, a modern standalone kitchen with fully integrated appliances, a double spec reception room with a dining area and living room, and patio doors opening to a large private terrace with a breath-taking view of the river. The stylish slate tiled bathroom boasts a separate walk-in shower in addition to a jacuzzi bath, while the building includes a professional concierge service with a porter, and secure off-street parking. The property is offered to the market furnished, and is available to rent now.

Chelsea Harbour overlooks a private marina with direct access to the Thames. The Thames Quay development is moments from an impressive array of the shops, bars and restaurants of the prestigious King's Road and The Boulevard. Motorists have immediate access to the A4/M4 links to central London and the West.

- Luxury Two Bedroom Apartment
- Separate Kitchen & Reception
- Furnished
- Council Tax Band: G
- Security Deposit: £4,038.46
- Stylish Bathroom & Jacuzzi
- Private Terrace with Thames View
- Professional Concierge
- Holding Deposit: £807.00
- Available Now

**THAMES QUAY, CHELSEA HARBOUR**

Approximate Gross Internal Area  
688 sq ft / 63.92 sq m

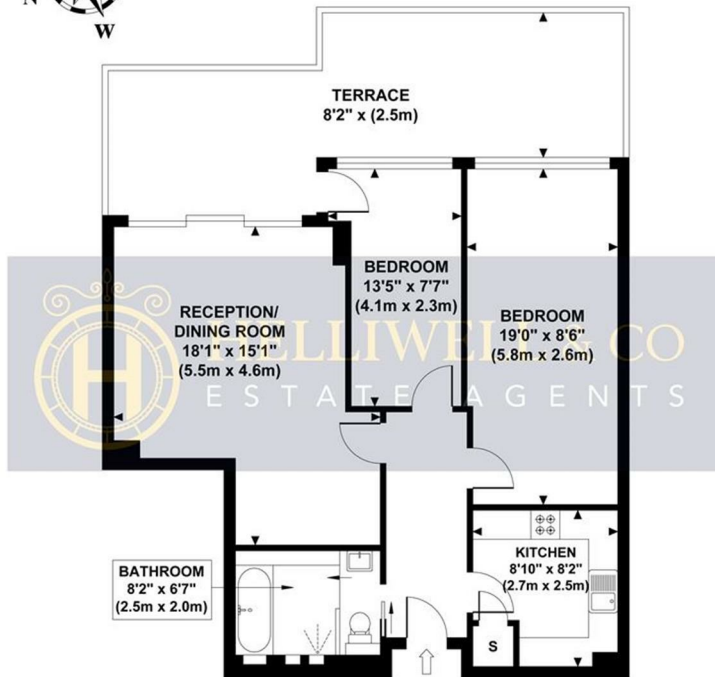

UPPER GROUND FLOOR  
GROSS INTERNAL  
FLOOR AREA 688 SQ FT

Although every attempt has been made to ensure accuracy,  
all measurements are approximate and no responsibility is taken for any error, omission, or mid-statement.  
This floor plan is for illustrative purposes only and not to scale. Measured in accordance to RICS standards.

