



**HELLIWELL & CO**  
ESTATE AGENTS

**The Green, Ealing, W5**  
**Guide Price £450,000**





 2 Bedrooms |  1 Receptions |  1 Bathrooms |  EPC Current C

Helliwell & Co is proud to present a rare opportunity to acquire this spacious two-bedroom apartment in the heart of Ealing Broadway, with fabulous views across Ealing Green.

This unique first floor apartment comprises two double bedrooms, contemporary bathroom, separate kitchen and a generous sitting room with french doors leading directly onto the large, south-facing terrace boasting open views of Pitzhanger Manor. Further benefits include private entrance, ample storage, residents permit parking, a 141 years long lease and low service charge of £1,586.68pa

The Green is a wonderful location, moments from a variety of cafes, bars and restaurants, as well as Ealing Broadway's central shopping area. It is ideally located for access to the A406 and Ealing Broadway station. (Central and District lines, mainline and Elizabeth Line).

- Two Bedroom Flat
- Heart of Ealing Broadway
- Fantastic Transport links
- Tenure: Leasehold 141 Years
- Ground Rent: £100.00pa
- Vast Private Terrace
- Fabulous Views
- No Onward Chain
- Service Charge: £1,586.68pa
- Council Tax Band: D

## THE GREEN

Approximate Gross Internal Area  
526 sq ft / 48.90 sq m

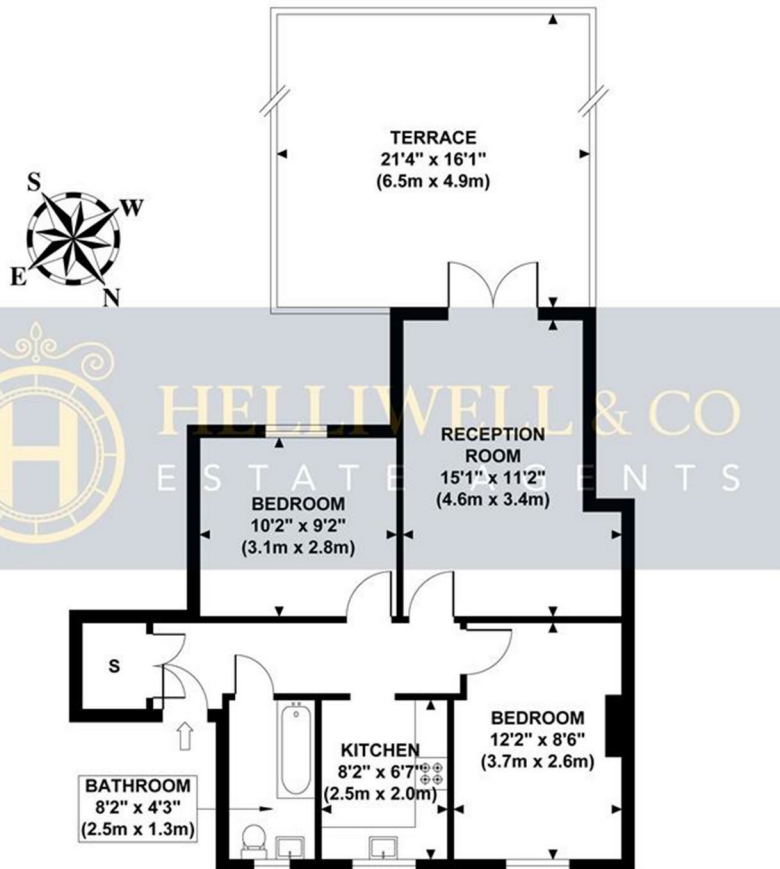

**GROSS INTERNAL  
FLOOR AREA 526 SQ FT**

Although every attempt has been made to ensure accuracy, all measurements are approximate and no responsibility is taken for any error, omission, or mid-statement. This floor plan is for illustrative purposes only and not to scale. Measured in accordance to RICS standards.

