



HELLIWELL & CO
ESTATE AGENTS

Argyle Road, St Stephens, Ealing, W13

Guide Price £1,590,000





 5 Bedrooms |  3 Receptions |  2 Bathrooms |  EPC Current E

Helliwell & Co is proud to exclusively present this comfortable, attractive, detached family home, situated within one of Ealing's most desirable pockets.

This wonderful house has been painstakingly restored to reflect its history, and offers a new family opportunity to make it their own and extend (STPP) - helpfully the part-boarded loft has the boiler, electrics & heating in situ for a potentially huge loft extension. With its Master Craftsmen English Heritage restored architecture, this spectacular offering boasts a wealth of period charm and character, and briefly comprises three generous reception rooms with original wooden flooring, large windows allowing natural light to pour in, impressive high ceilings, feature fireplace, a lovely Tuscan kitchen linked to the dining room and with useful access to the side passage, downstairs shower & utility room, three generous bedrooms, two additional bedrooms perfect for a home office, walk-in wardrobe or nursery, modern family bathroom with high-quality Italian tiling, and a beautiful secluded garden which is barely overlooked, benefitting from sun throughout the day.

Argyle Road is a highly sought-after, tree-lined street in the St Stephen's pocket of Ealing, moments from a variety of schools, all enjoying exemplary reputations, and benefitting from easy access to West Ealing Station (Elizabeth Line & GWR) and Ealing Broadway (Elizabeth Line, Central Line, District Line & GWR) as well as the abundance of parks, boutiques, cafes and restaurants on offer in central Ealing and the award-winning Pitshanger Village.

- Beautiful Detached House
- Imposing Period Architecture
- Wonderful Private Garden
- Sought-After Tree-Lined Street
- Extension Potential (STPP)
- Generous Driveway for Several Cars
- Leafy St Stephen's Area
- Tenure: Freehold

ARGYLE ROAD

Approximate Gross Internal Area

2061 sq ft / 191.48 sq m

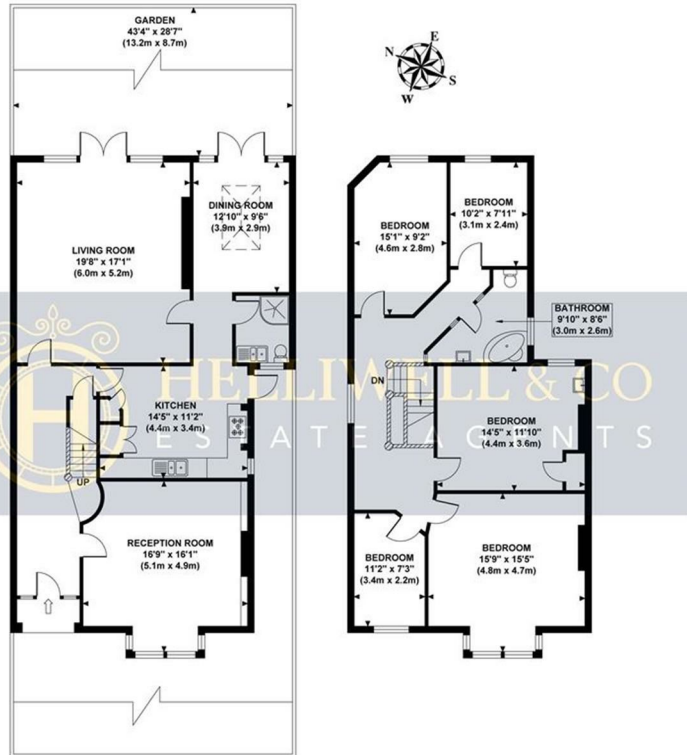

**GROUND FLOOR
GROSS INTERNAL
FLOOR AREA 1128 SQ FT**

**FIRST FLOOR
GROSS INTERNAL
FLOOR AREA 933 SQ FT**

Although every attempt has been made to ensure accuracy, all measurements are approximate and no responsibility is taken for any error, omission, or mid-statement. This floor plan is for illustrative purposes only and not to scale. Measured in accordance to RICS standards.

