

Need a Mortgage in principle
to make offers? Call us now
for quick assistance!
0121 775 0101

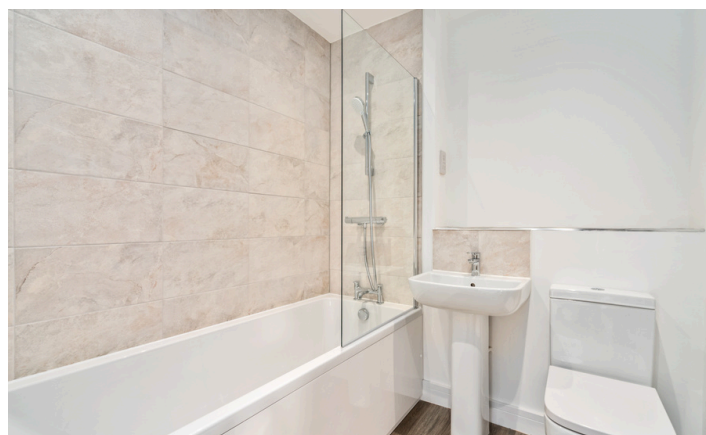

Do you need to sell?
Start your journey now!
Call us we can help.
0121 775 0101



SCAN FOR MORE INFO
SIZE - 906 Sq Ft
TENURE - Freehold
COUNCIL TAX - Solihull MBC - TBC
BROADBAND - TBC
MOBILE - TBC
EPC - A - 93
PARKING - For at least 2 Cars
FLOODRISK - Very Low
SERVICES - Mains
COVENANTS - N/A

OLTON COURT

Offers in the region of £340,000

Discover this stunning three bedroom new build semi-detached home in Olton Court, offering solar panels, EV charging and a secure gated community. Ideal for modern families, this property boasts a south/west facing garden and two allocated parking spaces.

FEATURES

- New Build Sem-Detached
- Three Bedrooms
- Lounge/Dining Room
- Fitted Kitchen
- En-Suite to Principal Bedroom
- Family Bathroom
- South West Facing Garden
- Gated Development
- Solar Panels
- 10 Year ICW Build Warranty

Are you an investor
interested in expanding your
portfolio?

Call **0121 775 0101** to provide your
investment criteria for alerts.



SCAN TO VIEW OUR
WEEKLY FILMS &
SUBSCRIBE

Sneak Peeks

Every week, we unveil "Sneak Peeks," a feature showcasing exclusive properties before they hit Rightmove and other platforms.

The Landlord Club

Join our Landlord Club for weekly updates on legislation, market trends, and our Letting Director's 'Investment Pick of the Week' for optimal ROI.

HTSPMD

Tune into 'How's The Solihull Property Market Dom' weekly for a quick, insightful snapshot of the market.

The Mortgage Update

Get weekly insights and the best deals with our Mortgage Update, your shortcut to navigating the complex mortgage landscape confidently.

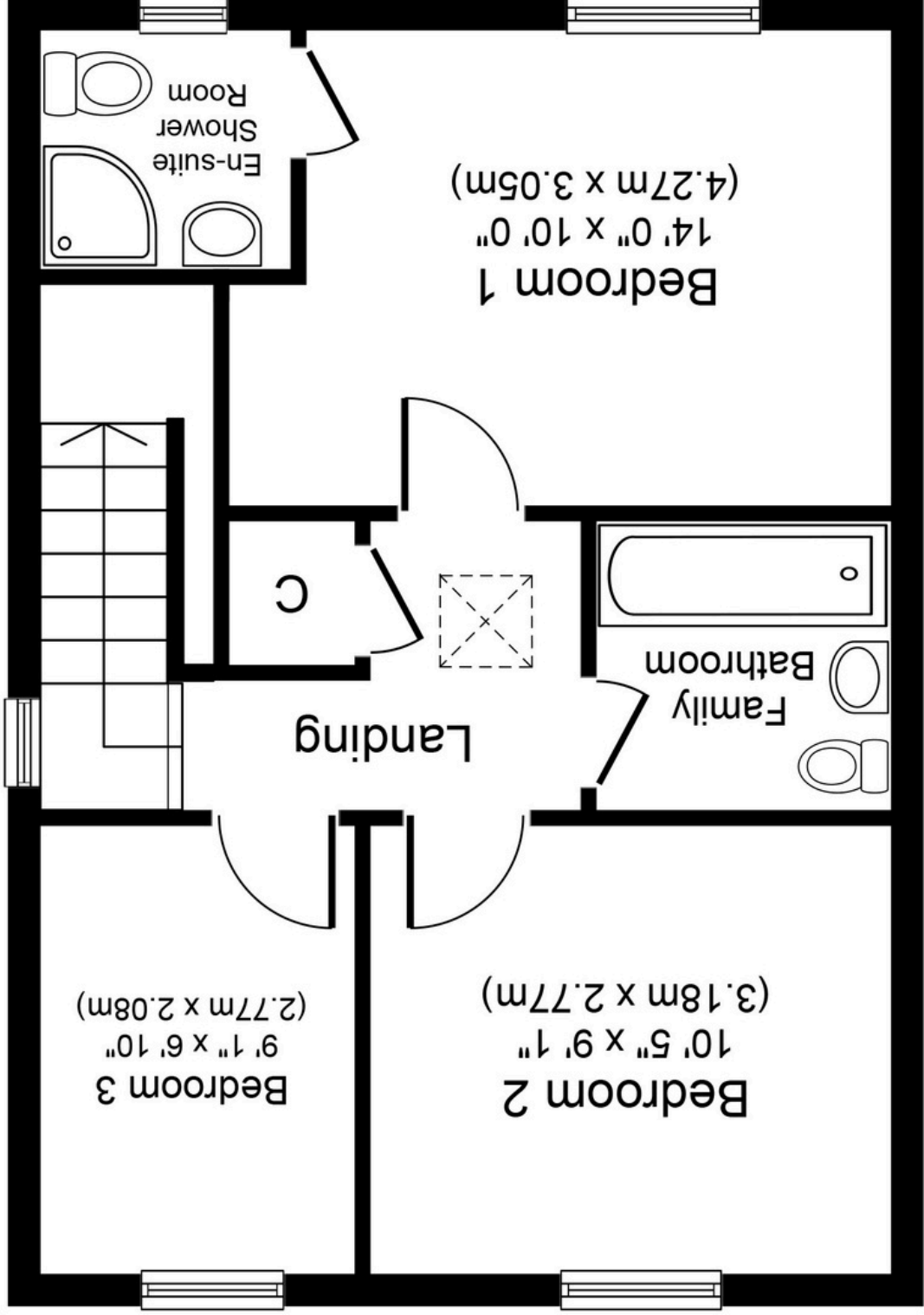
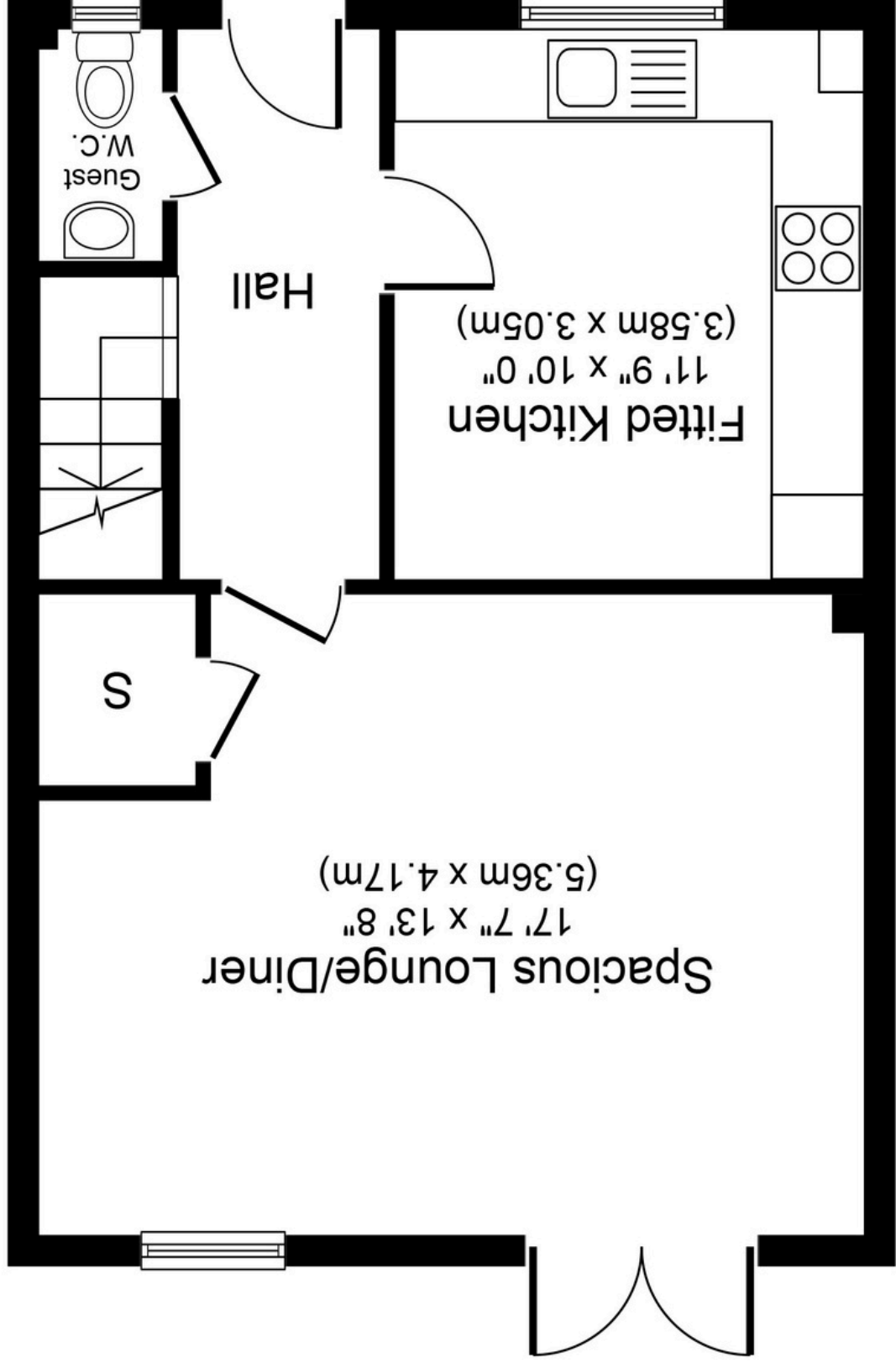

Whilst every attempt has been made to ensure the accuracy of the floor plan contained here, measurements of doors, windows, rooms and any other items are approximate and no responsibility is taken for any error, omission, or mis-statement. The measurements should not be relied upon for valuation, transaction and/or funding purposes. This plan is for illustrative purposes only and should be used as such by any prospective purchaser or tenant. The services, systems and appliances shown have not been tested and no guarantee as to their operability or efficiency can be given.

Copyright V360 Ltd 2023 | www.houseviz.com