



arthur grace  
RESIDENTIAL



Layers Close, Gerrards Cross, SL9 9HT  
Guide Price £435,000





## Floor Plan

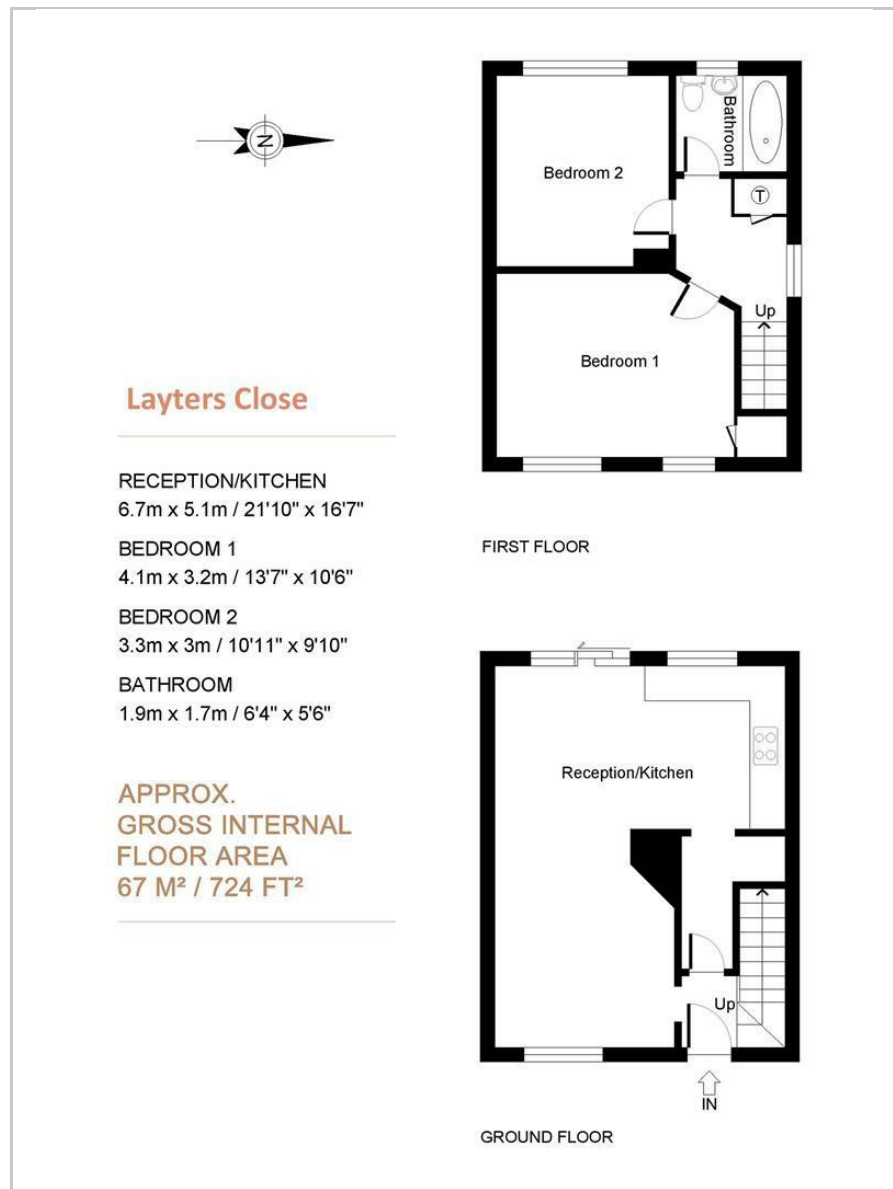

## Accommodation

- Semi detached home
- \*\* Potential for you to put your own stamp on it \*\*
- 2 double bedrooms
- Lounge to semi open plan kitchen
- Modern bathroom
- Off street parking & garage
- Potential to extend STPP
- 724 sq ft
- Council Tax Band D
- EPC F



These particulars, whilst believed to be accurate are set out as a general outline only for guidance and do not constitute any part of an offer or contract. Intending purchasers should not rely on them as statements of representation of fact, but must satisfy themselves by inspection or otherwise as to their accuracy. No person in this firm's employment has the authority to make or give any representation or warranty in respect of the property.