



arthur grace  
RESIDENTIAL



Breedon Drive, Aylesbury, HP18 0FY  
£1,850 Per Month





## Floor Plan

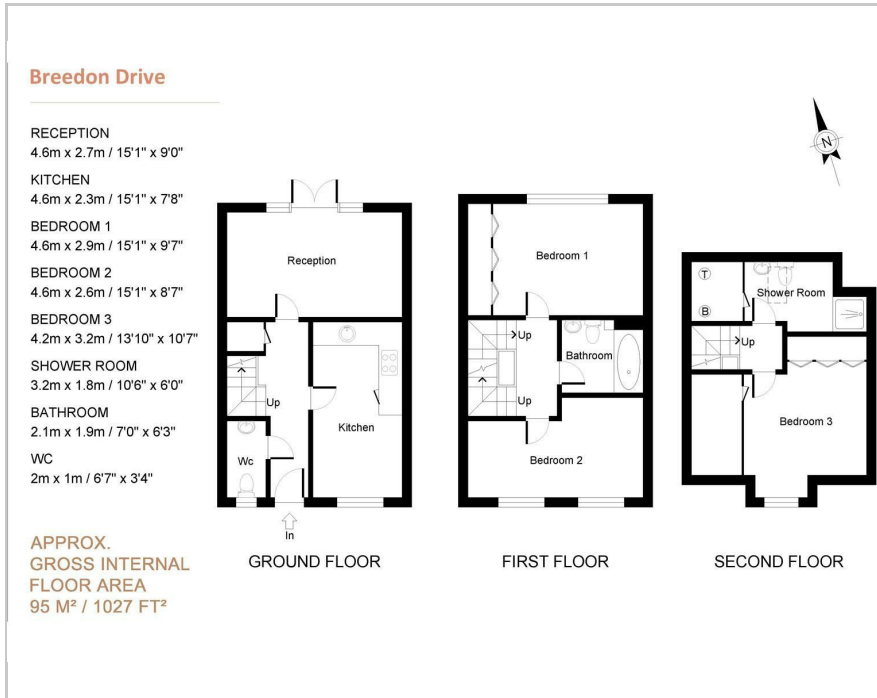

## Accommodation

- Modern 3 bedroom 2 bathroom semi detached
- \*\* Entirely redecorated & re-carpetted \*\*
- Separate Lounge & Eat in Kitchen
- Off street parking for 2 cars (no further parking restrictions)
- 1027 sq ft
- Set within the popular Berryfields, Aylesbury location
- Unfurnished (kitchen appliances included)
- Available now
- Council Tax. Band D - £2374.00
- EPC B



## Area Map



## Viewing

Please contact our Arthur Grace Residential Office on 01753 628700 if you wish to arrange a viewing appointment for this property or require further information.

## Energy Efficiency Graph

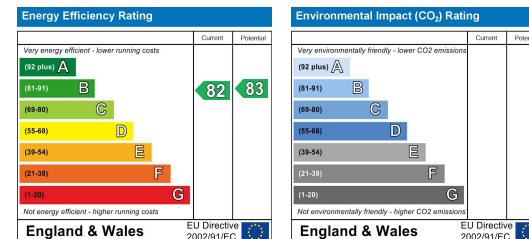

These particulars, whilst believed to be accurate are set out as a general outline only for guidance and do not constitute any part of an offer or contract. Intending purchasers should not rely on them as statements of representation of fact, but must satisfy themselves by inspection or otherwise as to their accuracy. No person in this firm's employment has the authority to make or give any representation or warranty in respect of the property.

The Nook Grove Lane Chalfont St Peter, Buckinghamshire, SL9 9JU  
Tel: 01753 628700 Email: [enquiries@arthurgraceresidential.com](mailto:enquiries@arthurgraceresidential.com) <https://www.arthurgraceresidential.com>