



arthur grace
RESIDENTIAL



Bellfield Road, High Wycombe, HP13 5HW
£1,650 Per Month



Floor Plan

Buckingham Place

RECEPTION / KITCHEN
6.5m x 5.5m / 21'3" x 17'11"

BEDROOM 1
4.6m x 2.8m / 15'0" x 9'2"

BEDROOM 2
4.6m x 2.7m / 15'0" x 9'0"

SHOWER ROOM
2.4m x 1.7m / 7'10" x 5'7"

APPROX.
GROSS INTERNAL
FLOOR AREA
65 M² / 704 FT²

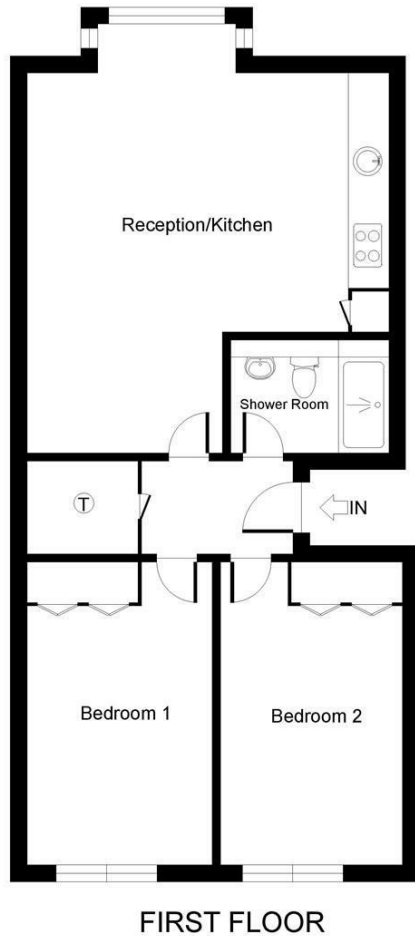

Accommodation

- Stunning apartment with parking for 2 cars
- 2 bedroom apartment
- Open plan modern kitchen to lounge
- Sleek hardfloors & luxurious carpets
- 2 spacious double bedrooms with fitted wardrobes
- Situated on the first floor
- Available from 7th June 2024
- Unfurnished (appliances and fitted wardrobe included)
- Council Tax, Band C
- EPC C



These particulars, whilst believed to be accurate are set out as a general outline only for guidance and do not constitute any part of an offer or contract. Intending purchasers should not rely on them as statements of representation of fact, but must satisfy themselves by inspection or otherwise as to their accuracy. No person in this firm's employment has the authority to make or give any representation or warranty in respect of the property.

The Nook Grove Lane Chalfont St Peter, Buckinghamshire, SL9 9JU
Tel: 01753 628700 Email: enquiries@arthurgraceresidential.com <https://www.arthurgraceresidential.com>