

FLAT 14 KEYNSHAM BANK, CHELTENHAM, CHELTENHAM, GL52 6ER

£1,150 PCM

CHELTENHAM BOROUGH COUNCIL B

Ground Floor

Approx. 51.6 sq. metres (554.9 sq. feet)

14 Keynsham Bank, GL52 6ER

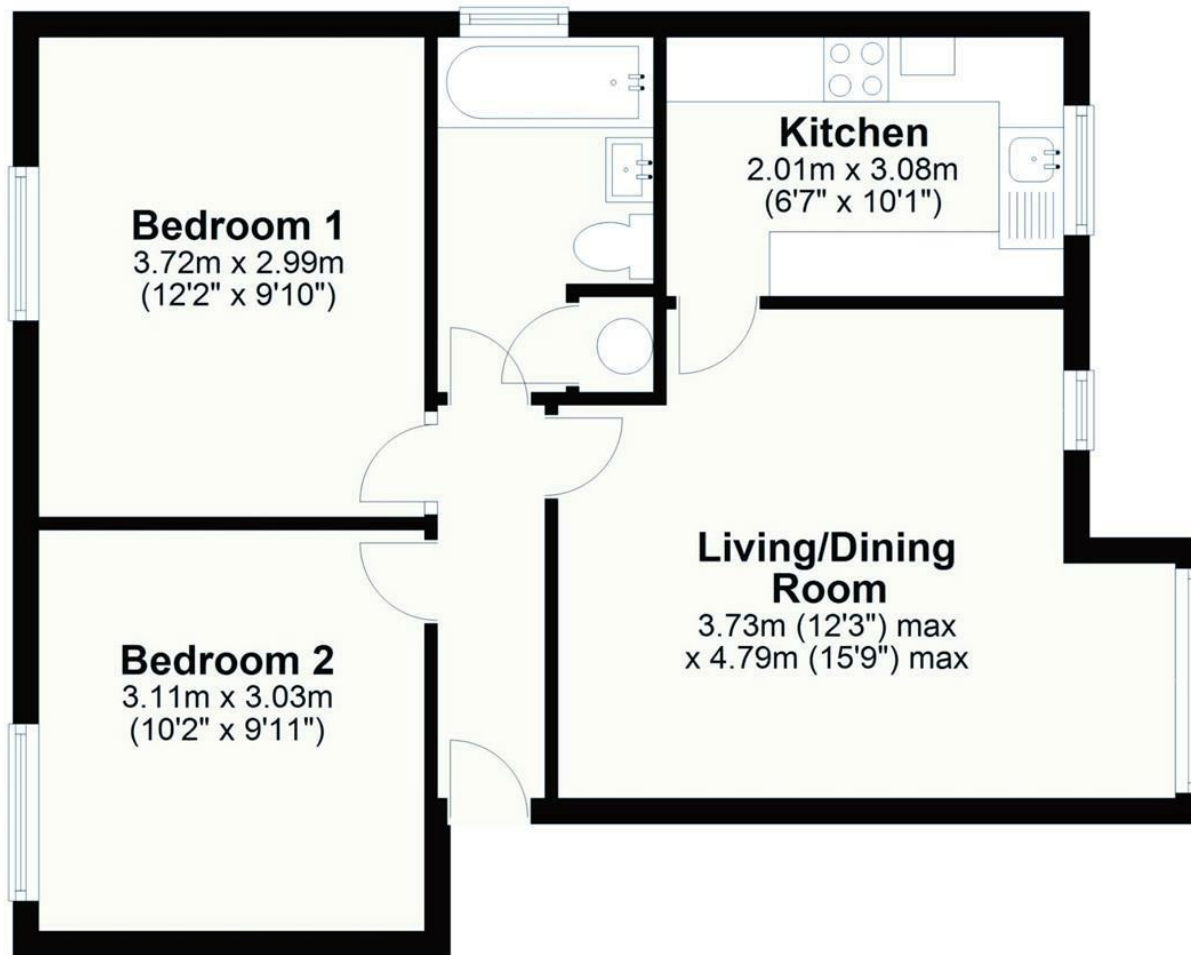

Total area: approx. 51.6 sq. metres (554.9 sq. feet)

Floorplan for Guidance only - Not to Scale





PCM £1,150 PCM

**** IN THE FIRST INSTANCE PLEASE EMAIL YOUR ENQUIRY**** A two double bedroom ground floor apartment in a cul-de-sac off the London Road. The property is within walking distance to the Town Centre, Cheltenham General Hospital and Sandford Park.

The accommodation is gas centrally heated and offers entrance hall, living room/dining room, modern fitted kitchen, two double bedrooms, and modern bathroom with shower over bath. Also with double glazing and one un-allocated parking space. The property is available for March 2024 and some furniture is available if required.



Energy Efficiency Rating		
	Current	Potential
Very energy efficient - lower running costs		
(92 plus) A		
(81-91) B		
(69-80) C	69	75
(55-68) D		
(39-54) E		
(21-38) F		
(1-20) G		
Not energy efficient - higher running costs		
England & Wales	EU Directive 2002/91/EC	

Sure Property Group
 23 Bath Street, Cheltenham
 GL50 1YA
 01242 241200
info@surecheltenham.co.uk

Cheltenham Borough Council
 COUNCIL TAX BAND B