

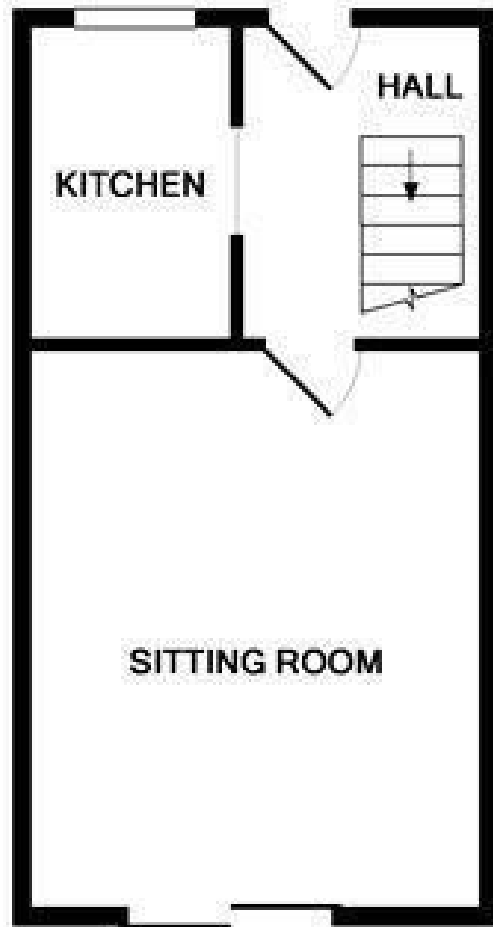

**12 STANCOMBE GROVE
UP HATHERLEY
CHELTENHAM
GL51 3FD**

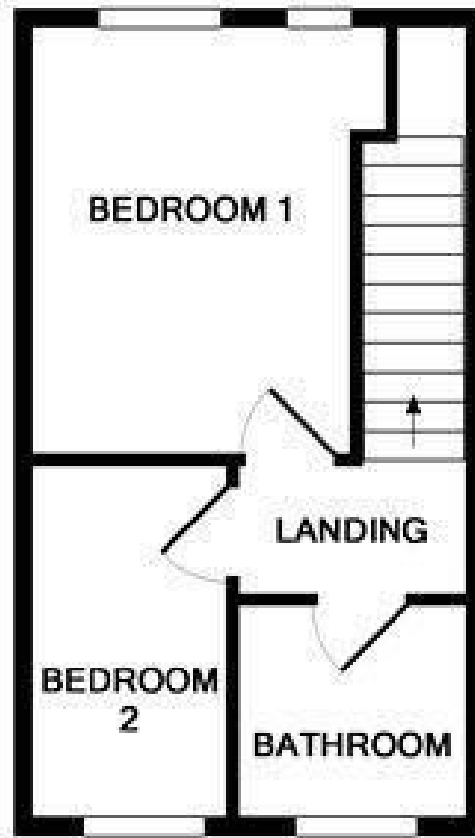

GROUND FLOOR



1ST FLOOR

12 STANCOMBE GROVE





Per Calendar Month

£1,150 Per Calendar

PLEASE EMAIL YOUR REQUEST IN THE FIRST INSTANCE - Well presented, delightful terraced house in Up Hatherley, which consists of: entrance hall, fitted kitchen with electric cooker, gas hob, extractor hood, living room with patio doors leading to rear garden, TWO BEDROOMS and a family bathroom with shower over bath. This property further benefits from having gas central heating, double glazing, a garden shed and two parking spaces.

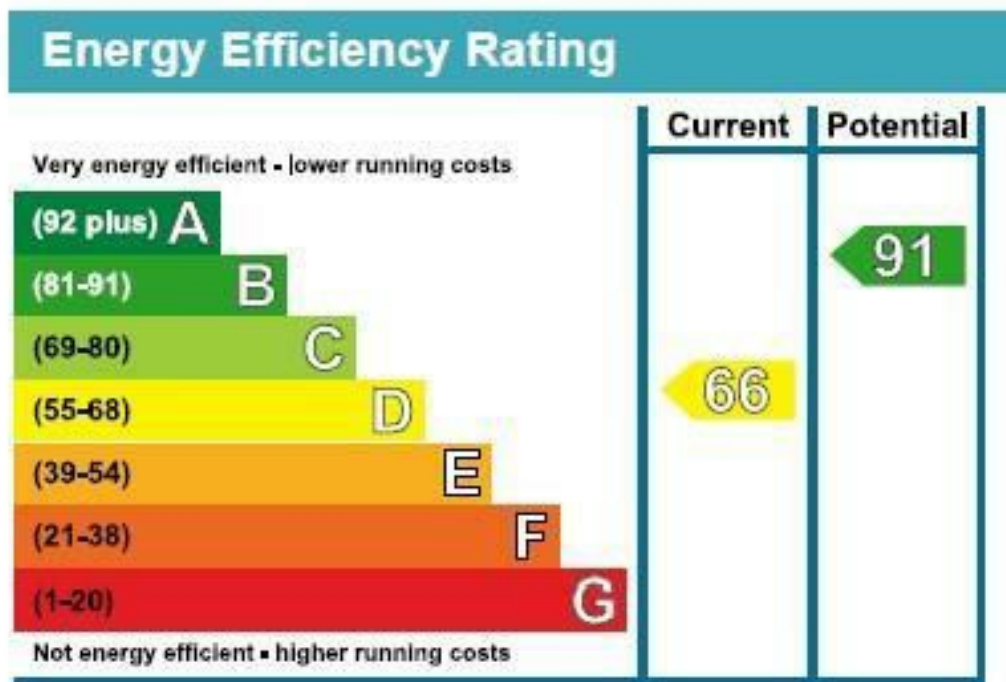

Local Authority

Gloucestershire

Council Tax

Band: B
Annual Price: £1,756

Conservation Area ?

No

Flood Risk

Very low

Floor Area

452 ft² / 42 m²

Plot Size

0.03 Acres (2 Plots)

Mobile Coverage

EE ●
Vodafone ●
Three ●
O2 ●

Broadband

Basic 14 Mbps
Superfast 75 Mbps
Ultrafast 10000 Mbps

Satellite / Fibre TV Availability

BT ✓
Sky ✓
Virgin ✓



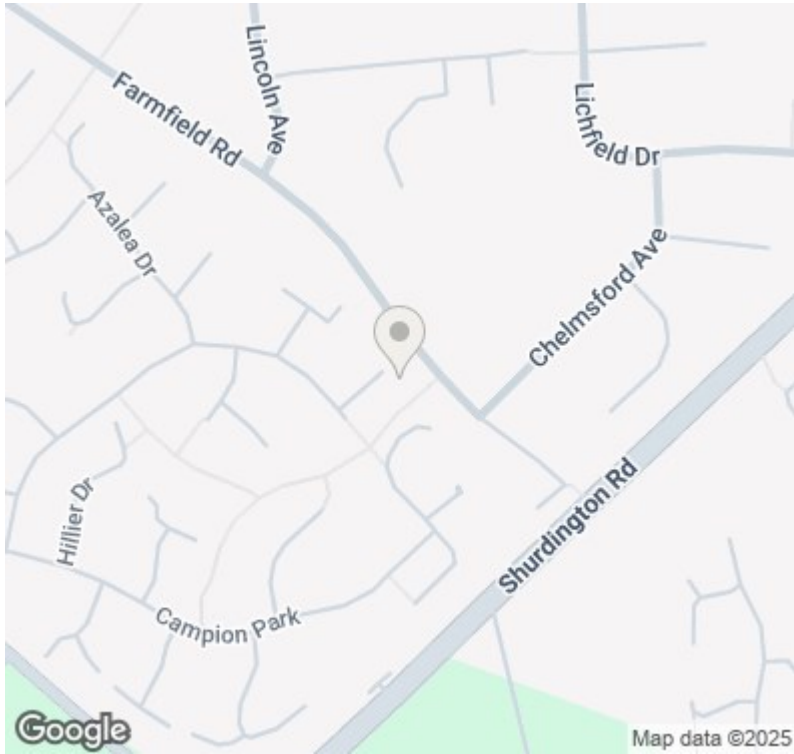

| Energy Efficiency Rating | | |
|--|-----------|-----------|
| | Current | Potential |
| Very energy efficient - lower running costs | | |
| (92 plus) A | | 91 |
| (81-91) B | | |
| (69-80) C | 66 | |
| (55-68) D | | |
| (39-54) E | | |
| (21-38) F | | |
| (1-20) G | | |
| Not energy efficient - higher running costs | | |
| England & Wales EU Directive 2002/91/EC  | | |

Sure Property Group
 23 Bath Street
 Cheltenham
 Gloucestershire
 GL50 1YA
 01242 261222/ 241200
info@surecheltenham.co.uk

Cheltenham Borough Council
 COUNCIL TAX BAND B