



6 Blossom Gate Drive,  
Congleton, CW12 4ZR



STEPHENSON BROWNE





STEPHENSON BROWNE

£1,300 Per Month



**Introducing a property that is sat proudly within a stunning residential development, this lovely three bed property is in immaculate accommodation across both floors offering a large lounge, a guest cloakroom and lovely spacious kitchen/dining area that opens into the rear garden. The house has two double bedrooms, one single bedroom with the master having an en-suite and a family bathroom. Outside has a useful driveway for two cars. The property itself enjoys gorgeous views over a village green and pond. Location within local amenities and superb for commuter links. No cats or dogs.**





- **3- Bed Semi Detached**
- **Spacious Kitchen/Diner**
- **Close to Transport Links**
- **Viewing Essential**

- **Immaculate Throughout**
- **Overlooks Fabulous Pond**
- **Established Estate**

View all of our properties at [www.stephensonbrowne.co.uk](http://www.stephensonbrowne.co.uk)





STEPHENSON BROWNE

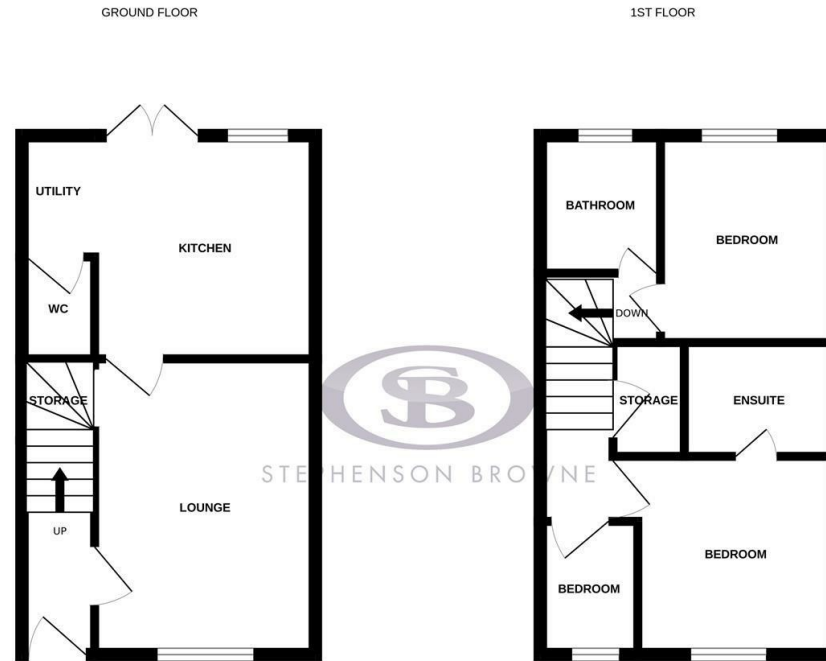

Whilst every attempt has been made to ensure the accuracy of the floorplan contained here, measurements of doors, windows, rooms and any other items are approximate and no responsibility is taken for any error, omission or mis-statement. This plan is for illustrative purposes only and should be used as such by any prospective purchaser. The services, systems and appliances shown have not been tested and no guarantee as to their operability or efficiency can be given.  
Made with Metropix ©2024

21 High Street, Congleton, CW12 1BH Tel: 01260 545600  
View all of our properties at [www.stephensonbrowne.co.uk](http://www.stephensonbrowne.co.uk)

**NOT TO SCALE** These floor plans are given as a guide only. Full completed measurements and details should be verified by any intending purchasers legal representative.

NOTICE: Stephenson Browne for themselves and for the vendors or lessors of this property whose agents they are give notice that: (1)the particulars are set out as a general guideline only for the guidance of intending purchasers or lessees, and do not constitute, nor constitute part of, an offer or contract; (2)all descriptions, dimensions, references to condition and necessary permissions for use and occupation, and other details are given in good faith and are believed to be correct but any intending purchasers or tenants should not rely on them as statements or representations of fact but must satisfy themselves by inspection or otherwise as to the correctness of each theme; (3)no person in the employment of Stephenson Browne has any authority to make representation or warranty whatever in relation to this property. (4)fixtures & fittings are subject to a formal list supplied by vendors solicitors. **Referring to:** Move with Us Ltd **Average Fee:**£123.64

