

## 91 Wydeville Manor Road

Guide Price £240,000

🛏 1 🚿 1 🚗 1



- Close To Grove Park Station
- Close To Local Amenities
- Double Bedroom with Generously Sized Storage
- Seperate FullyFitted Kitchen
- Charming One Bedroom Ground Floor Apartment
- Communal Garden Access
- Ample Storage Throughout
- Spacious Reception Room
- Perfect First Time Purchase
- Private Front Garden



GROUND FLOOR

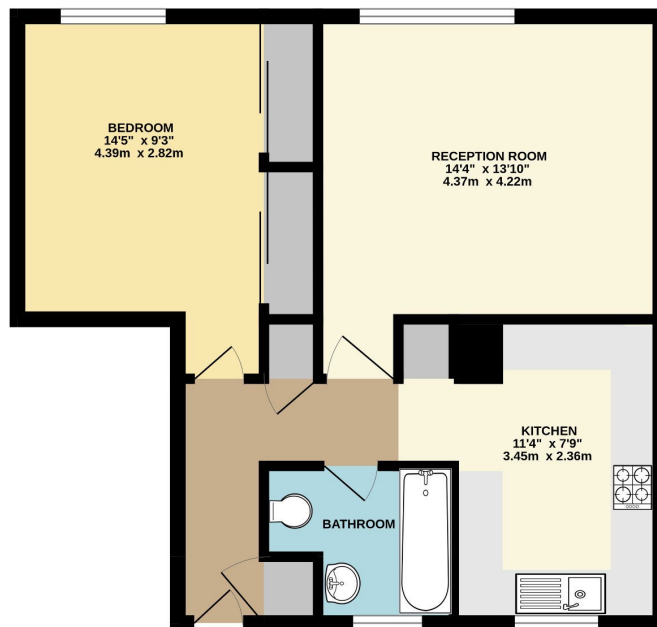

TOTAL FLOOR AREA: 526sq. ft. (48.9 sq.m.) approx.  
Whilst every attempt has been made to ensure the accuracy of the floorplan contained here, measurements of doors, windows, rooms and any other items are approximate and no responsibility is taken for any error, omission or misstatement. This plan is for illustrative purposes only and should be used as such by any prospective purchaser. The services, systems and appliances shown have not been tested and no guarantee as to their operability or efficiency can be given.  
Made with Metropix ©2024

Hauzoo is excited to present this spacious one-bedroom, ground floor apartment in the Grove Park area of Lewisham, South East London. Situated on a quiet crescent within a secure residential building, the property benefits from, excellent local bus routes, and nearby road links to the A205 and A20.