

## Lambeth, London, SW9 7LU

Guide Price £550,000

🛏 2 🚿 1 🚗 1



- Spacious Two Bedroom Ground Floor Flat
- Large Reception Room
- Separate Kitchen
- Two Double Bedrooms
- High Ceilings
- Enormous Rear Garden
- Close To Transport Links
- Walkable Distance to a Wide Range of Shops, Restaurants and Cafes
- 
- 

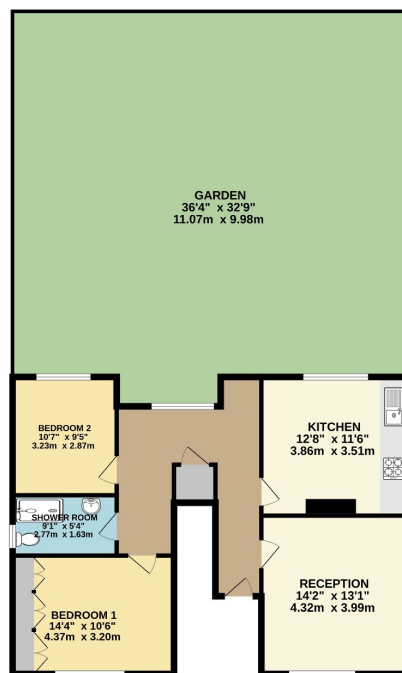

TOTAL FLOOR AREA: 814 sq.ft. (75.6 sq.m) approx.  
Whilst every attempt has been made to ensure the accuracy of the floorplan contained here, measurements of doors, windows, rooms and any other items are approximate and no responsibility is taken for any errors, omissions or mis-statements. This plan is for illustrative purposes only and should be used as such for any prospective purchaser. The services, fixtures and appliances shown here are shown as intended and no guarantee as to their operability or efficiency can be given.  
Made with Mempro 12/24

Welcome to this two-bedroom Georgian conversion flat, ideally situated within walking distance to both Brixton and Loughborough Junction stations. Fiveways Street enjoys a prime location, just moments from Brixton's vibrant high street shops, bars, and restaurants. Plus, it's conveniently close to the green outdoor oasis of Myatts Fields.