



4 Bedrooms



4 Bath/Shower Rooms



2 Reception Rooms



Garage & Parking



Landscaped Gardens



EPC Band B

Council Tax

Band: G £3,610.06
April 24/March 25

Local Authority
Dacorum

Deposit £8,031.00

Holding Deposit £1,338.46



Kingfisher Lodge, Sheethanger Lane, Felden

A newly built family home located in an exclusive private road, presented to a very high standard with living over three floors.

Description

Kingfisher Lodge is a stunning five bedroom detached family home, presented to a very high standard throughout. Situated on a private road, with ample parking and beautiful landscaped gardens.

The property consists of entrance hall, living room, study, downstairs cloakroom, open plan kitchen/dining/living area with bifold doors leading out to the rear garden.

Upstairs you have three double bedrooms all of which have en suites and then on the top floor there is a further two bedrooms, one with its own en suite.

Outside there are stunning newly landscaped gardens, ample parking and a double garage.

Garden maintenance is included in the rental figure.

Location

Sheethanger Lane is an exclusive private road, in the sought-after hamlet of Felden. The hamlet enjoys a delightful semi-rural ambience, surrounded by the rolling greenbelt countryside of the Chiltern Hills, including Sheethanger Common, which is owned by The Box Moor Trust, and provides many delightful woodland walks and lovely views over the surrounding countryside.





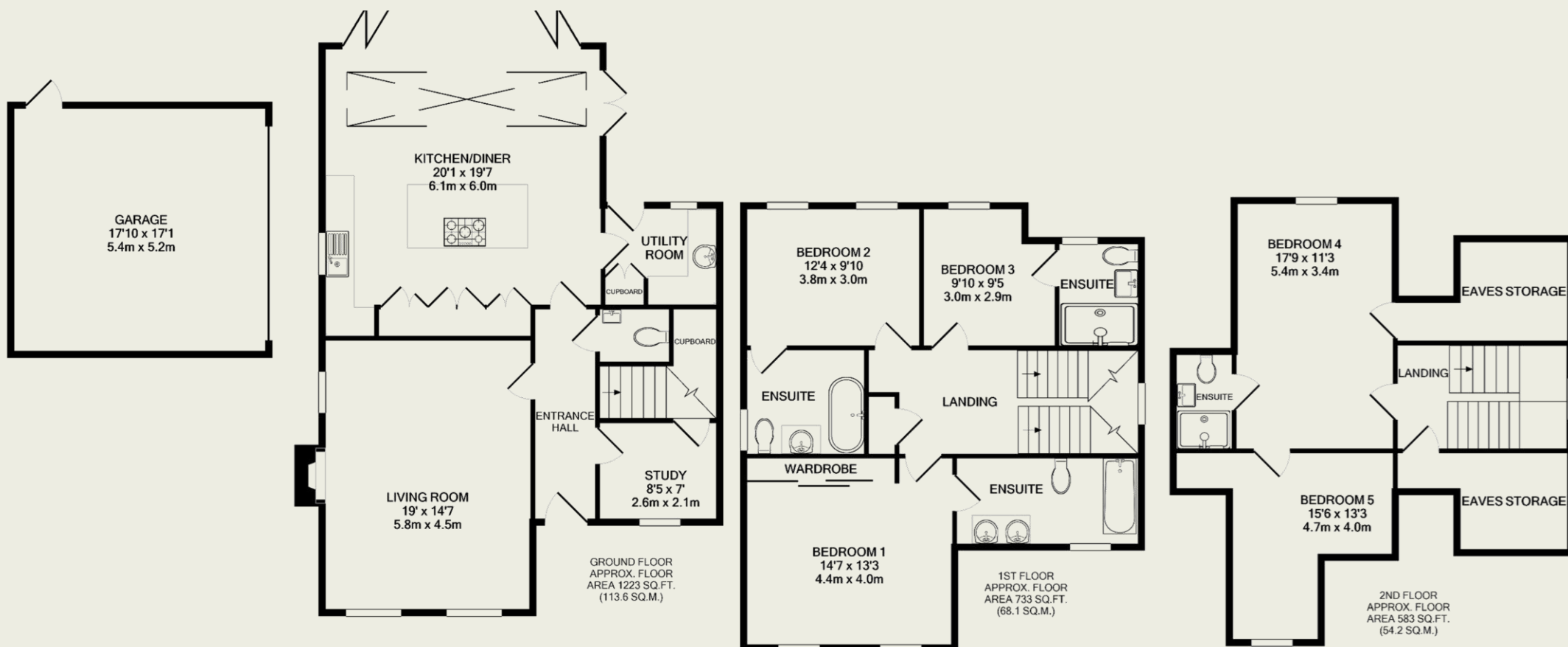

TOTAL APPROX. FLOOR AREA 2539 SQ.FT. (235.8 SQ.M.)

This floorplan is for illustration purposes only. The measurements and position of each element are approximate and must be viewed as such.