

# Buckingham Place

## Brighton

**LEXTONS** / SALES  
LETTINGS  
AUCTIONS  
COMMERCIAL



## About the property

A charming first floor apartment nestled in a prime central location close to many amenities including Brighton mainline station, the popular Seven Dials shopping thoroughfare and the pretty St Ann's Well Gardens.

As you step into this cosy abode, you're greeted by a warm and inviting atmosphere which is beautifully presented throughout. The living room offers a comfortable retreat with space for a dining table and is complete with high ceilings, original cornicing, feature fireplace, exposed brick work wall and large sash windows.

There is a modern fitted kitchen with integrated appliances, fully tiled bathroom and a good size double bedroom with plush carpeting underfoot and generous fitted wardrobes.

The property further benefits from stunning rooftop views towards The Downs and is sold with a long lease.

# Buckingham Place Brighton

£325,000



1

BEDROOM

1

RECEPTION

1

BATHROOM







## First Floor

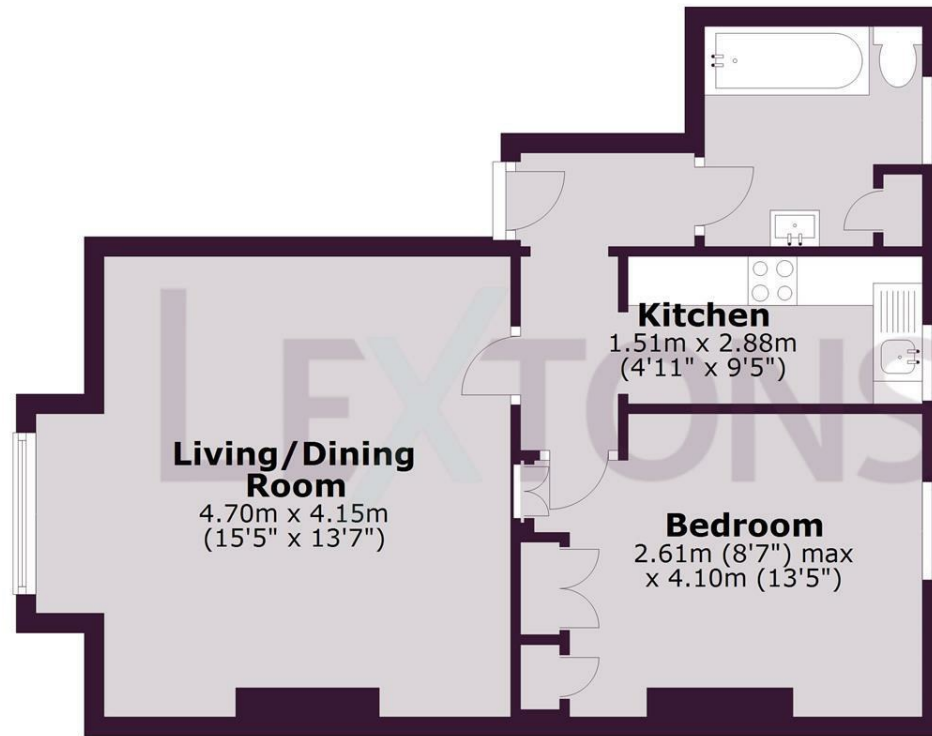

SCAN HERE TO OFFER ON THIS PROPERTY



Total area: approx. 51.3 sq. metres (551.7 sq. feet)

Whilst every care has been taken to ensure accuracy, dimensions are approximate and for illustrative purposes only.

Created for exclusive use for Lextons. All rights reserved.  
Plan produced using PlanUp.

Whilst every care has been taken to ensure accuracy, dimensions are approximate and for illustrative purposes only.

Created by Lextons. All rights reserved.

Energy Efficiency Rating		Current	Potential
Very energy efficient - lower running costs			
(92 plus) <b>A</b>			
(81-91) <b>B</b>			
(69-80) <b>C</b>			
(55-68) <b>D</b>			
(39-54) <b>E</b>			
(21-38) <b>F</b>			
(1-20) <b>G</b>			
Not energy efficient - higher running costs			
<b>England &amp; Wales</b>	EU Directive 2002/91/EC		