

Copse Hill

Brighton

LEXTONS / SALES
LETTINGS
AUCTIONS
COMMERCIAL



About the property

GUIDE PRICE £675,000 to £725,000

A stunning five bedroom semi detached house offering spacious and comfortable living space, arranged over three floors, perfect for family living.

The property boasts a warm and inviting atmosphere complimented by the solid wood flooring on the ground floor. The through living/dining room provides a versatile space for entertaining, together with the tranquil conservatory at the rear. There is also a modern kitchen, boot room and WC on the ground floor.

With its five bedrooms and two modern bathrooms, this house offers plenty of room for everyone. Whether you need a home office, playroom or guest bedroom, there are endless possibilities to suit your needs.

Outside, you are welcomed by a large pond in the front garden, adding a touch of serenity and natural beauty to your surroundings. The large rear garden also provides ample space for outdoor activities.

The property is situated in a sought after residential location, with easy access to local amenities, schools, and transportation options.

Don't miss out on the opportunity to make this wonderful property your new home.

Copse Hill Brighton

£700,000- £750,000
Guide Price



5

BEDROOM

1

RECEPTION

2

BATHROOM









SCAN HERE TO OFFER ON THIS PROPERTY

First Floor

Approx. 46.7 sq. metres (502.9 sq. feet)

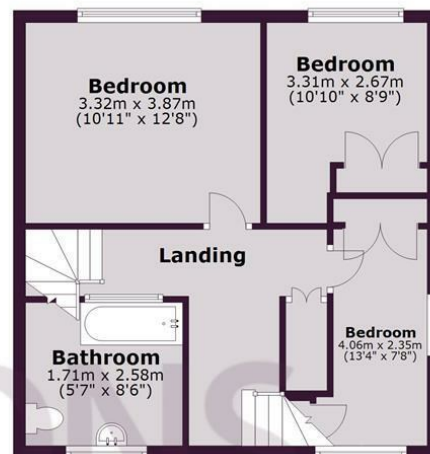

Ground Floor

Approx. 60.3 sq. metres (648.7 sq. feet)

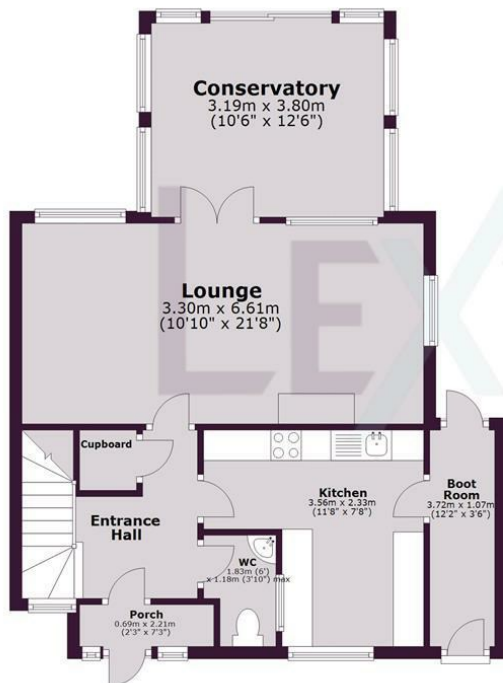

Second Floor

Approx. 24.0 sq. metres (258.0 sq. feet)



Total area: approx. 130.9 sq. metres (1409.5 sq. feet)

Whilst every care has been taken to ensure accuracy, dimensions are approximate and for illustrative purposes only.

Created by Lextons. All rights reserved.